

**GENERAL CONSTRUCTION NOTES:**

1. ALL CONSTRUCTION TO CONFORM TO B.C.A AND AUSTRALIAN STANDARDS AND IN ACCORDANCE WITH RELEVANT SERVICES AND AUTHORITY REGULATIONS
2. ALL DIMENSIONS ARE TO BE CONFIRMED BY BUILDER ON SITE. REFERENCE TO WRITTEN DIMENSIONS TO BE TAKEN IN PREFERENCE TO SCALED.
3. ALL SEWER AND STORMWATER DRAINAGE IS TO BE IN STRICT ACCORDANCE WITH THE REQUIREMENTS OF THE LOCAL COUNCIL.
4. SUITABLE SITE AREA DRAINAGE IS TO BE CARRIED OUT BY THE BUILDER TO ENSURE THAT STORMWATER DOES NOT POND AGAINST ANY WALLS OF THE DWELLING.
5. CONTRACTOR SHALL PROVIDE ALL NECESSARY FLASHINGS, CAPPINGS AND OTHER ITEMS REQUIRED TO MAKE THE ROOF WATERTIGHT AND COMPLETE.
6. REFER TO ENGINEERS DESIGN, DOCUMENTATION AND CALCULATIONS FOR DETAILS ON ALL STRUCTURAL COMPONENTS.
7. ALL TIMBER FRAMING SHALL BE IN ACCORDANCE WITH AS 1684.2010 (RESIDENTIAL TIMBER FRAMED CONSTRUCTION)
8. ALL ELECTRICAL WORK (INC. WIRINGS & INSTALLATIONS) CARRIED OUT, TO BE IN ACCORDANCE WITH AS 3000.

**SITE NOTES**

9. BUILDER TO VERIFY THE LOCATION OF ALL SERVICES PRIOR TO CONSTRUCTION
10. DO NOT SCALE DIMENSIONS OFF PLAN. FIGURED DIMENSIONS TO BE USED AT ALL TIMES.

**PLUMBING NOTES**

11. DISCHARGE ROOF WATER DRAINAGE TO STORMWATER CONNECTION POINT AS PER COUNCIL'S REQUIREMENT.
12. ROOFING CONTRACTOR AND PLUMBER TO ENSURE THAT THE NUMBER OF DOWNPIPES SHOWN ON PLAN IS ADEQUATE AND LOCATED IN THE OPTIMUM POSITIONS.

GROUND LEVELS SHOWN ARE APPROXIMATE, BUILDER IS TO CHECK ALL LEVELS AND POSITION ONSITE WITH OWNER BEFORE COMMENCING WORK.

01 SITE PLAN  
- 1:200

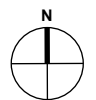

ISSUED FOR COUNCIL APPROVAL



WANNEROOPATIOS.COM.AU  
TEL.: 08 9302 1965

ADDRESS  
LOT 305 - 35 BONANNELLA ENTRANCE SINAGRA  
CITY OF JOONDALUP

PROPOSAL  
PROPOSED PATIO  
SITE PLAN

DRAWN JG	DATE MAY 2023	SCALE AS NOTED @ A3
CHECKED -	DATE -	ISSUE -
JOB NO. 42893	DRAWING NO. A01	REV. V1

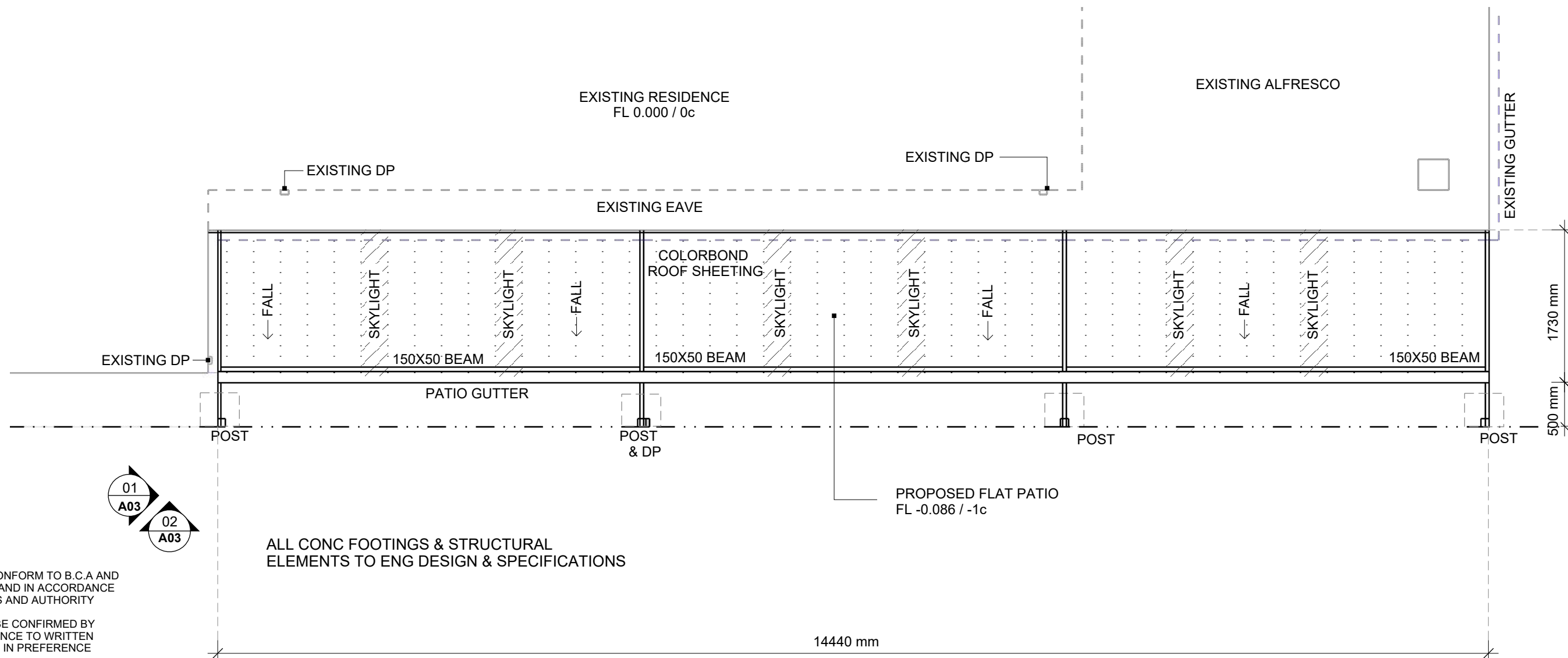

ALL CONC FOOTINGS & STRUCTURAL ELEMENTS TO ENG DESIGN & SPECIFICATIONS

**GENERAL CONSTRUCTION NOTES:**

1. ALL CONSTRUCTION TO CONFORM TO B.C.A AND AUSTRALIAN STANDARDS AND IN ACCORDANCE WITH RELEVANT SERVICES AND AUTHORITY REGULATIONS
2. ALL DIMENSIONS ARE TO BE CONFIRMED BY BUILDER ON SITE. REFERENCE TO WRITTEN DIMENSIONS TO BE TAKEN IN PREFERENCE TO SCALED.
3. ALL SEWER AND STORMWATER DRAINAGE IS TO BE IN STRICT ACCORDANCE WITH THE REQUIREMENTS OF THE LOCAL COUNCIL.
4. SUITABLE SITE AREA DRAINAGE IS TO BE CARRIED OUT BY THE BUILDER TO ENSURE THAT STORMWATER DOES NOT POND AGAINST ANY WALLS OF THE DWELLING.
5. CONTRACTOR SHALL PROVIDE ALL NECESSARY FLASHINGS, CAPPINGS AND OTHER ITEMS REQUIRED TO MAKE THE ROOF WATERTIGHT AND COMPLETE.
6. REFER TO ENGINEERS DESIGN, DOCUMENTATION AND CALCULATIONS FOR DETAILS ON ALL STRUCTURAL COMPONENTS.
7. ALL TIMBER FRAMING SHALL BE IN ACCORDANCE WITH AS 1684.2010 (RESIDENTIAL TIMBER FRAMED CONSTRUCTION)
8. ALL ELECTRICAL WORK (INC. WIRINGS & INSTALLATIONS) CARRIED OUT, TO BE IN ACCORDANCE WITH AS 3000.

**SITE NOTES**

9. BUILDER TO VERIFY THE LOCATION OF ALL SERVICES PRIOR TO CONSTRUCTION
10. DO NOT SCALE DIMENSIONS OFF PLAN. FIGURED DIMENSIONS TO BE USED AT ALL TIMES.

**PLUMBING NOTES**

11. DISCHARGE ROOF WATER DRAINAGE TO STORMWATER CONNECTION POINT AS PER COUNCIL'S REQUIREMENT.
12. ROOFING CONTRACTOR AND PLUMBER TO ENSURE THAT THE NUMBER OF DOWNPIPES SHOWN ON PLAN IS ADEQUATE AND LOCATED IN THE OPTIMUM POSITIONS.

GROUND LEVELS SHOWN ARE APPROXIMATE, BUILDER IS TO CHECK ALL LEVELS AND POSITION ONSITE WITH OWNER BEFORE COMMENCING WORK.

02 PLAN  
- 1:50

ISSUED FOR COUNCIL APPROVAL



WANNEROOPATIOS.COM.AU  
TEL.: 08 9302 1965

ADDRESS LOT 305 - 35 BONANNELLA ENTRANCE SINAGRA CITY OF JOONDALUP		DRAWN JG	DATE MAY 2023	SCALE AS NOTED @ A3
PROPOSAL PROPOSED PATIO PLAN VIEW		CHECKED -	DATE -	ISSUE -
JOB NO. 42893	DRAWING NO. A02	REV. V1		

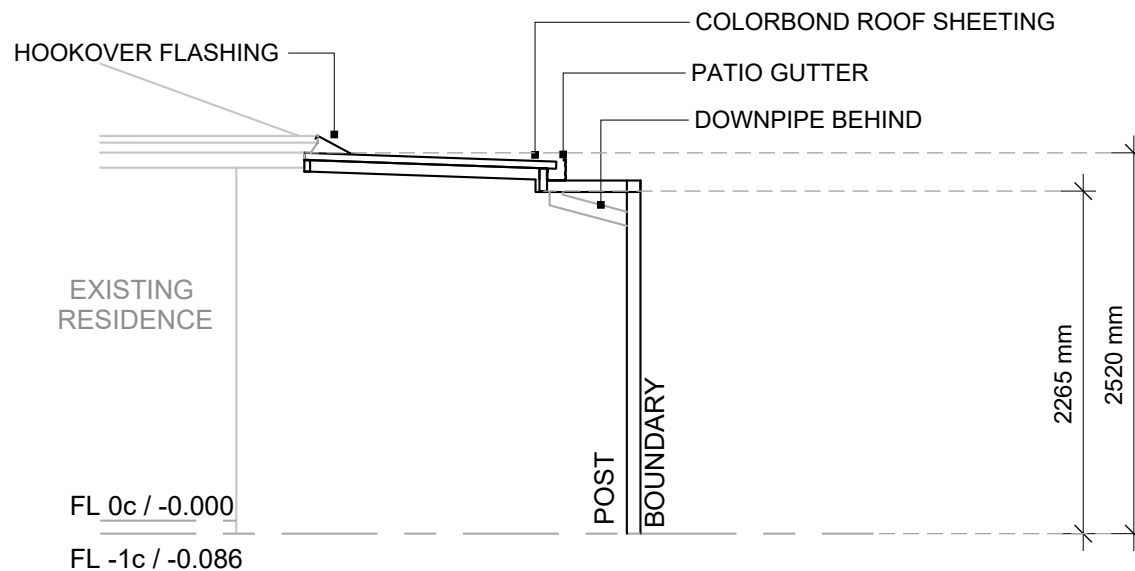

01 PATIO  
- ELEVATIONS 1:50

**GENERAL CONSTRUCTION NOTES:**

1. ALL CONSTRUCTION TO CONFORM TO B.C.A AND AUSTRALIAN STANDARDS AND IN ACCORDANCE WITH RELEVANT SERVICES AND AUTHORITY REGULATIONS
2. ALL DIMENSIONS ARE TO BE CONFIRMED BY BUILDER ON SITE. REFERENCE TO WRITTEN DIMENSIONS TO BE TAKEN IN PREFERENCE TO SCALED.
3. ALL SEWER AND STORMWATER DRAINAGE IS TO BE IN STRICT ACCORDANCE WITH THE REQUIREMENTS OF THE LOCAL COUNCIL.
4. SUITABLE SITE AREA DRAINAGE IS TO BE CARRIED OUT BY THE BUILDER TO ENSURE THAT STORMWATER DOES NOT POND AGAINST ANY WALLS OF THE DWELLING.
5. CONTRACTOR SHALL PROVIDE ALL NECESSARY FLASHINGS, CAPPINGS AND OTHER ITEMS REQUIRED TO MAKE THE ROOF WATERTIGHT AND COMPLETE.
6. REFER TO ENGINEERS DESIGN, DOCUMENTATION AND CALCULATIONS FOR DETAILS ON ALL STRUCTURAL COMPONENTS.
7. ALL TIMBER FRAMING SHALL BE IN ACCORDANCE WITH AS 1684.2010 (RESIDENTIAL TIMBER FRAMED CONSTRUCTION)
8. ALL ELECTRICAL WORK (INC. WIRINGS & INSTALLATIONS) CARRIED OUT, TO BE IN ACCORDANCE WITH AS 3000.

**SITE NOTES**

9. BUILDER TO VERIFY THE LOCATION OF ALL SERVICES PRIOR TO CONSTRUCTION
10. DO NOT SCALE DIMENSIONS OFF PLAN. FIGURED DIMENSIONS TO BE USED AT ALL TIMES.

**PLUMBING NOTES**

11. DISCHARGE ROOF WATER DRAINAGE TO STORMWATER CONNECTION POINT AS PER COUNCIL'S REQUIREMENT.
12. ROOFING CONTRACTOR AND PLUMBER TO ENSURE THAT THE NUMBER OF DOWNPIPES SHOWN ON PLAN IS ADEQUATE AND LOCATED IN THE OPTIMUM POSITIONS.

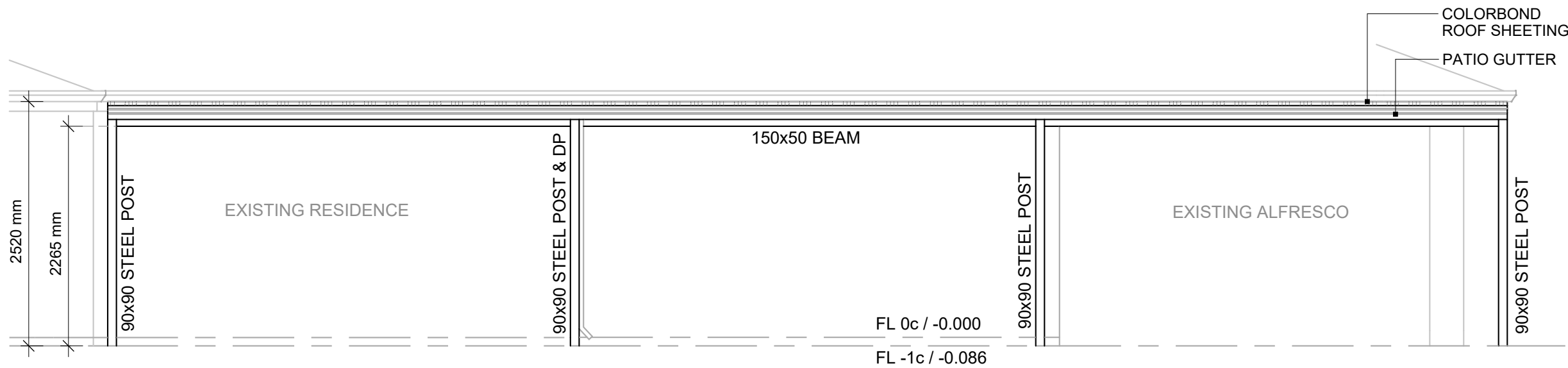

02 PATIO  
- ELEVATIONS 1:50

GROUND LEVELS SHOWN ARE APPROXIMATE, BUILDER IS TO CHECK ALL LEVELS AND POSITION ONSITE WITH OWNER BEFORE COMMENCING WORK.

ISSUED FOR COUNCIL APPROVAL



WANNEROOPATIOS.COM.AU  
TEL.: 08 9302 1965

ADDRESS LOT 305 - 35 BONANNELLA ENTRANCE SINAGRA CITY OF JOONDALUP	DRAWN JG	DATE MAY 2023	SCALE AS NOTED @ A3
PROPOSAL PROPOSED PATIO ELEVATIONS	CHECKED -	DATE -	ISSUE -
	JOB NO. 42893	DRAWING NO. A03	REV. V1