

ROAD CARRIAGEWAY DETAIL :
 All carriageway detail depicted on this Plan including pavements, medians and embayments are for illustrative purposes only and subject to final engineering designs and relevant Council approvals. The depictions reflect the intent of the road network standards to be developed.

Land to be set aside as a separate lot pending acquisition for District Open Space

Potential signalled intersection in the long term based on future traffic volumes and freeway connection. Final intersection design and control subject to the agreement of Main Roads WA and the City of Wanneroo.

Potential priority intersection in the interim subject to the agreement of the City of Wanneroo and Main Roads WA.

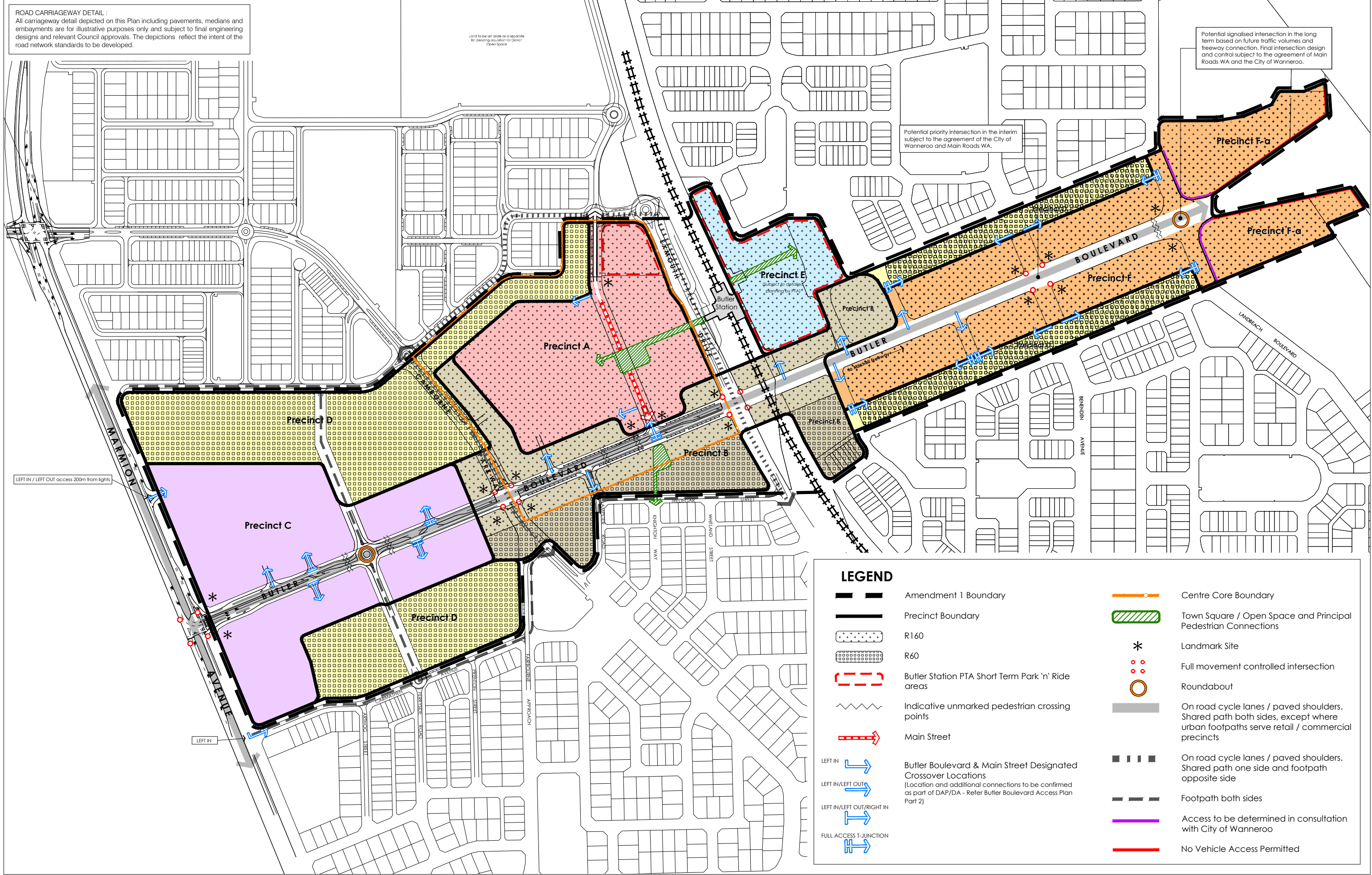

LEFT IN / LEFT OUT access 200m from lights

LEFT IN

LEGEND

	Amendment 1 Boundary		Centre Core Boundary
	Precinct Boundary		Town Square / Open Space and Principal Pedestrian Connections
	R160		Landmark Site
	R60		Full movement controlled intersection
	Butler Station PTA Short Term Park 'n' Ride areas		Roundabout
	Indicative unmarked pedestrian crossing points		On road cycle lanes / paved shoulders. Shared path both sides, except where urban footpaths serve retail / commercial precincts
	Main Street		On road cycle lanes / paved shoulders. Shared path one side and footpath opposite side
	Butler Boulevard & Main Street Designated Crossover Locations (Location and additional connections to be confirmed as part of DAP/DA - Refer Butler Boulevard Access Plan Part 2)		Footpath both sides
	LEFT IN / LEFT OUT		Access to be determined in consultation with City of Wanneroo
	LEFT IN / LEFT OUT / RIGHT IN		No Vehicle Access Permitted
	FULL ACCESS T-JUNCTION		

