

YELLAGONA NATIONAL PARK

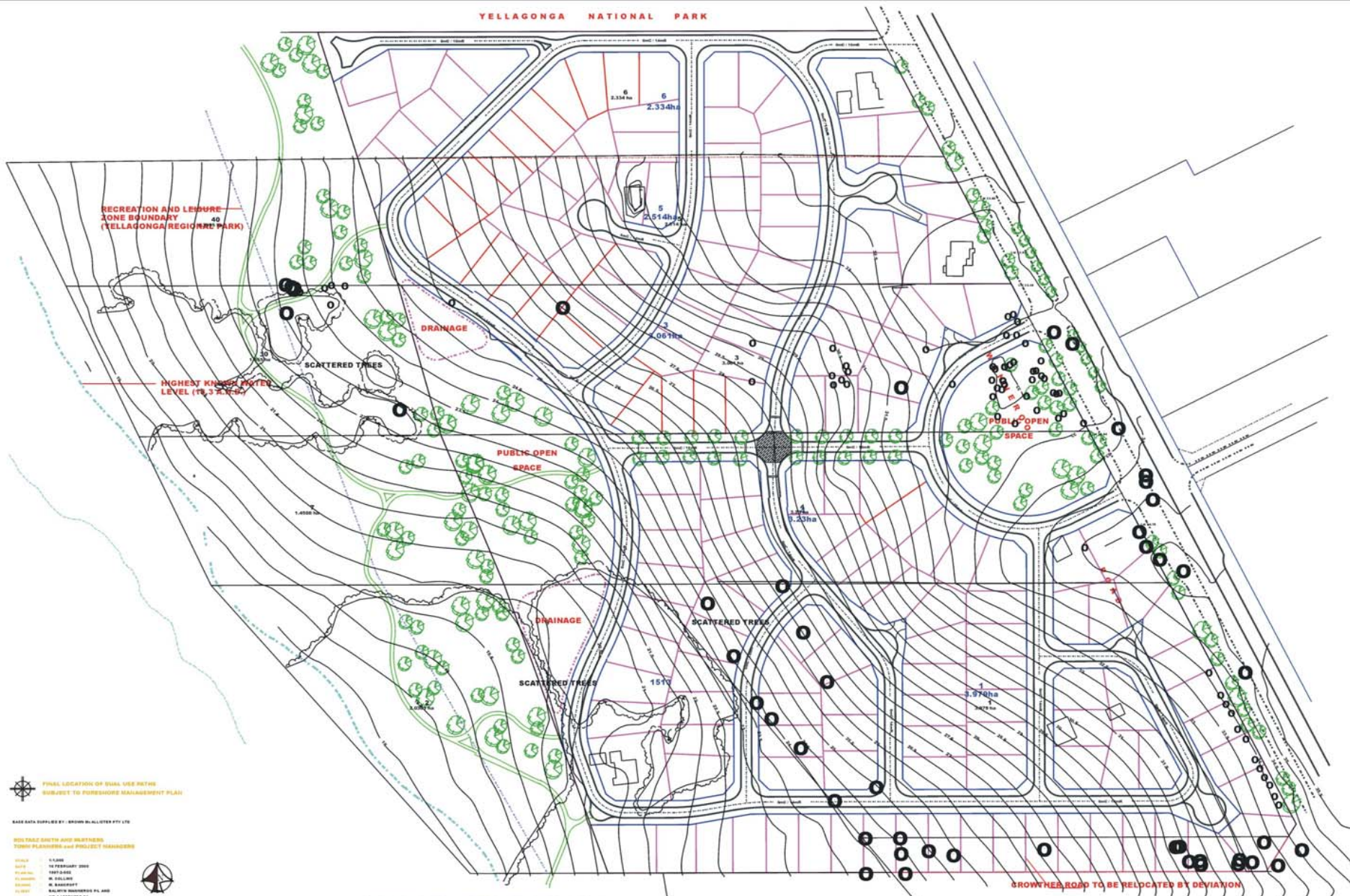

RECREATION AND LEISURE ZONE BOUNDARY (YELLAGONA REGIONAL PARK)

HIGHEST KNOWN WATER LEVEL (TS 3.2.19.50)

DRAINAGE

PUBLIC OPEN SPACE

DRAINAGE

SCATTERED TREES

SCATTERED TREES

GROWTH ROAD TO BE RELOCATED BY DEVIATION



FINAL LOCATION OF DUAL USE PATHS SUBJECT TO FORESHORE MANAGEMENT PLAN

BASE DATA SUPPLIED BY: BROWN HULLISTER PTY LTD

HOLTZLEIGH SOUTH AND WANNEROO TOWN PLANNING AND PROSPECT MANAGEMENT

- SCALE 1:1,000
- DATE 18 FEBRUARY 2008
- PROJECT NO. 1007-0-002
- CLIENT M. HILLING
- DESIGNER M. BARRISSETT
- APPROVED BY M. BARRISSETT
- DATE 18 FEBRUARY 2008



- UNLAWFUL
- APPROVED
- PROPOSED

- 1. THIS PLAN IS PREPARED BY AN AUTHORIZED PERSON
- 2. THE PLAN IS PREPARED IN ACCORDANCE WITH THE REQUIREMENTS OF THE SUBDIVISION ACT 1988
- 3. THE PLAN IS PREPARED IN ACCORDANCE WITH THE REQUIREMENTS OF THE SUBDIVISION ACT 1988
- 4. THE PLAN IS PREPARED IN ACCORDANCE WITH THE REQUIREMENTS OF THE SUBDIVISION ACT 1988



**PROPOSED STRUCTURE PLAN**  
**LOTS 1, 3, 4, 5, 6 AND LOCATION 1513 WANNEROO ROAD, WANNEROO**

