

LEGEND

LAND WITHIN PART 1 STRUCTURE PLAN BOUNDARIES

PRECINCTS

- ACTIVITY CENTRES (Commercial, Retail, Mixed Use & Higher Density Residential)
- RESIDENTIAL (Low to Medium Density)
- ENVIRONMENT RESPONSE HOUSING
- EDUCATIONAL AND DISTRICT OPEN SPACE

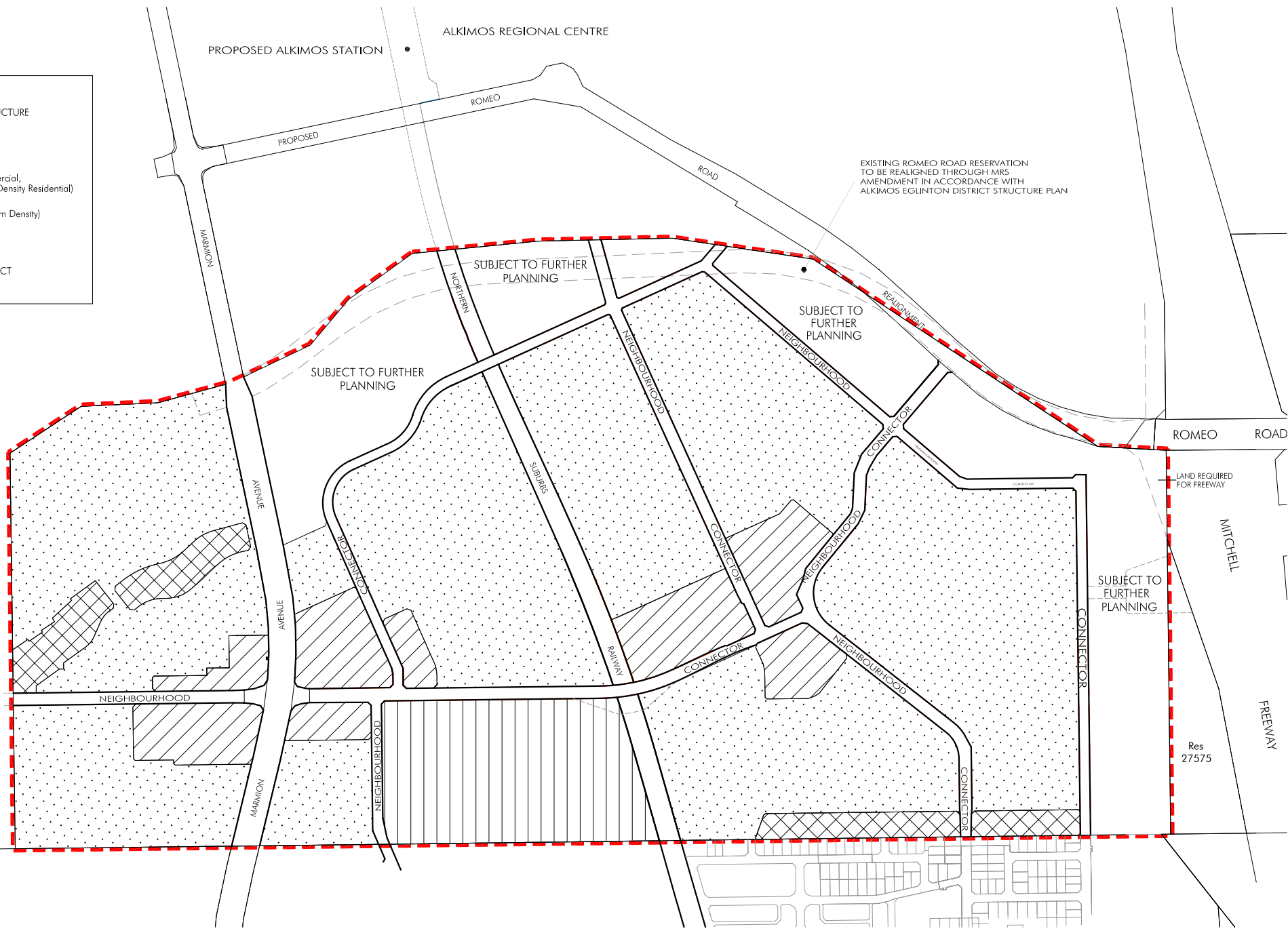

AGREED LOCAL STRUCTURE PLAN
LOTS 1001 & 1002 MARMION AVENUE, ALKIMOS
AGREED LOCAL STRUCTURE PLAN
PLAN 2

28 OCTOBER 2009

THE DOCUMENT MAY ONLY BE USED FOR THE PURPOSE FOR WHICH IT WAS COMMISSIONED AND IN ACCORDANCE WITH THE TERMS OF ENGAGEMENT FOR THE COMMISSION. UNAUTHORISED USE OF THIS DOCUMENT IN ANY FORM WHATSOEVER IS PROHIBITED.

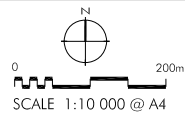

Suite 5, 2 Hardy Street
 South Perth, WA 6151
 T (08) 9474 1722
 F (08) 9474 1172
 perth@graylewis.com.au