

LEGEND		SEC Dome
	Power Pole	
	Phone Pits	
	Water Conn.	
	Top Pillar/Post	
	Top Wall	
	Top Retaining	
	Top Fence	

DISCLAIMER:
 Let boundaries drawn on survey are based on landscape plan only. Survey does not include title search and as such may not show easements or other interests not shown on plan. Title should be checked to verify all lot details and for any easements or other interests which may affect building on the property.

DISCLAIMER:
 Survey does not include verification of cadastral boundaries. All features and levels shown are based on orientation to existing pegs and fences only which may not be on correct cadastral alignment. Any designs based or dependent on the location of existing features should have those features' location verified in relation to the true boundary.

DISCLAIMER:
 Survey shows visible features only and will not show locations of underground pipes or conduits for internal or mains services. Verification of the location of all internal and mains services should be confirmed prior to finalisation of any design work.

DISCLAIMER:
 Cottage & Engineering surveys accept no responsibility for any physical on site changes to the parcel or portion of the parcel of land shown on this survey including any adjoining neighbours levels and features that have occurred after the date on this survey. All Sewer details plotted from information supplied by Water Corporation.

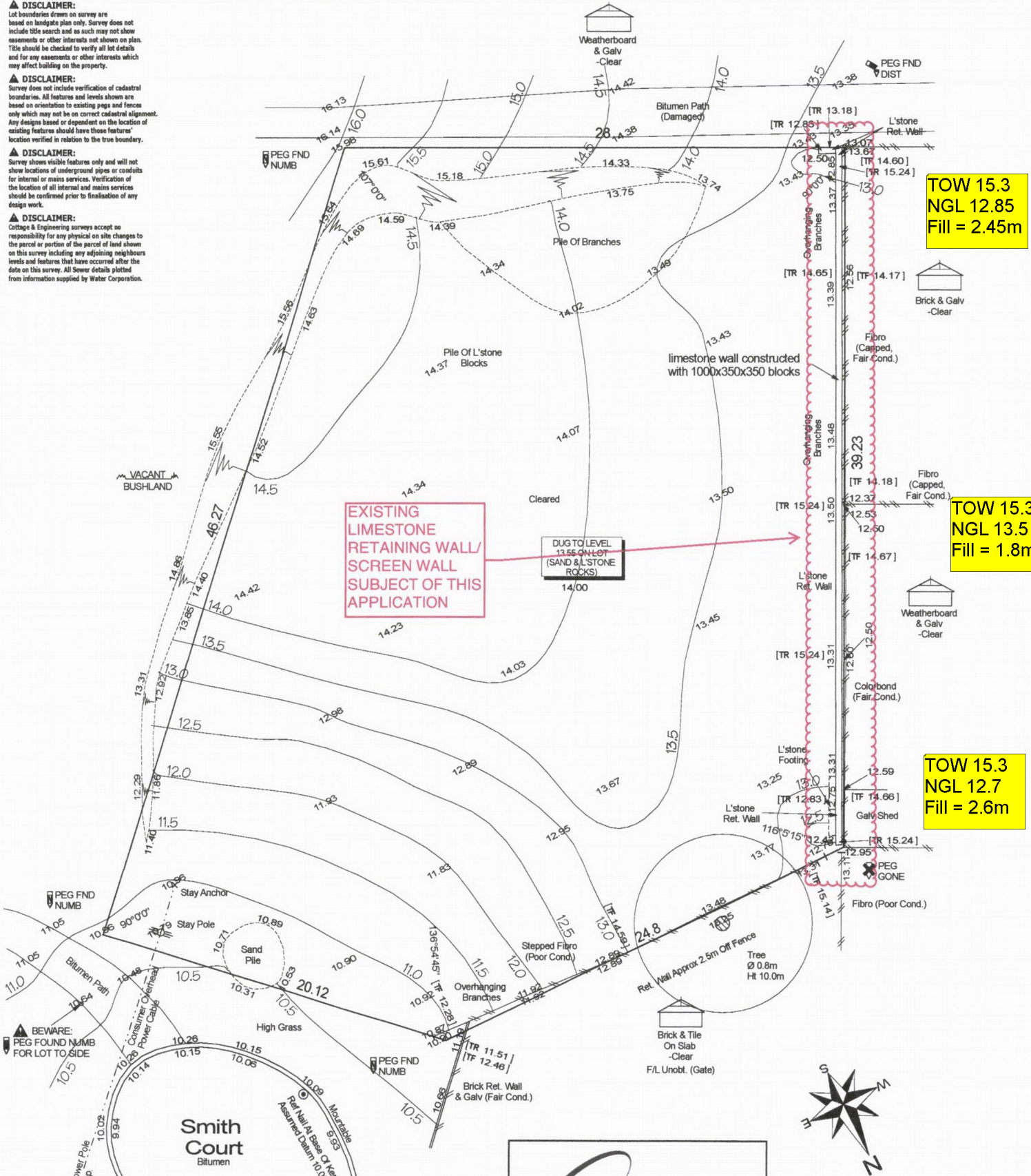

**TOW 15.3
 NGL 12.85
 Fill = 2.45m**

**TOW 15.3
 NGL 13.5
 Fill = 1.8m**

**TOW 15.3
 NGL 12.7
 Fill = 2.6m**

**EXISTING LIMESTONE
 RETAINING WALL/
 SCREEN WALL
 SUBJECT OF THIS
 APPLICATION**

**DUG TO LEVEL
 13.65 DAN LOT
 (SAND & L'STONE
 ROCKS)
 14.00**

LOT MISCLOSE
 0.015 m

SOIL DESCRIPTION
 Sand / L'Stone(Poss)
 Cleared Lot

Scale 1:200

AXIS Building Approvals

This application has been assessed and approved in accordance with the Building Act 2011 and Building Regulations 2012

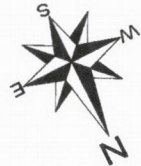

11 - 12 - 17

NOTE:
 TELSTRACOMMS. PIT NOT LOCATED
 ADJACENT TO LOT AT TIME OF SURVEY.
 VERIFY AVAILABILITY WITH TELSTRACOMMS.