

SITE PLAN - EXISTING

SCALE 1:500

Area highlighted in RED subject to Change of Use application

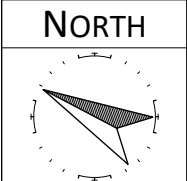

Canford
Hospitality Consultants Pty Ltd

p: (08) 6278 2788 e: admin@canford.com.au
f: (08) 6278 2988 postal: PO Box 389, Guildford, WA 6935
m: 0417 976 009 office: Suite 17, 151 James Street, Guildford

DOCUMENTED BY

Suite 2, 4 Sarich Way,
Bentley WA 6102
Ph: +61 8 9470 7700
Fax: +61 8 9470 7750
E-mail: info@perthcad.com.au



CLIENT

FOO HUA CHINESE RESTAURANT

PROJECT

2/9 CONLAN AVENUE, WANNEROO WA 6065
AS CONSTRUCTED

DRAWING TITLE

EXISTING SITE PLAN

DRAWN

GR

DATE CREATED

07.06.2018

DATE

11.06.2018

JOB No.

18116

CHECKED

GR

SCALE

1:500

REV No.

A1

REF.

DRAWING No

001

A3 SHEET

DO NOT SCALE

REV.	DATE	DESCRIPTION	INT.
A1	11.06.2018	ISSUED FOR APPROVAL	GR

AREA LEGEND - EXISTING

DINING AREA:	89.61m ²
KITCHEN, SERVICE, LOBBY & STORE:	85.36m ²
AMENITIES:	18.75m ²
G.L.A.	193.72m ²
OVERALL BUILDING AREA	227.09m ²
O/A LICENSED AREA (inc. internal & external walls):	227.09m ²

- B BENCH
- DW DISH WASHER
- FW FLOOR WASTE
- S SINK / TROUGH
- GR GRIDDLE
- F FRIDGE
- SH SHELVING
- HB HAND BASIN
- HD HAND DRYER
- WC WATER CLOSET
- UR URINAL
- POS POINT OF SALE (TILL)

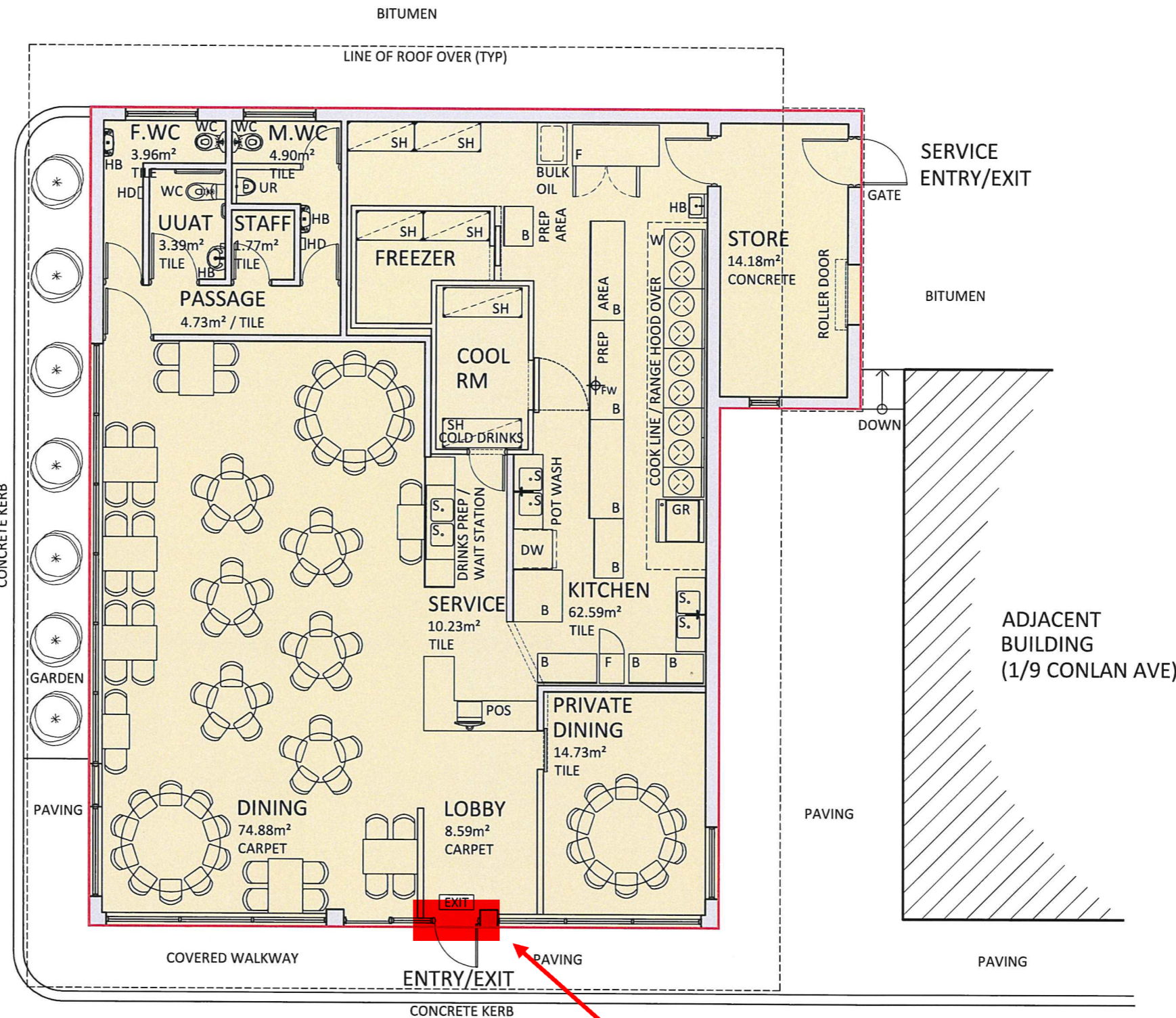

FLOOR PLAN - EXISTING
SCALE 1:100

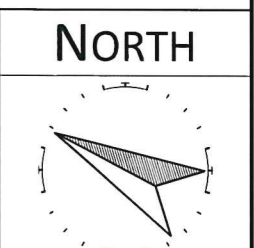

Sign on site location - to be displayed on door/window

Canford
Hospitality Consultants Pty Ltd

p: (08) 6278 2788 e: admin@canford.com.au
f: (08) 6278 2988 postal: PO Box 389, Guildford, WA 6935
m: 0417 976 009 office: Suite 17, 151 James Street, Guildford

A3 SHEET	DO NOT SCALE			
	REV.	DATE	DESCRIPTION	INT.
	A2	18.06.2018	ISSUED FOR APPROVAL	GR
	A1	11.06.2018	ISSUED FOR APPROVAL	GR

DOCUMENTED BY

Suite 2, 4 Sarich Way,
Bentley WA 6102
Ph: +61 8 9470 7700
Fax: +61 8 9470 7750
E-mail: info@perthcad.com.au

PERTH CADCENTRE

CLIENT	FOO HUA CHINESE RESTAURANT
PROJECT	2/9 CONLAN AVENUE, WANNEROO WA 6065 AS CONSTRUCTED
DRAWING TITLE	EXISTING FLOOR PLAN / PROPOSED LICENSED AREA

DRAWN	GR	CHECKED	GR	DRAWING No
DATE CREATED	07.06.2018	SCALE	1:100	101
DATE	18.06.2018	REV No.	A2	
JOB No.	18116	REF.		