

- NOTES:**
- CADASTRAL INFORMATION APPROXIMATE ONLY.
 - SERVICE LOCATIONS DIAGRAMMATIC ONLY. CONTACT SERVICE AUTHORITIES FOR EXACT IN GROUND LOCATIONS.
 - KERBING TO BE CONSTRUCTED IN ACCORDANCE WITH CITY OF WANNEROO DRG. No TS 05-1 AND TS 05-3.
 - ALL DISTURBANCES TO EXISTING VERGE RETICULATION AND TURFING TO BE REINSTATED.
 - BRICK PAVING TO BE AS NOTED.
 - FOR COST ESTIMATE REFER TO HPE 18/472182.

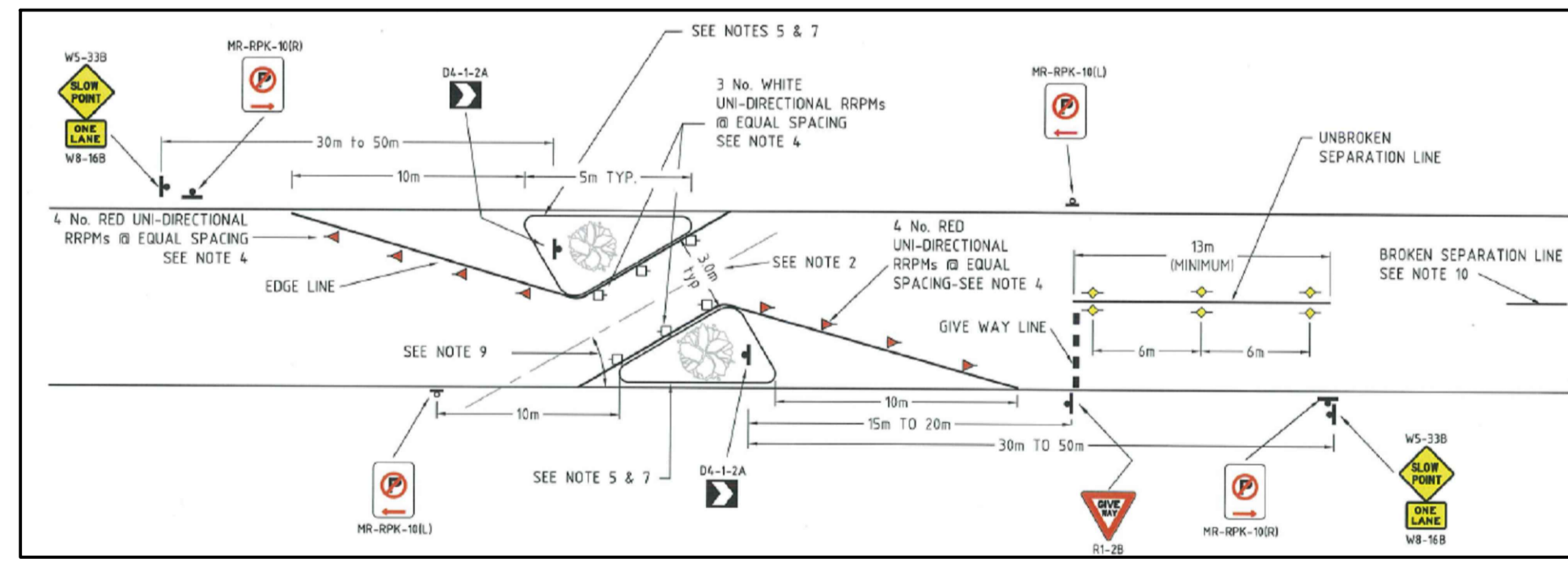

DETAIL 1

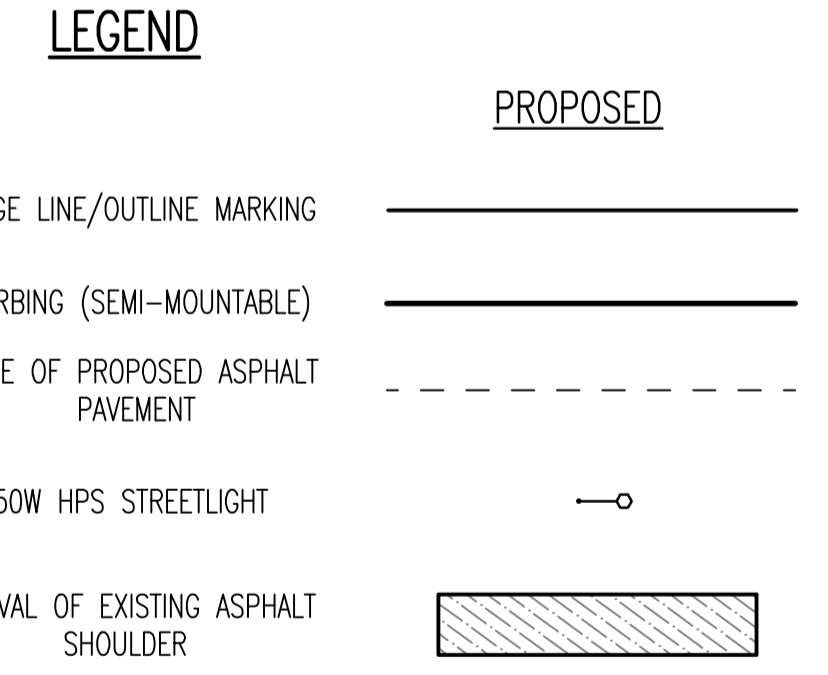

LOCALITY

NOT FOR CONSTRUCTION

* INDICATES ACCEPTANCE IN ED RMS NOTES / WORKFLOW

No.	REVISION	BY	DATE	AUTH	No.	REVISION	BY	DATE	AUTH	SCALE: 1:1000	SURVEYED: NEARMAP SURVEYOR	DRAWN: K. RICHTER CIVIL DESIGNER	AUTHORISED: J. DUFF OPERATIONS WANNER ASSET OPERATIONS & SERVICES	FINANCE CODE: PR-0000	PMO No.: 0000	DRAWING No.: 3595-1-0	SHEET: 1 OF 2	REVISION	ORIGINAL DRG. SIZE: A1
A	DRAFT COPY		/2018								8/2018		6/11/2018						
O	ISSUED FOR CONSULTATION		/2018										13/11/2018	18/471910	1917				

CITY OF WANNEROO ASSETS

WANNEROO ROAD
SERVICE ROAD FROM FLYNN DRIVE TO HALL ROAD
TRAFFIC TREATMENT
NEERABUP

CONCEPT PLAN
SHEET 1 OF 2

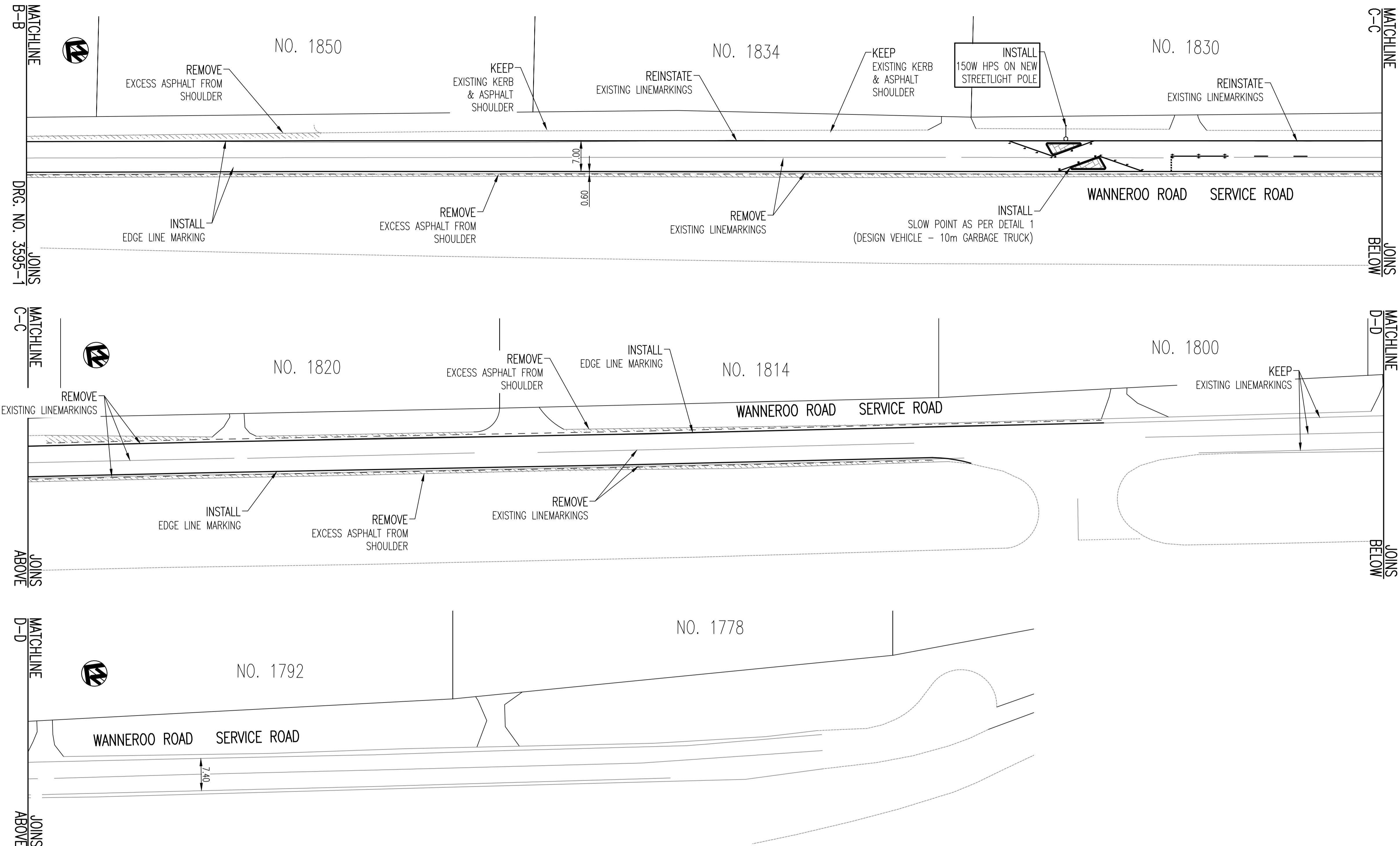

- NOTES:**
- CADASTRAL INFORMATION APPROXIMATE ONLY.
 - SERVICE LOCATIONS DIAGRAMMATIC ONLY. CONTACT SERVICE AUTHORITIES FOR EXACT IN GROUND LOCATIONS.
 - KERBING TO BE CONSTRUCTED IN ACCORDANCE WITH CITY OF WANNEROO DRG. No TS 05-1 AND TS 05-3.
 - ALL DISTURBANCES TO EXISTING VERGE RETICULATION AND TURFING TO BE REINSTATED.
 - BRICK PAVING TO BE AS NOTED.
 - FOR COST ESTIMATE REFER TO HPE 18/472182.

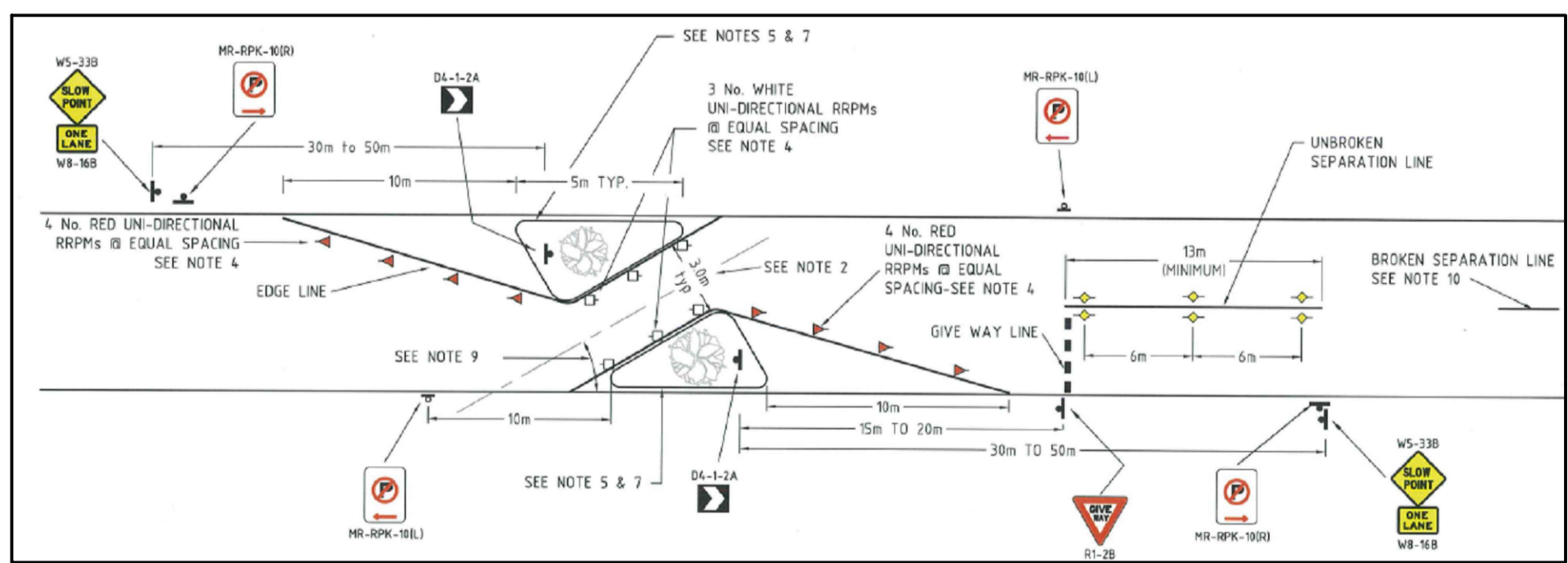
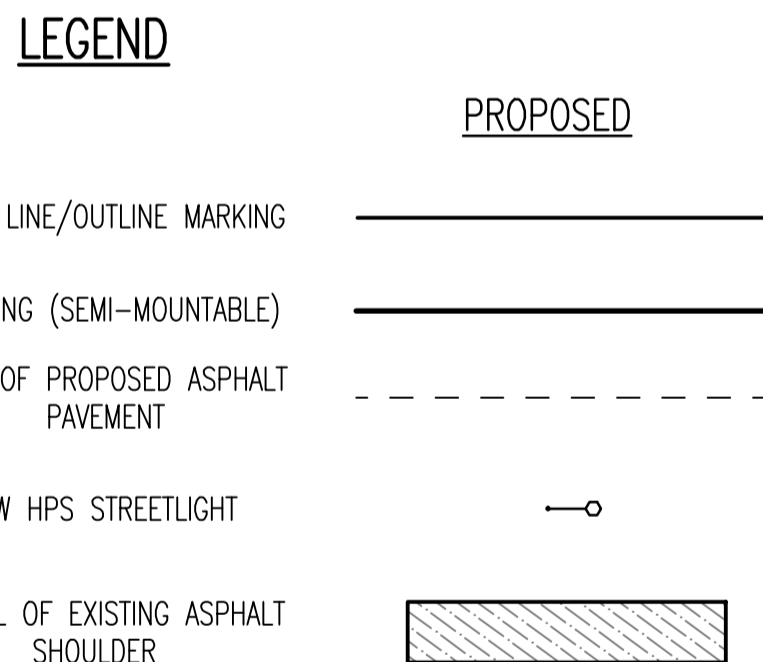

DETAIL 1

NOT FOR CONSTRUCTION

* INDICATES ACCEPTANCE IN ED RMS NOTES / WORKFLOW

CITY OF WANNEROO ASSETS

WANNEROO ROAD
SERVICE ROAD FROM FLYNN DRIVE TO HALL ROAD
TRAFFIC TREATMENT
NEERABUP

CONCEPT PLAN
SHEET 2 OF 2

No.	REVISION	BY	DATE	AUTH	No.	REVISION	BY	DATE	AUTH	SCALE: 1:1000	SURVEYED: NEARMAP SURVEYOR	DRAWN: K. RICHTER CIVIL DESIGNER	AUTHORISED: J. DUFF OPERATIONS WANNER ASSET OPERATIONS & SERVICES	FINANCE CODE: PR-0000	PWD No.: 0000
A	DRAFT COPY		/2018							LOCAL	8/2018	11/2018	6/11/2018		
O	ISSUED FOR CONSULTATION		/2018							PCC94	11/2018	* R. JACKSON COORDINATOR TRANSPORT AND TRAFFIC	* H. SINGH DIRECTOR ASSETS	18/471910	1917