

NOTE: All Sewer details plotted from information supplied by Water Corporation.

NOTE: \*NO ACCESS\*  
NOTE RESTRICTIVE COVENANT.  
REFER TO SEC 129BA T.L.A.  
SEE DOCUMENT.  
RE: RESTRICTION OF ACCESS

NOTE: BEWARE: ADVISE TRADES  
OF Head power lines

NOTE: COTTAGE & ENGINEERING SURVEYS ACCEPT NO RESPONSIBILITY FOR ANY PHYSICAL ON SITE CHANGES TO THE PARCEL OR PORTION OF THE PARCEL OF LAND SHOWN ON THIS SURVEY INCLUDING ANY ADJOINING NEIGHBOURS LEVELS AND FEATURES THAT HAVE OCCURRED AFTER THE DATE ON THIS SURVEY.

Additional info  
Re: DA 2020/1715

62 DEC 2020  
CITY OF WANNEROO

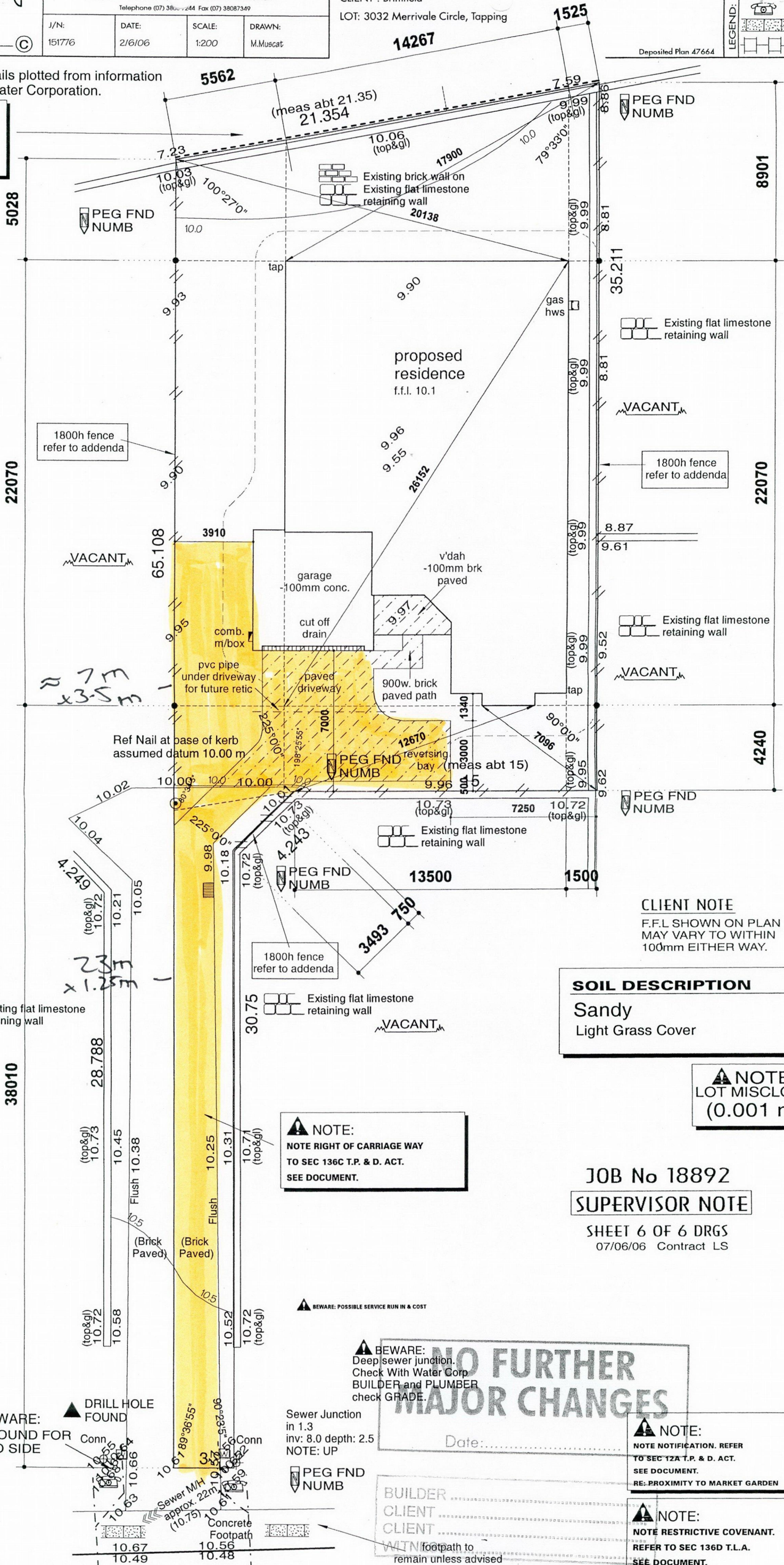

CLIENT NOTE  
F.F.L SHOWN ON PLAN  
MAY VARY TO WITHIN  
100mm EITHER WAY.

SOIL DESCRIPTION  
Sandy  
Light Grass Cover

NOTE:  
LOT MISCLOSE  
(0.001 m)

NOTE:  
NOTE RIGHT OF CARRIAGE WAY  
TO SEC 136C T.P. & D. ACT.  
SEE DOCUMENT.

JOB No 18892  
SUPERVISOR NOTE

SHEET 6 OF 6 DRGS  
07/06/06 Contract LS

BEWARE: Deep sewer junction.  
Check With Water Corp  
BUILDER and PLUMBER  
check GRADE.

NO FURTHER  
MAJOR CHANGES

NOTE:  
NOTE NOTIFICATION. REFER  
TO SEC 12A T.P. & D. ACT.  
SEE DOCUMENT.  
RE: PROXIMITY TO MARKET GARDEN

NOTE:  
NOTE RESTRICTIVE COVENANT.  
REFER TO SEC 136D T.L.A.  
SEE DOCUMENT.

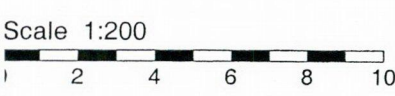
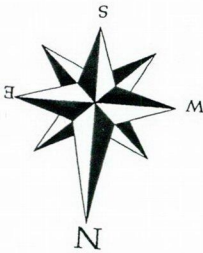

Merrivale Circle

# Proposed Home Business Area

28c Ceilings Thru'out  
Unless Otherwise Noted

WL col = 150 x 50 x 3.0 RHS  
Refer Engineers

15590 OVERALL

14030

1560



22070 OVERALL  
13320

5990  
2160  
600

22070 OVERALL  
21470

### Areas

HOUSE	- 249.51m <sup>2</sup>
GARAGE	- 33.89m <sup>2</sup>
VERANDAH	- 6.70m <sup>2</sup>
TOTAL AREA	- 290.10m <sup>2</sup>
PERIMETER	- 71.40m

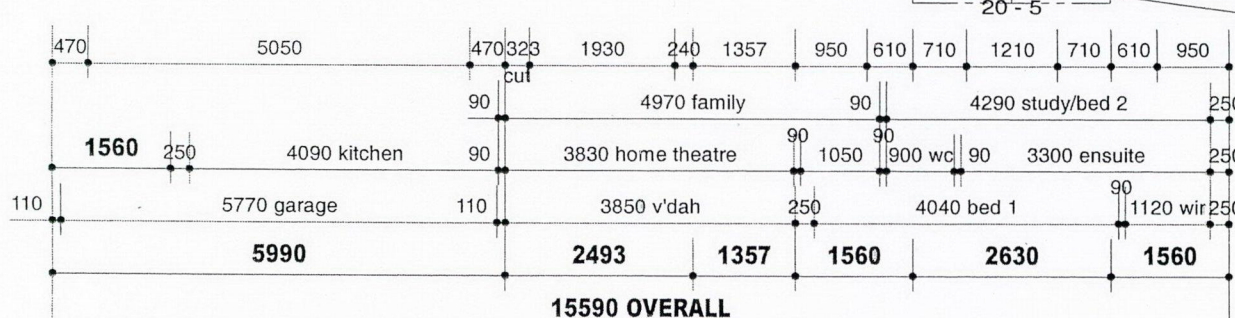

Horizon plus  
classic elevation  
games option

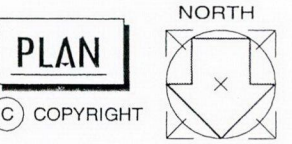

### SUPERVISOR NOTE

### Bricklayer Note

roof to be anchored down  
w/ 30mm hoop iron straps  
n1 - down 18c min @ 1800 cts  
n2 - down 18c min @ 1800 cts  
n3 (tin) - down 18c min @ 900 cts  
n3 (tiled) - down 18c min @ 1800 cts  
n4 (tin) - down 18c min @ 900 cts  
n4 (tiled) - down 18c min @ 1200 cts

### Roof Frame Note

plans detailed for "traditional" roof frame construction conforming to a.s. 1684, dale alcock homes reserve the right to use an engineered truss roof alternative.  
roof beam location & size shown are indicative only, dale alcock homes reserve the right to amend beams without notice whilst conforming to a.s. 1684

### Fixing Carpenter Note

450mm wide shelf & rail  
1650mm high to beds 2, 3 & 4.  
450mm wide shelf & rail  
1800mm high to wir.  
towel rail to be fixed  
900mm above f.f.l.

### Ceiling Fixer Note

ceilings to robes & linens to be at 2100, unless otherwise noted.

### Roof Plumber Note

total no. and positioning of rwp's is at the discretion of dale alcock homes.

### Client Note

dimensions shown on plan are brick sizes, please allow an extra 10mm to each wall for plaster & set.  
this allowance should be considered when calculating clearances for future fittings.

THIS PLAN IS TO BE READ IN CONJUNCTION WITH DALE ALCOCK STANDARD SPECIFICATION

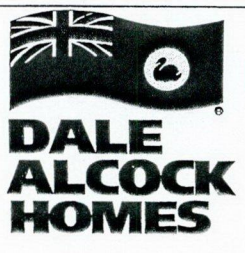

PROPOSED RESIDENCE TO BE ERECTED ON -  
Lot 3032 Merrivale Circle,  
TAPPING.  
FOR -  
Mr & Mrs Brimfield

SPACE SERIES  
two structural changes

AMENDMENT

DRAWN - LS  
DATE - 08/06/06  
SCALE - 1 : 100  
SHEET 1 OF 6 DRGS  
JOB No. 18892





## Application for Home Business: Business Summary

Since Fancy Bitches opened in March 2018, we have focused on providing a unique experience for our customers as well as their Bi-pedal parents.

Our services include.

Washing and Drying of dogs – This consists of Shampooing and Conditioning them as well as performing basic health checks and service needs such as Anal Glands, Nails, Inner Ears, Eyes as well as catering to dogs with disabilities.

We also provide all grooming services from a simple clean-up of their Face, Feet, Tails and Hygiene regions to full show grooms. As well as Dermal treatments for sensitive dogs, Intense treatments for working dogs, flea treatments etc.

Our customers also have the option of enjoying their day here while their parents are working. Common for households with both parents working full time. This is also the preferred method for parents who have dogs with issues such as Anxiety, Separation Anxiety, Depression, Previously Traumatized or having physical disabilities. We have been getting a lot of recommendations from people who have brought their troubled dog to us.

The utmost care is taken to ensure a trauma free experience with many scenarios and examples available on request. A simple example is breaks. Most dogs do not get breaks during grooming due to time restraints which can lead to trauma caused by many things like muscle fatigue in older dogs, sounds of equipment, blow dryers, brushes, and scissors etc. By allowing the dogs to have breaks when they start showing signs of stress creates short positive experiences rewriting previously traumatic ones.

During the current pandemic, we have also decided to offer doggy day care to healthcare and frontline servicemen. Changes to shifts for front line workers such as Nurses, Police and Paramedics have seen most changing to a 12-hour shift, meaning their dog would be left for more than 12 hours when including travel time, which leads to barking and restlessness from the dog and guilty thoughts from the parents not to mention angry neighbours. We feel a duty or sense of responsibility to assist those currently risking themselves during these precarious times. Especially those working 12 hours, serving us, to come home to find a complaint from their neighbour regarding their dog barking. We have several who drop their dogs off for this reason alone.



## Application for Home Business - Hours of Operation

Fancy Bitches operates Monday through Saturday with no grooming on Sunday's.

Recently, due to the current global pandemic, we occasionally have a dog on the Sunday just for the day due to Healthcare workers completing 12-hour shifts. However, we are not open for the public.

This service is not advertised and is only offered to existing customers who have had their working hours changed.

We Generally open at 8am for customer drop offs with tasks relating to grooming commencing from 9am. All grooming is generally completed by 5pm with last picks up generally around 6pm.

	<b>Open</b>	<b>Close</b>
<b>Monday</b>	8am	6pm
<b>Tuesday</b>	8am	6pm
<b>Wednesday</b>	8am	6pm
<b>Thursday</b>	8am	6pm
<b>Friday</b>	8am	6pm
<b>Saturday</b>	8am	6pm
<b>Sunday</b>	Closed to the Public	

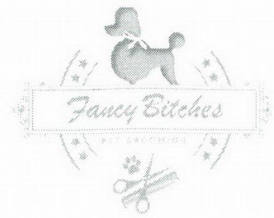

## **Application for Home Business – Customer Traffic**

As Fancy Bitches operates as a Boutique Home-based salon without the usual overhead premises costs which demand a high volume of customers to remain operational. We are able limit the number of dogs for any particular day allowing us to give a higher level of service and attention to customers with issues, traumatic histories, or disabilities.

Approximately 65% of drop-offs are for 1 dog. With 33% of drop-offs having 2 dogs and 2% with 3 or more dogs.

Approximately 90% of all customers are dropped off at unique times avoiding overlapping with other drop-offs.

10% of drop-offs overlap due to extra time being taken with 1<sup>st</sup> time customers. school time drop offs or shift workers (mostly Nurses). To this date, the most at any one stage has been 3 additional cars which our driveway easily accommodated, with a total of 4 dogs being dropped off. (1 car had 2 dogs). No disruption to local traffic was or would be affected by any less than 6 or 7 cars which would be highly unlikely.

As all dogs are dropped off and picked up at a later time, this results us in us having no customer cars parked at our premises for any extended periods of time.