

M+I KAPURALIL - NEERABUP NZI SHOP FIV

SITE PLAN - LOT 41, 1910 WANNEROS RD NEERABUP WA 6031

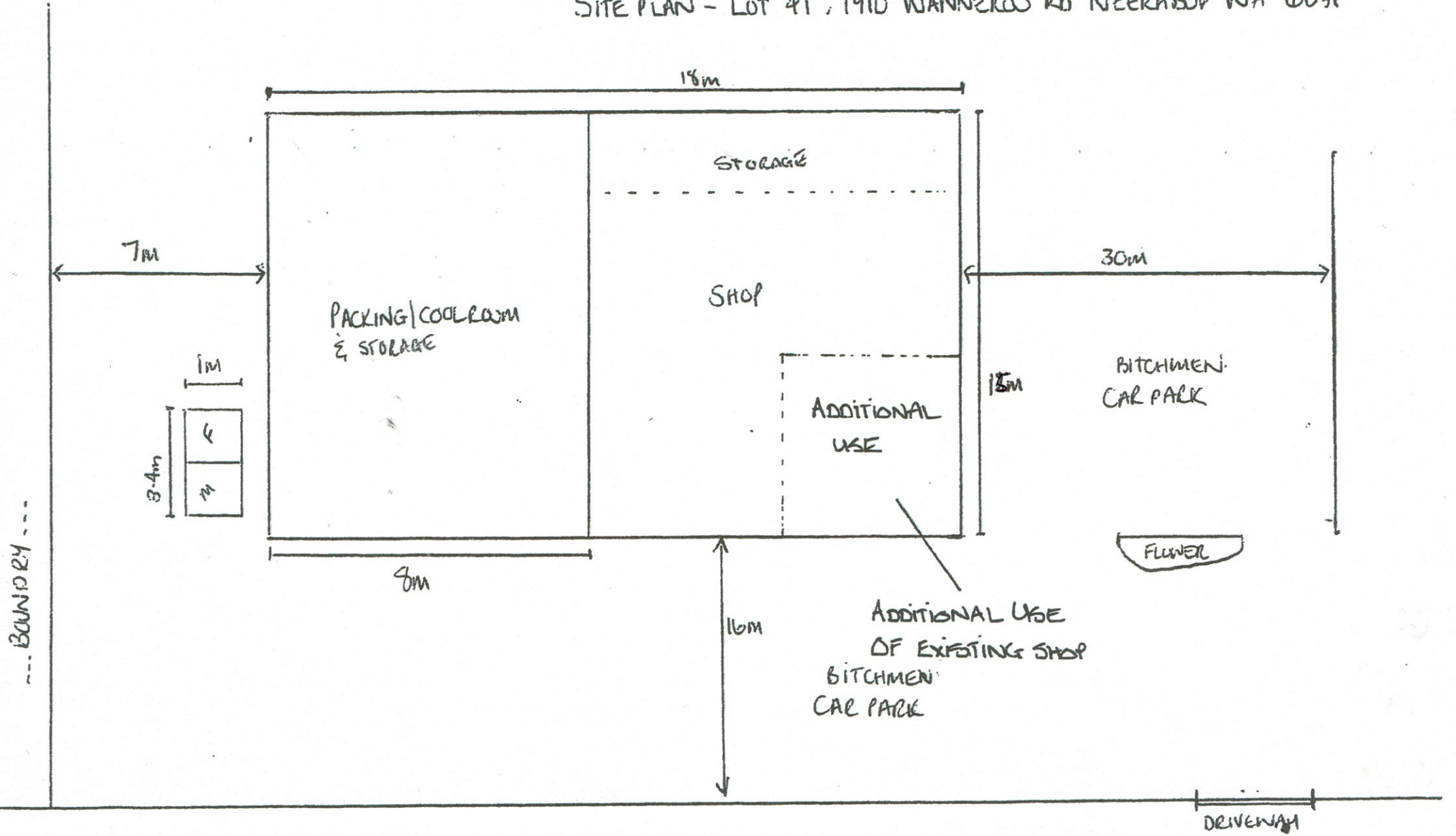

ADDITIONAL USE
OF EXISTING SHOP
BITCHMEN
CAR PARK

* M&I KAPURALIC : NEERABUP NO.1 SHOP
* SITE PLAN OF :
1910 (LOT 41) WANNEROO ROAD
NEERABUP WA 6031

2.

BOUNDARY LINE



5m

1m

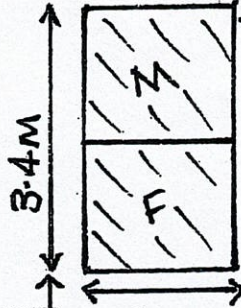

3.4m

1m

17m.

STORAGE ROOM

CLIP

COOL ROOM

SHOP

BOUNDARY LINE

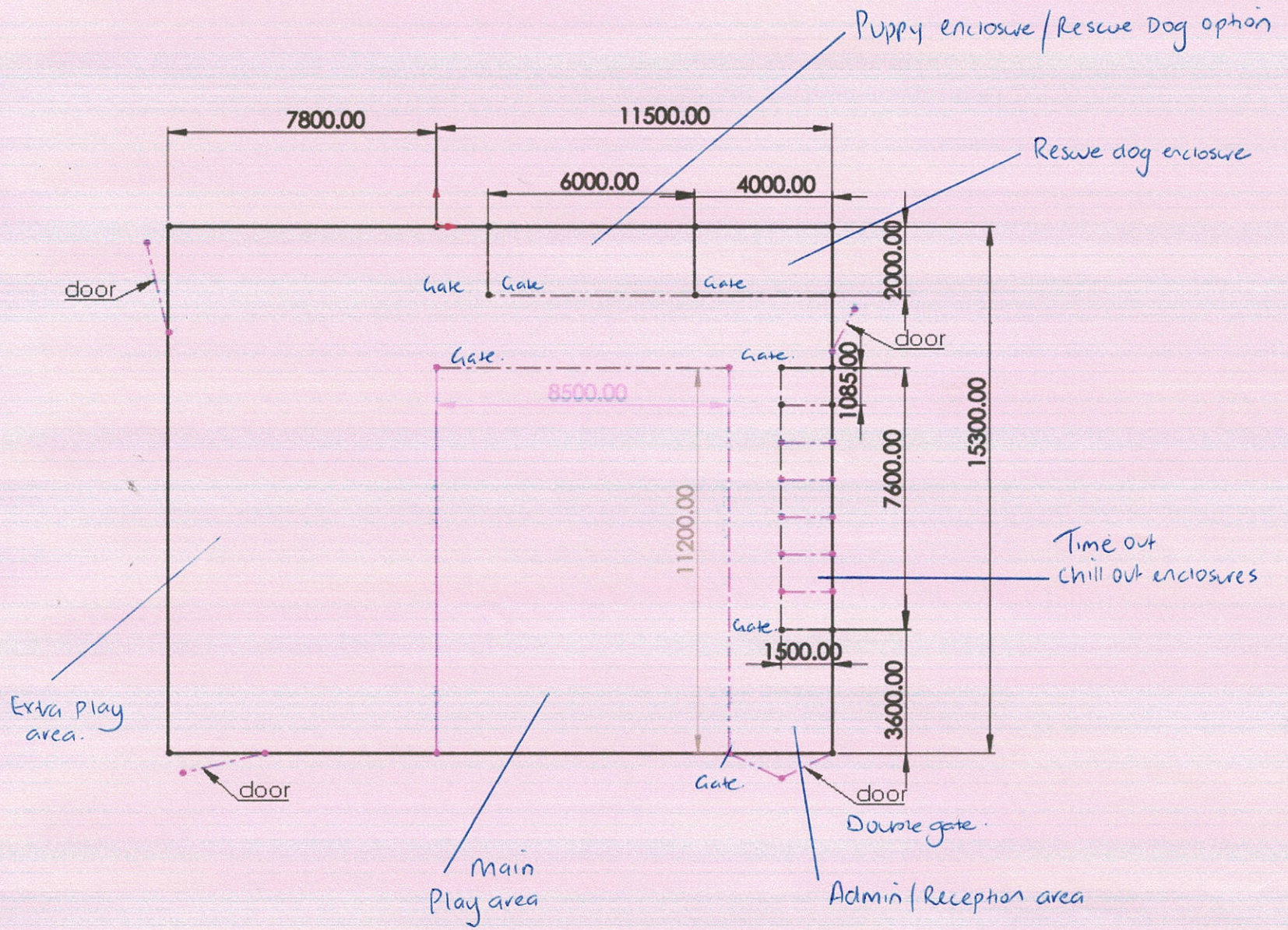

SUBMISSION FOR CHANGE OF USE OF PREMISES FROM NURSERY TO DOG DAY CARE & TRAINING FACILITY 1910 WANNEROO RD , NEERABUP 6031

To the Planning Officer

I Wendy Timms would like to apply for the change of use of premise, that being 1910 Wanneroo Rd Neerabup 6031

The existing business was a Retail Nursery and I would like to change the use of premise to a dog day care , training and education centre for dogs and their owners.

With current dog training qualifications and ongoing training through the IMDT (Institute of Modern Dog Training) and industry experience for over 14 years I am hoping to open a day care & training centre and offer a wide range of dog obedience classes, puppy training, dog first aid training ect to create awareness , to promote responsible dog ownership and give the wider community the opportunity to obtain basic training tools to allow dogs to be more accepted and involved in our daily lives in the community. This will all take place in a safe controlled environment.

Ideally the Opening hours would be 6am-6pm Monday-Friday to allow people to drop and collect their dogs before/after work.

Monday - Friday 6am - 6pm

Drop offs to occur between 6.30am-9am

Pick ups around 4pm-6pm

Saturday 9am-2pm

Ranging between 1-5 employees dependant on dog numbers booked

There is currently 15 allocated marked car bays on the property with extra off road parking available on existing site.

I will be offering a smaller size day care with the purpose of being able to work individually with these dogs to provide a more intimate personalised training whilst in the day care environment.

We will also be offering complimentary placements for Rescue dogs to be part of our integration programme, this is to socially prepare these dogs ready for their adoptive homes.

We would like to provide a service for 25-35 dogs in the premise at any given time.

The current concrete floor will be covered with a non slip and urine resistant coat, The day care area will be split into seperate sections for large and small dogs as well as a dedicated puppy area and a rescue dog enclosure. There will be multiple time out enclosures and areas for rest time. The room will be double gated at every entry and exit point. The walls will be lined with protective coating / material to 1.2 metres from ground high to enable effective cleaning and sanitisation.

Dog faces will be double bagged and stored in freezer to eliminate odour before being disposed of.

I envisage the day care and dog obedience / training centre to be an extremely positive and warranted business in this rapidly growing area in our northern suburbs.