

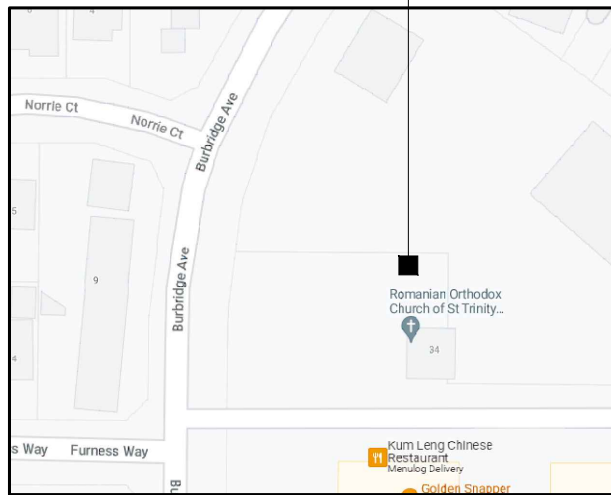

PROPOSED OPTUS
BASE STATION



LOCALITY MAP

COPYRIGHT © - GOOGLE MAPS

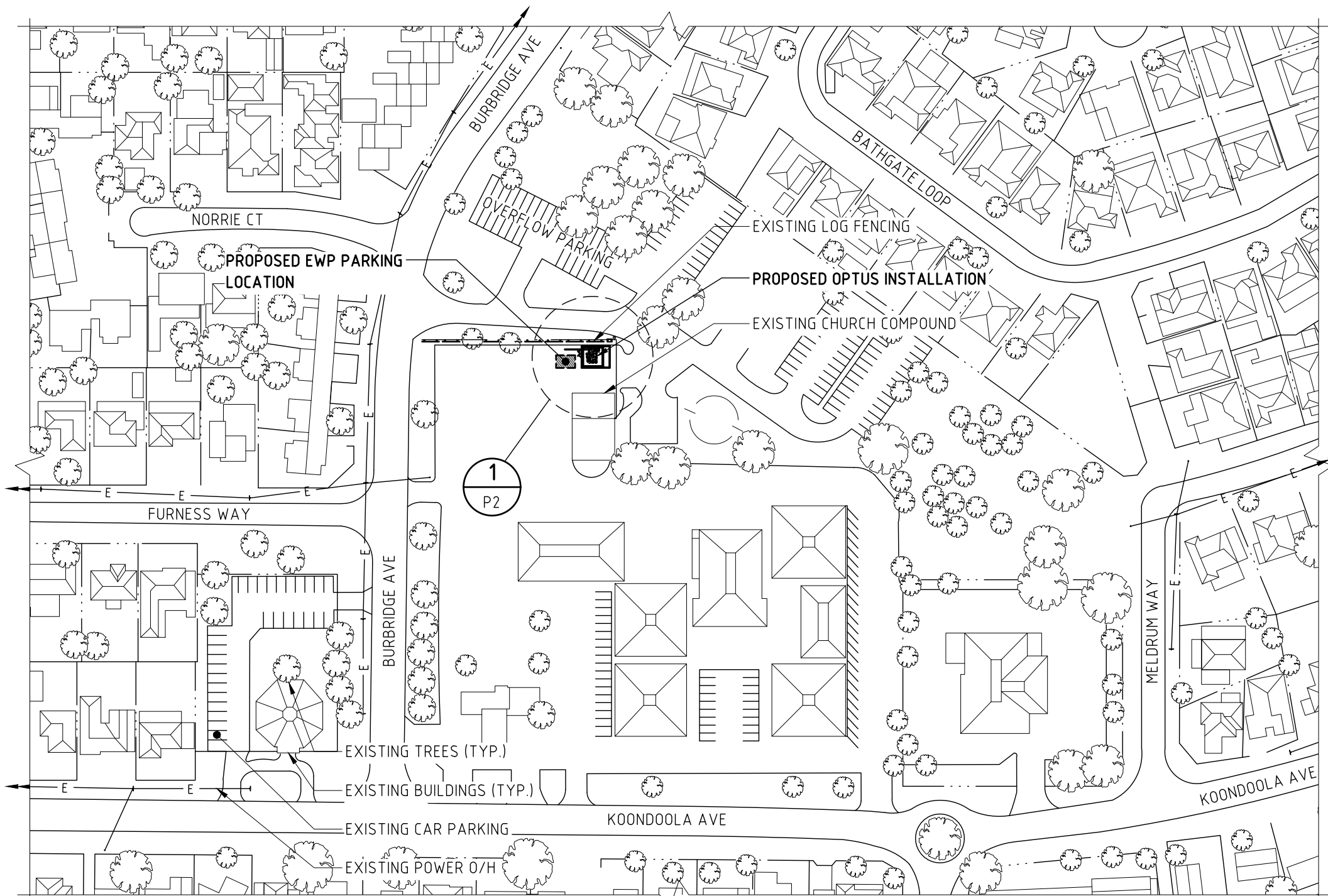

OVERALL SITE PLAN

SCALE 1:1500

Rev	Date	Revision Details	Consultant	CAD	Designer	Verifier	Approver
01	05.11.21	ISSUED FOR APPROVAL	KORDIA	DB	SOC	DR	MI



Level 4, 68 Waterloo Rd, Macquarie Park, NSW 2113
T +61 2 9856 2600 | www.kordia.com.au

Client:



Project:

MOBILE NETWORK AUSTRALIA
SITE No:- P1154
GIRRAWHEEN SOUTH
34 KOONDOOLA AVENUE

Drawing Title:

DRAFT SITE LAYOUT - SHEET 1 OF 2

Drawing Status:

FOR APPROVAL

Drawing No.

P1154-P1

Revision

01



EXISTING PAVED ACCESS ROAD TO OVERFLOW PARKING

EXISTING LOG FENCING

PROPOSED OPTUS UNDERGROUND FIBRE (INDICATIVE ONLY)

PROPOSED OPTUS UNDERGROUND POWER (INDICATIVE ONLY)

PROPOSED EWP PARKING LOCATION

PROPOSED OPTUS PALE EUCALYPT SECURITY FENCING WITH DOUBLE ACCESS GATES

PROPOSED OPTUS RRU'S (12 OFF & 9 OFF FUTURE)

PROPOSED OPTUS PANEL ANTENNAS (10 OFF & 3 OFF FUTURE) WITH ANCILLARIES TO MOUNT BEHIND

EXISTING CHURCH COMPOUND

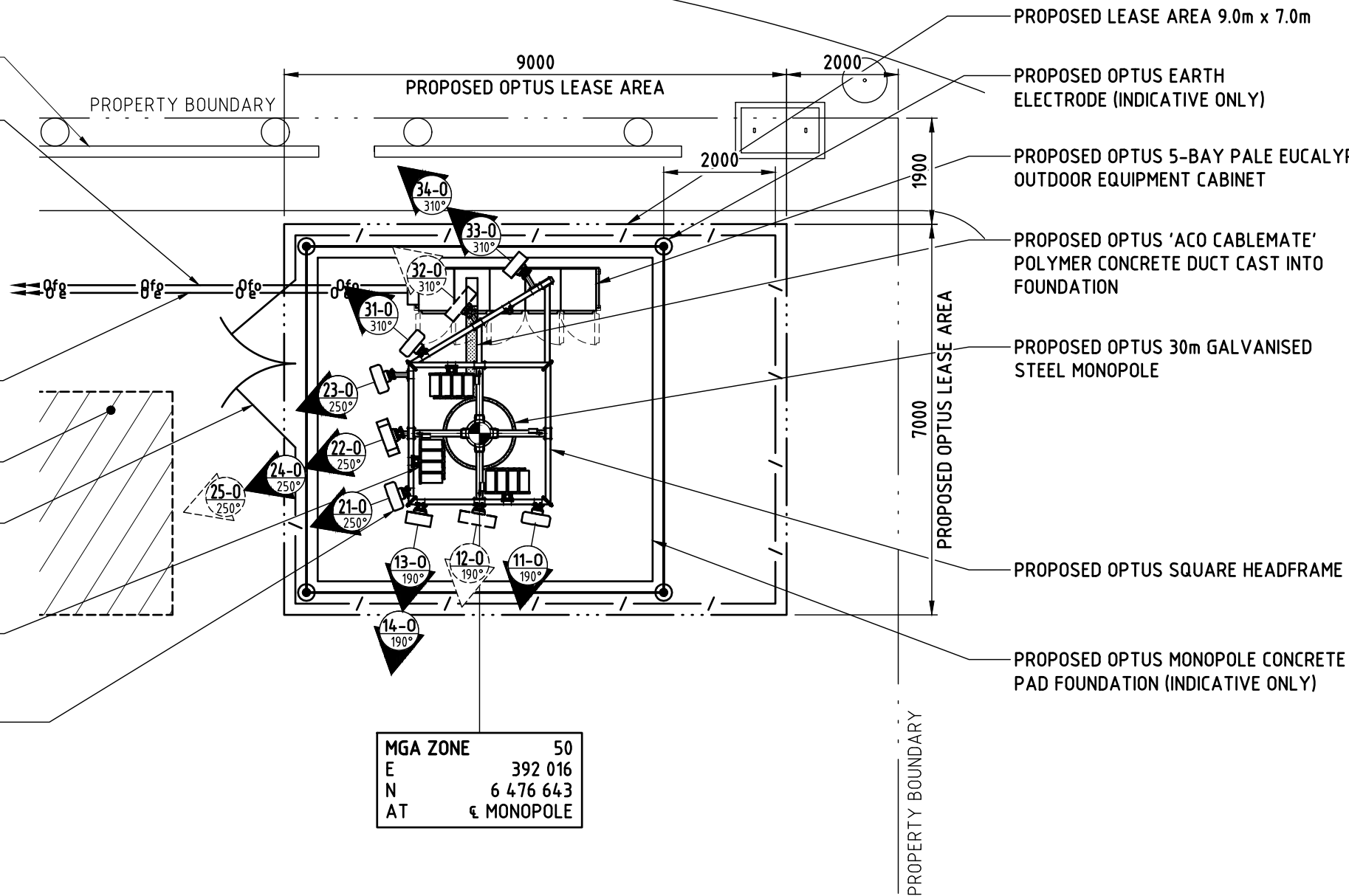

MGA ZONE	50
E	392 016
N	6 476 643
AT	€ MONOPOLE

DETAIL 1
SCALE 1:100 P1

NOTES:

1. THIS DRAWING IS DIAGRAMMATIC ONLY AND SHOULD NOT BE SCALED.
2. DIMENSIONS, COORDINATES, AND LEVELS SHOWN ARE NOMINAL AND SUBJECT TO CONFIRMATION BY SURVEYOR.

SITE ADDRESS:

KOONDOOLA PLAZA SHOPPING CENTRE
34 KOONDOOLA AVENUE
KOONDOOLA WA 6064

NOTES:

1. BASIS OF DESIGN
 - > SITE INSPECTION 08/10/2021.
2. PANEL ANTENNAS
 - > S1/S3 3-OFF PER SECTOR, S2 4-OFF.
 - > SECTOR 1 - 31°, SECTOR 2 - 190°, SECTOR 3 - 250°
 - > MOUNTED ON PROPOSED HEADFRAME
3. TRANSMISSION
 - > VIA FIBRE ONLY
4. EQUIPMENT SHELTER
 - > 5-BAY THERMO CAB OUTDOOR CABINET
5. OPTUS MONOPOLE
 - > 30m PROPOSED MONOPOLE STRUCTURE
6. FEEDER CABLES
 - > 3-OFF 9/18 MLEH TRUNK CABLES
 - > LENGTH: 40m ALL SECTORS
7. SITE ACCESS
 - > SITE ACCESS FROM BURBRIDGE AVE
8. ANTENNA ACCESS
 - > VIA CHERRY PICKER BY QUALIFIED PERSONNEL
9. POWER SUPPLY
 - > 63A 3P SUPPLY FROM EXISTING SMSB WESTERN POWER TO CONFIRM UPGRADE REQUIREMENTS
10. OTHER (PAINTING, LANDSCAPING, SCREENING)

Rev	Date	Revision Details	Consultant	CAD	Designer	Verifier	Approver
01	05.11.21	ISSUED FOR APPROVAL	KORDIA	DB	SOC	DR	MI



Level 4, 68 Waterloo Rd, Macquarie Park, NSW 2113
T +61 2 9856 2600 | www.kordia.com.au



Client:
Project: MOBILE NETWORK AUSTRALIA
SITE No:- P1154
GIRRAWHEEN SOUTH
34 KOONDOOLA AVENUE

Drawing Title:
DRAFT SITE LAYOUT - SHEET 2 OF 2
Drawing Status:
FOR APPROVAL
Drawing No.
P1154-P2
Revision
01

NOTES:
 1. THIS DRAWING IS DIAGRAMMATIC ONLY AND SHOULD NOT BE SCALED.

▼ EL. 30.90m
 & PROPOSED OPTUS RRU'S (12 OFF)
 ▼ EL. 30.00m
 TOP OF OPTUS MONOPOLE
 & FUTURE OPTUS RRU'S (9 OFF)

▼ EL. 31.85m
 & PROPOSED OPTUS 5G AAU1_A
 PANEL ANTENNAS (3 OFF)
 ▼ EL. 31.50m
 & PROPOSED OPTUS 6P PANEL
 ANTENNAS (2 OFF)
 ▼ EL. 31.00m
 & PROPOSED OPTUS SQUARE HEADFRAME
 & PROPOSED OPTUS 12P PANEL ANTENNAS (2 OFF)
 ▼ EL. 30.80m
 & PROPOSED OPTUS 5G AAU1_B PANEL
 ANTENNAS (3 OFF)
 ▼ EL. 30.35m
 & PROPOSED OPTUS 5G AAU2_A
 FUTURE PANEL ANTENNAS (2 OFF)
 ▼ EL. 29.35m
 & PROPOSED OPTUS 5G AAU2_A
 FUTURE PANEL ANTENNA (1 OFF)
 ▼ EL. TBC
 & FUTURE OPTUS PARABOLIC ANTENNA (TBC)

PROPOSED OPTUS TRUNK CABLES (3 OFF)
 TO RUN INTERNAL WITHIN MONOPOLE
 PROPOSED OPTUS 30m HIGH GALVANISED
 STEEL MONOPOLE WITH PROPOSED SQUARE
 HEADFRAME ON TOP

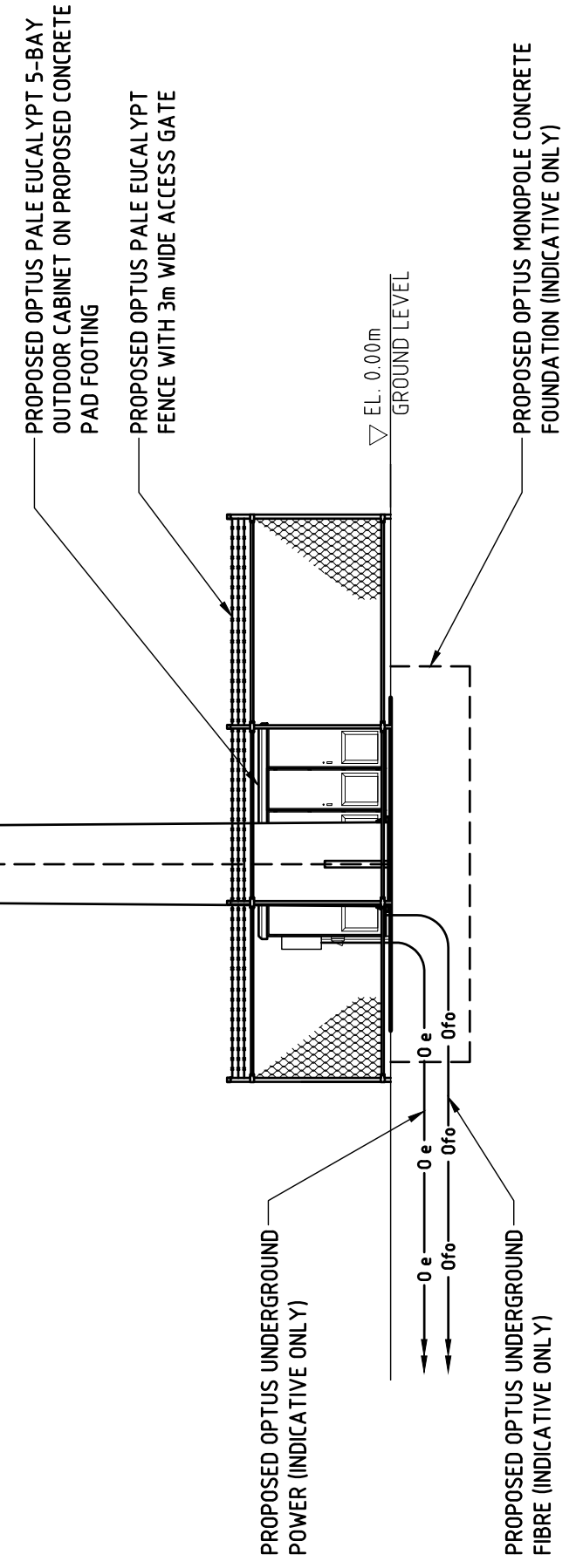
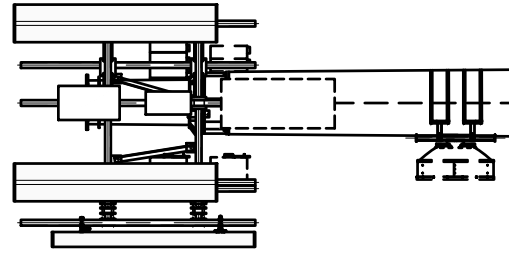

SOUTHERN ELEVATION
 SCALE 1:100

01	05.11.21	ISSUED FOR APPROVAL	KORDIA	DB	SOC	DR	MI
Rev	Date	Revision Details	Consultant	CAD	Designer	Verifier	Approver

kordia
 Level 4, 68 Waterloo Rd, Macquarie Park, NSW 2113
 T +61 2 9856 2600 | www.kordia.com.au

Client:

Project:
 MOBILE NETWORK AUSTRALIA
 SITE No:- P1154
 GIRRAWHEEN SOUTH
 34 KOONDOLA AVENUE

Drawing Title:
DRAFT SITE ELEVATION

Drawing Status:
FOR APPROVAL

Drawing No.
P1154-P3

Revision
01

