

This drawing must be read in conjunction with all other contract documents including the project specifications, schedules and any instructions issued during the course of the contract. The Contractor must verify all dimensions on site and check the location of services before commencement of work. The Contractor is to notify the Superintendent of any discrepancies between the drawings or specifications. Drawings are not to be used for construction unless identified in the title block as 'For construction'. All drawings to be read as 'As shown otherwise stated'. Drawings are intended for digital output and DWG files will be issued upon request. Copyright Oxygen Pty Ltd

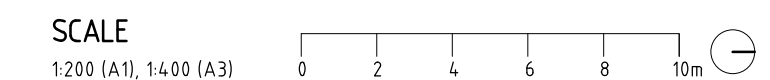

LEGEND

NEW	
	EXTENT OF WORKS
	COMPACTED GRAVEL
	NEW TREE REFER TO DETAIL 101.01
	PAVING REFER TO DETAIL 102.03
	PLANTING REFER TO DETAIL 101.02

TREE SCHEDULE

CODE	BOTANIC NAME	SPACING	SIZE	QTY
BD	Brachychiton discolor x populneus	AS SHOWN	4.5L	2
BL	Banksia littoralis	AS SHOWN	4.5L	2
EP	Eucalyptus platypus	AS SHOWN	4.5L	6
MG	Magnolia grandiflora	AS SHOWN	4.5L	4
MR	Melaleuca rhamnophylla	AS SHOWN	4.5L	7

PLANT SCHEDULE

CODE	BOTANIC NAME	SPACING	SIZE	QTY
AP	Anigozanthos flavidus x pulcherrimus	3.0/m ²	14.0mm	73
AR	Anigozanthos flavidus x rufus	3.0/m ²	14.0mm	100
BS	Beaufortia squarrosa	3.0/m ²	14.0mm	70
CP	Melaleuca phoenicea	3.0/m ²	14.0mm	86
CU	Chamaelucium uncinatum	3.0/m ²	14.0mm	82
DC	Darwinia citriodora	3.0/m ²	14.0mm	34
DL	Dianella revoluta 'Little Rev'	3.0/m ²	14.0mm	210
DP	Dianella prunina 'Utopia'	3.0/m ²	14.0mm	110
DT	Dianella tasmanica	3.0/m ²	14.0mm	166
EG	Eremophila glabra 'Emu Bush'	3.0/m ²	14.0mm	202
GH	Grevillea 'Honey Gem'	3.0/m ²	14.0mm	88
GG	Grevillea obtusifolia 'Gin Gin Gem'	3.0/m ²	14.0mm	218
GR	Gazania rigens	3.0/m ²	14.0mm	232
HA	Hypocalymma angustifolium	3.0/m ²	14.0mm	50
HP	Hakea petiolaris	3.0/m ²	14.0mm	138
KP	Kunzea pulchella	3.0/m ²	14.0mm	172
PM	Protea magnifica	3.0/m ²	14.0mm	212
VN	Verticordia nitens	3.0/m ²	14.0mm	82

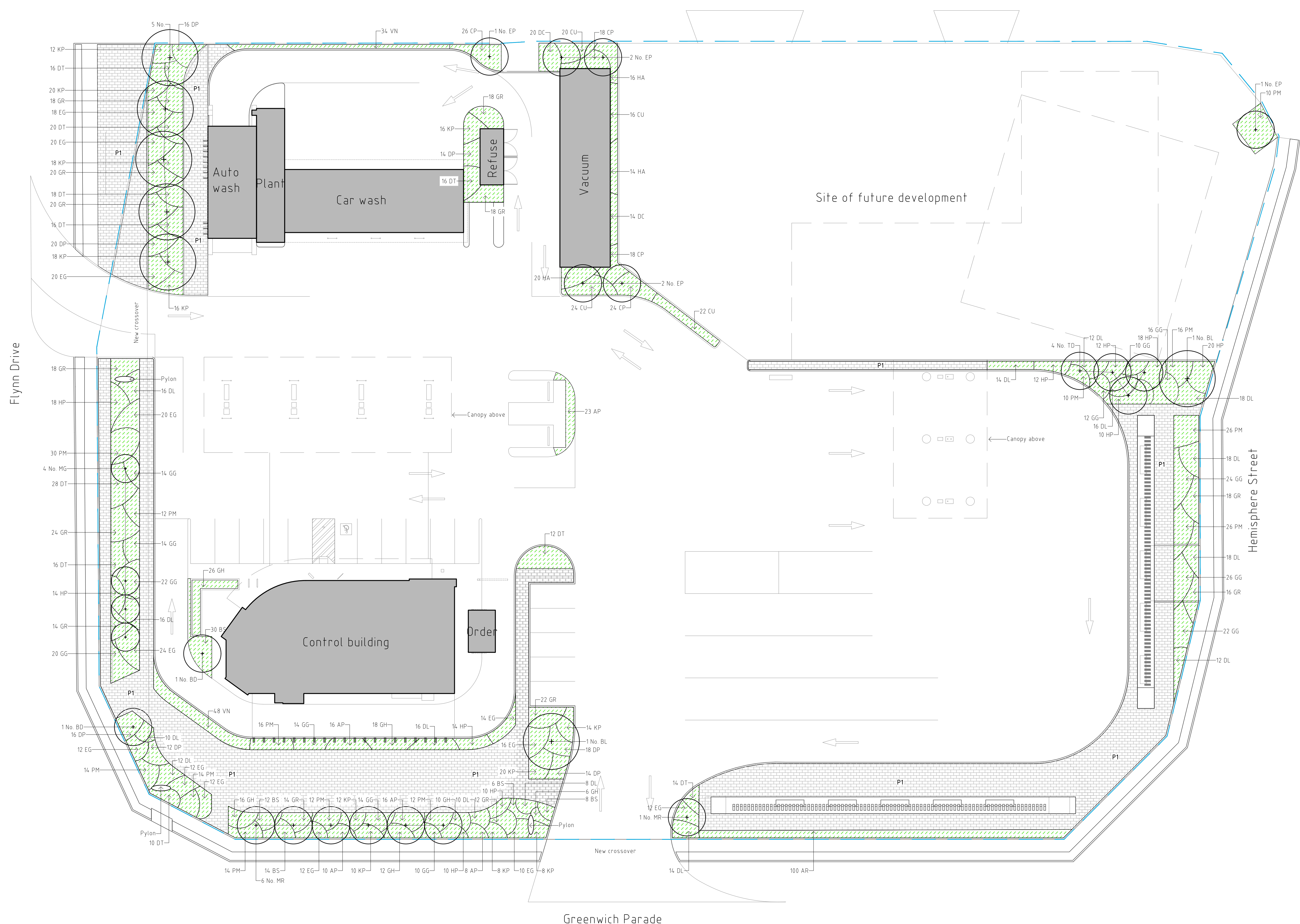

oxygen

Oxygen Pty Ltd
98-100 Halifax Street
Adelaide SA 5000
T +61 (08) 7324 9600
design@oxygen.net.au
oxygen.net.au

CLIENT ARCHITECTS
PEREGRINE CORPORATION ADS ARCHITECTS



PROJECT drawing title
NEERABUP OTR 101 LANDSCAPE PLAN

15.04.7.107

ISSUE
DRAFT E

ISSUE	DATE	ISSUE	DWN	CHK	APP
A	30.08.22	DRAFT	EH	JH	TW
B	29.09.22	DRAFT	EH	JH	
C	20.10.22	DRAFT	EH	JH	
D	03.02.22	DRAFT	EH	JH	
E	03.02.23	DRAFT	EH	JH	

This drawing must be read in conjunction with all other contract documents including the project specifications, schedules and any instructions issued during the course of the contract. The Contractor must verify all dimensions on site and check the location of services before commencement of work. The Contractor is to notify the Superintendent of any discrepancies between the drawings or specifications. Drawings are not to be used for construction unless identified in the title block as 'for construction'. All drawings to be read as if unless otherwise stated. Drawings are intended for digital setout and DWG files will be issued upon request. Copyright Dugen Pty Ltd

SCALE
VARIES

NOTES

EXISTING SERVICES
THE CONTRACTOR MUST LOCATE AND MARK ALL UNDERGROUND SERVICES BEFORE COMMENCING WORK ON SITE.

TREE PLANTING
PREPARE TREE HOLES TO A MINIMUM SIZE OF THE DEPTH OF THE ROOTBALL x 1m WIDE AND BREAK THE SUBGRADE TO A MINIMUM DEPTH OF 200MM BELOW. TAKE PARTICULAR CARE TO BREAK UP ANY GLAZING TO SIDES OF TREE HOLE. FINISH THE ROOTBALL LEVEL WITH THE FINAL SURROUNDING SOIL LEVEL AND BACKFILL THE PLANTING HOLE WITH SITE TOPSOIL BLENDED WITH 20% ORGANIC MIX. PROVIDE A 1m DIAMETER MULCHED WATERING BOWL TO THE BASE OF THE TREE. STAKE TREES WITH 2 No. 2500x50x50 HARDWOOD STAKES AND TIE WITH 50mm HESSIAN TIES SECURELY STAPLED TO THE STAKES. ENSURE STAKES AND TIES REMAIN CLEAR OF BRANCHES, FOLIAGE AND ROOTBALL.

PLANTING BEDS
CULTIVATE EXISTING GROUND TO A MINIMUM DEPTH OF 300 MM AND PLACE 300MM IMPORTED 'ORGANIC MIX'. PLACE PLANTS IN THE CENTER OF THE PLANTING HOLE AND FINISH THE TOP OF THE ROOT BALL LEVEL WITH THE FINISHED SURFACE OF THE SURROUNDING SOIL. APPLY TERRACOTTEM FERTILISER TO MANUFACTURERS RATES AT TIME OF PLANTING AND AFTER PLANTING PLACE A 100MM MINIMUM DEPTH OF COTTAGE MULCH. THOROUGHLY WATER PLANTS BEFORE AND IMMEDIATELY AFTER PLANTING, AND AS REQUIRED TO MAINTAIN HEALTH AND VIGOUR. AVERAGE 3 PLANTS/M².

IRRIGATION
PROVIDE AN AUTOMATIC IN-LINE DRIP IRRIGATION SYSTEM TO ALL PLANTING BEDS AND TREES.
DRIP IRRIGATION SPECIFIED AS NETAFIM TECHLINE 16 POLY TUBE 1.6Lph @ 0.5M SPACINGS OR SIMILAR APPROVED.
FOR ALL TREE PLANTING INSTALL AT BASE OF TREE 4No 4Lph PC DRIP EMITTERS ON 13MM POLY LOOP (OR IN-LINE EQUIVALENT).
ALL POLY TUBING TO BE LAID ON SURFACE AND COVERED WITH MULCH.
PROVIDE BACKFLOW PREVENTION, AUTOMATIC CONTROLLER AND OTHER DEVICES AS REQUIRED.

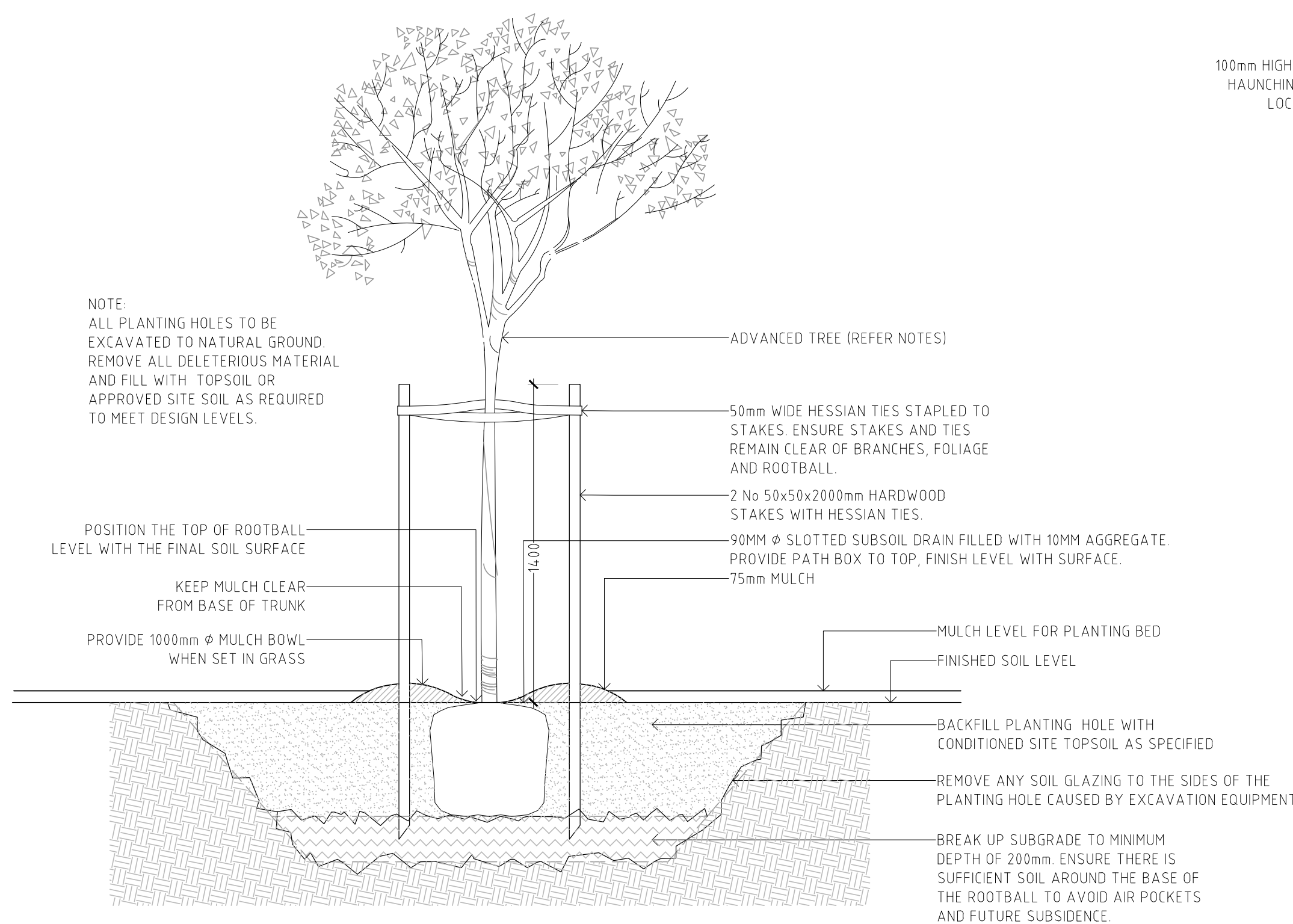

01 TYPICAL TREE IN MULCH DETAIL
SCALE 1:20 @ A1

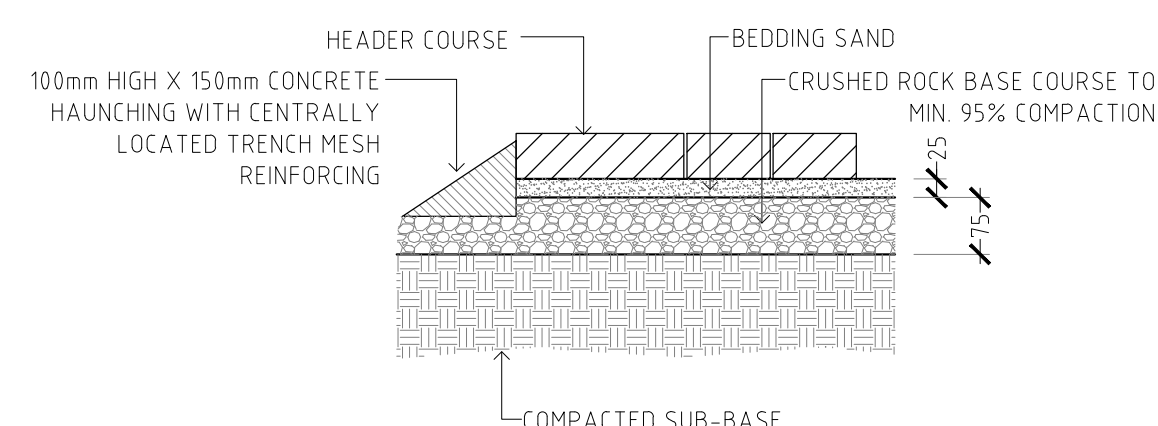

03 TYPICAL PAVING AND PAVING EDGE DETAIL
SCALE 1:10 @ A1

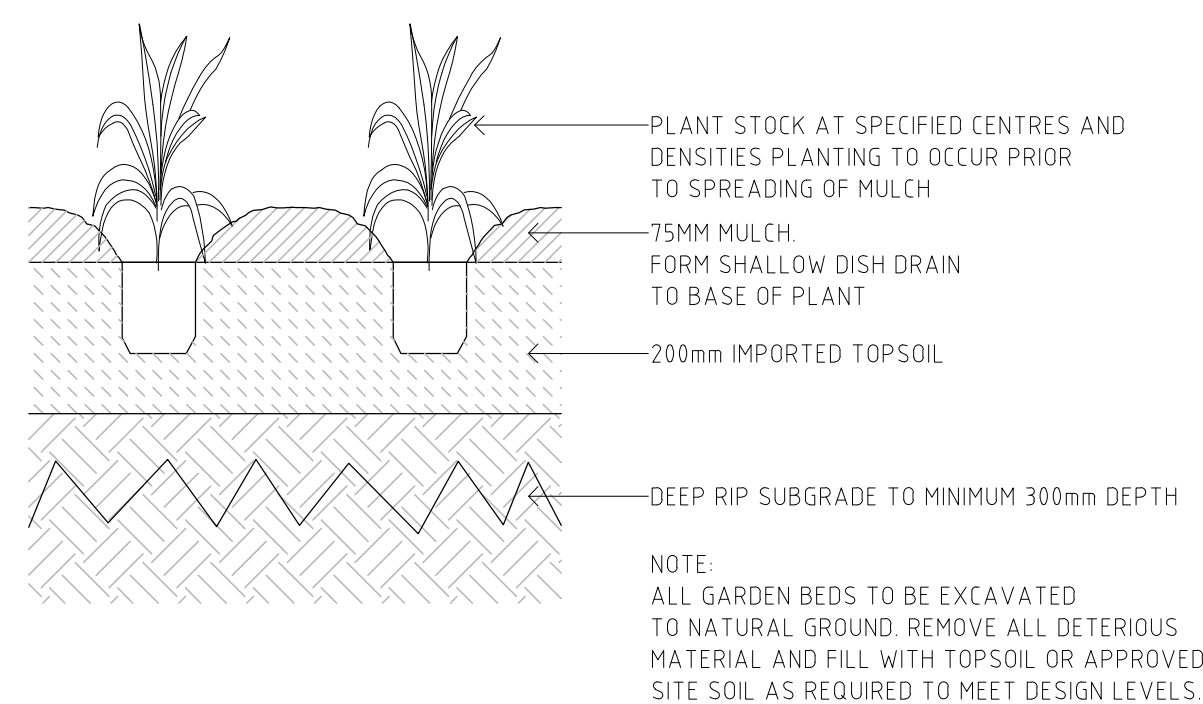

02 TYPICAL SHRUB PLANTING DETAIL
SCALE 1:10 @ A1

oxygen

Oxygen Pty Ltd
98-100 Halifax Street
Adelaide SA 5000
T +61 (08) 7324 9600
design@oxygen.net.au
oxygen.net.au

CLIENT
PEREGRINE CORPORATION
ARCHITECTS
ADS ARCHITECTS



PROJECT
NEERABUP OTR

drawing title
102 DETAILS

15.04.7.107

ISSUE
DRAFT

E

ISSUE	DATE	ISSUE	DWN	CHK	APP
A	30.08.22	DRAFT	EH	TW	
B	29.09.22	DRAFT	EH	JH	
C	20.10.22	DRAFT	EH	JH	
D	03.02.22	DRAFT	EH	JH	
E	03.02.23	DRAFT	EH	JH	