



EXISTING BOARDWALK  
70000 OVERALL BUILDING

TACOMA LANE

- AMENDMENT A- 10-2-2015
1. 'c'- 10MM GLASS+ SEALS IN COMMERCIAL FRAMES TO DOORS & WINDOWS AS SHOWN FACING MARINA & BOAT RAMP.
  4. ELECTRIC CLOTHES DRYER ADDED TO EACH UNIT.
  5. 1600 HIGH TIMBER SCREEN AS NOTED.

**DOEPEL MARSH** architects

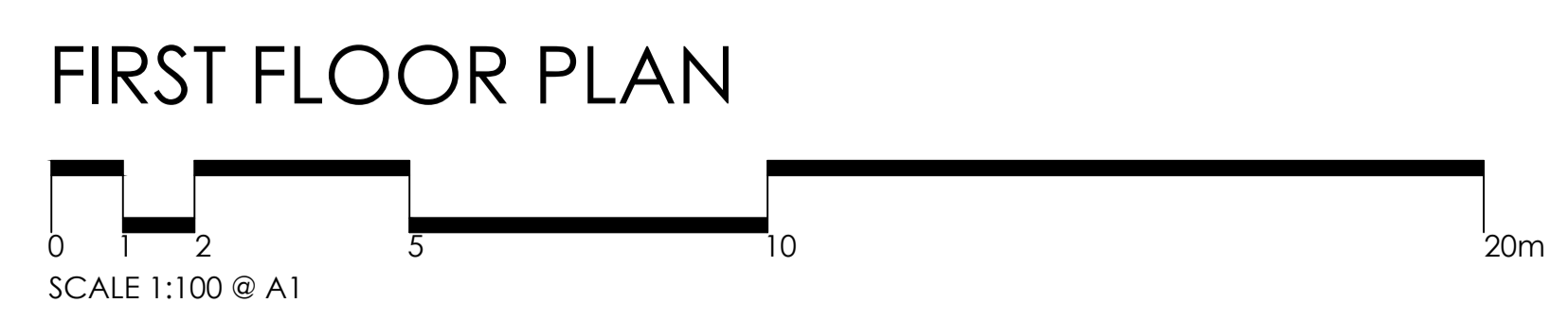

10 MIXED USE DEVELOPMENT  
LOT 562 TACOMA LANE, MINDARIE

JOB NO. 14.72  
DATE: DEC 2014  
DA 1.3 A  
© COPYRIGHT 2014