

LOT 9002 PINJAR ROAD (SUBDIVISION REF 151222)
LOCAL DEVELOPMENT PLAN No. 2 - EAST WANNEROO CELL 2
 THE PROVISIONS OF THE CITY OF WANNEROO DISTRICT PLANNING SCHEME No. 2
 AND THE R-CODES APPLY UNLESS OTHERWISE VARIED BELOW.

1. QUIET HOUSE DESIGN MEASURES ARE REQUIRED FOR LOTS AFFECTED BY TRANSPORT NOISE, AS SHOWN ON THE PLAN, AND IDENTIFIED IN THE ACOUSTIC ASSESSMENT REPORT PREPARED BY HERRING STORER ACOUSTICS (APRIL 2015).

THIS LDP HAS BEEN APPROVED BY COUNCIL UNDER CLAUSE 52(1)(a) OF THE DEEMED PROVISIONS OF DISTRICT PLANNING SCHEME No. 2:

[Signature]
 MANAGER, PLANNING IMPLEMENTATION
 CITY OF WANNEROO

DATE 21/01/16.

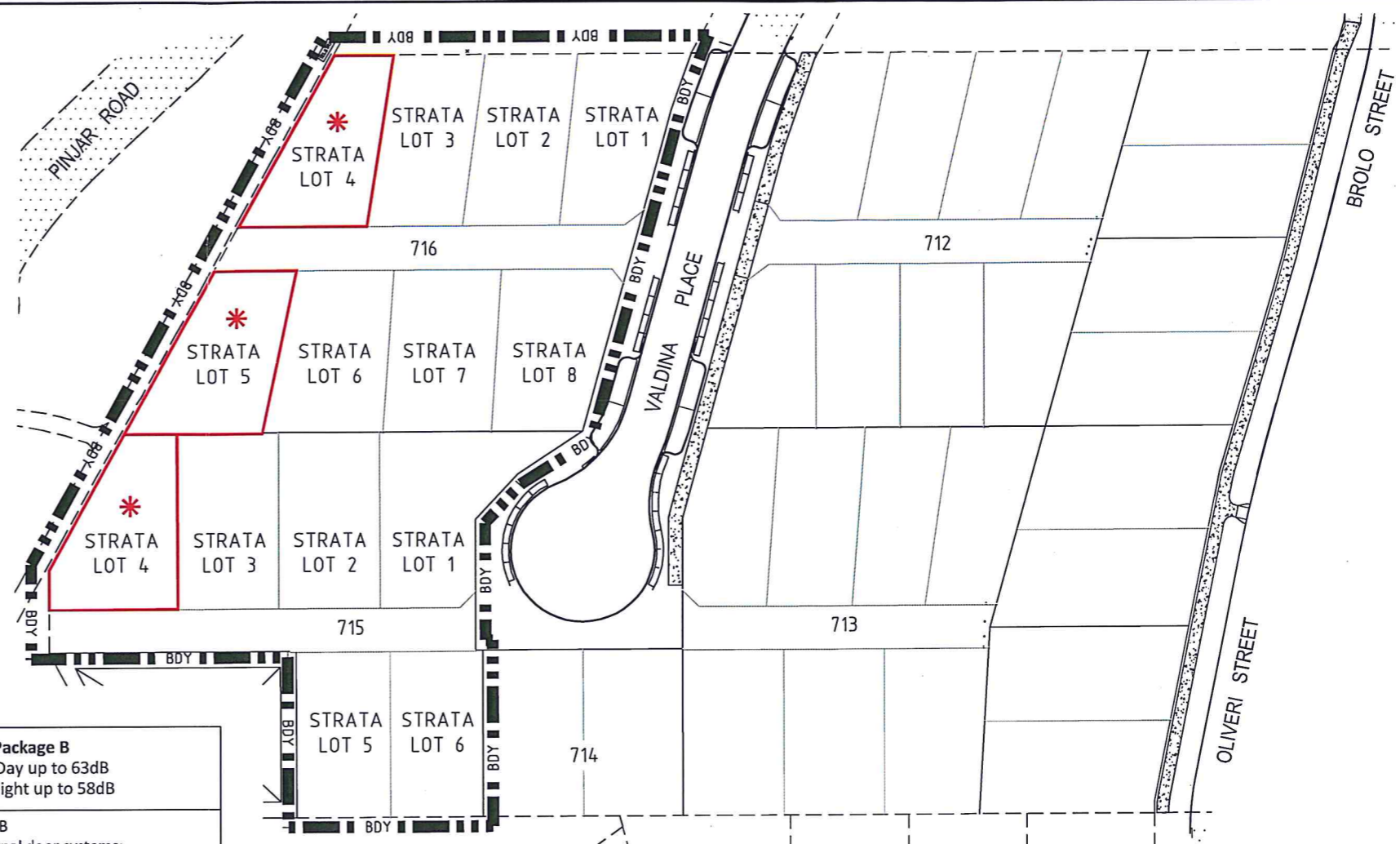

LEGEND

- BDY BOUNDARY OF L.D.P.
- LOTS REQUIRE QUIET HOUSE DESIGN MEASURES:
 PACKAGE A - GROUND FLOOR
 PACKAGE B - UPPER FLOOR

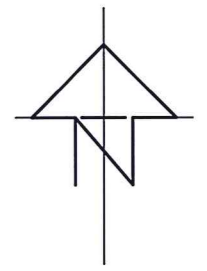

LOCAL DEVELOPMENT PLAN
LOT 9002 PINJAR ROAD, SINAGRA
CITY OF WANNEROO

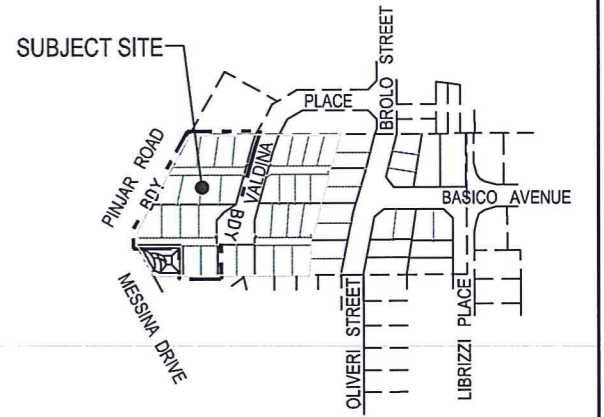

LOCALITY MAP

QUIET HOUSE DESIGN MEASURES TABLE

AREA	ORIENTATION TO ROAD OR RAIL CORRIDOR	Package A LAeq,Day up to 60dB LAeq,Night up to 55dB	Package B LAeq,Day up to 63dB LAeq,Night up to 58dB
BEDROOMS	FACING	<ul style="list-style-type: none"> • Walls to R_w+C_r 45dB • Windows and external door systems: Minimum R_w+C_r 28dB (Table 6.4), total glazing area up to 40% of room floor area. [if R_w+C_r 31dB: 60%] [if R_w+C_r 34dB: 80%] • Roof and ceiling to R_w+C_r 35dB (1 layer 10mm plasterboard) • Mechanical ventilation as per Section 6.3.1 	<ul style="list-style-type: none"> • Walls to R_w+C_r 50dB • Windows and external door systems: Minimum R_w+C_r 31dB (Table 6.4), total glazing area up to 40% of room floor area. [if R_w+C_r 34dB: 60%] • Roof and ceiling to R_w+C_r 35dB (1 layer 10mm plasterboard) • Mechanical ventilation as per Section 6.3.1
	SIDE-ON	• As above, except glazing R _w +C _r values for each package may be 3dB less, or max % area increased by 20%	
	OPPOSITE	<ul style="list-style-type: none"> • No requirements • As per Package A 'Side On' • As per Package A 'Facing' 	<ul style="list-style-type: none"> • No requirements • As per Package A 'Side On' • As per Package A 'Facing'
INDOOR LIVING AND WORK AREAS	FACING	<ul style="list-style-type: none"> • Walls to R_w+C_r 45dB • Windows and external door systems: Minimum R_w+C_r 25dB (Table 6.4), total glazing area limited to 40% of room floor area. [if R_w+C_r 28dB: 60%] [if R_w+C_r 31dB: 80%] • External doors other than glass doors to R_w+C_r 26dB (Table 6.4) • Mechanical ventilation as per Section 6.3.1 	<ul style="list-style-type: none"> • Walls to R_w+C_r 50dB • Windows and external door systems: Minimum R_w+C_r 28dB (Table 6.4), total glazing area up to 40% of room floor area. [if R_w+C_r 31dB: 60%] [if R_w+C_r 34dB: 80%] • External doors other than glass doors to R_w+C_r 26dB (Table 6.4) • Mechanical ventilation as per Section 6.3.1
	SIDE-ON	• As above, except the glazing R _w +C _r values for each package may be 3dB less, or max % area increased by 20%	
	OPPOSITE	• No requirements	• As per Package A 'Side On'
OTHER INDOOR AREAS	ANY	• No requirements	• No requirements
OUTDOOR LIVING AREAS	ANY (SECTION 6.2.3)	<ul style="list-style-type: none"> • At least one outdoor living area located on the opposite side of the building from the transport corridor, and/or • At least one ground level outdoor living area screened using a solid continuous fence or other structure of minimum 2 metres height above ground level 	<ul style="list-style-type: none"> • At least one outdoor living area located on the opposite side of the building from the transport corridor, and/or • At least one ground level outdoor living area screened using a solid continuous fence or other structure of minimum 2.4 metres height above ground level