

LOCAL DEVELOPMENT PLAN FOR LOT 9001 (No. 244) BADGERUP ROAD, GNANGARA

The provisions of the City of Wanneroo District Planning Scheme No. 2 apply unless otherwise varied below.

Building Envelopes

A cleared building envelope measuring no more than 1600m² shall be permitted on each lot as shown on the Local Development Plan. The clearing of trees and native vegetation outside of the building envelope is prohibited other than for fences, fire breaks, access and servicing. The position of the building envelope shown on each lot may be varied subject to Council approval.

Approval

This Local Development Plan has been approved by Council under Clause 52(1)(a) of the Deemed Provisions of District Planning Scheme No. 2.

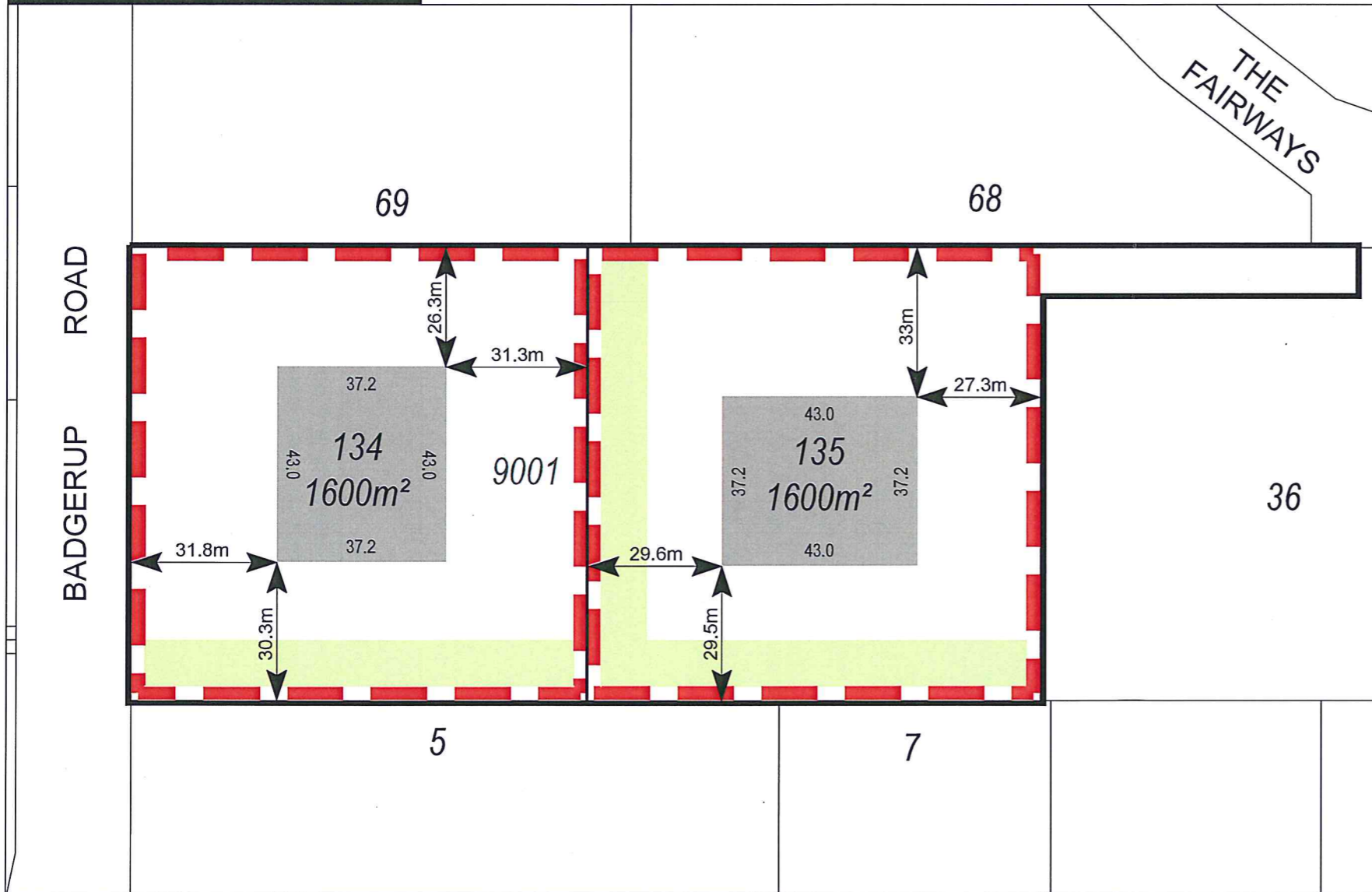
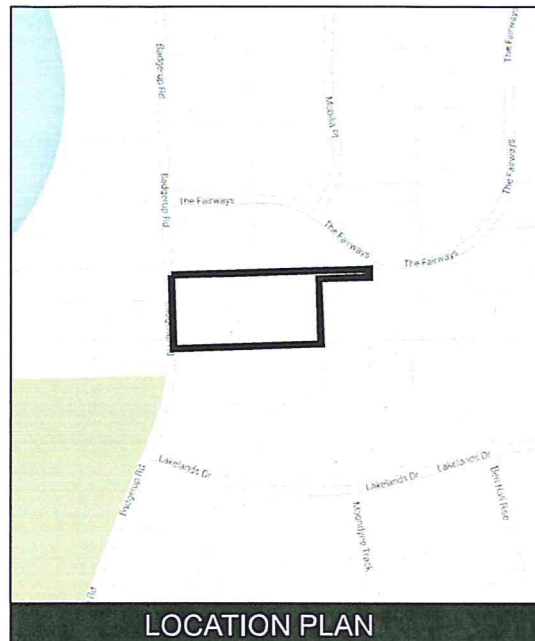

[Signature]
 Manager, Approval Services

22/4/16
 Date

LEGEND

- Local Development Plan Area
- Building Envelope
- Revegetated Buffer / Corridor Area
- 3m Fire Break

<p>LOCAL DEVELOPMENT PLAN No. 1 LOT 9001 (No. 244) BADGERUP ROAD GNANGARA City of Wanneroo</p>	<p>SCALE: 1:1250 @ A3 DATE: 21st APRIL 2016 FILE: 503_21.04.2016.dwg DRAW: - SB CHECKED: -</p>	<p>e: admin@dynamicplanning.net.au t: (08) 9271 1700 f: (08) 9281 1744 m: 0431-111-659 PO Box 688 INGLEWOOD WA 6932 UNIT 2C, 953 BEAUFORT STREET INGLEWOOD WA 6052</p> <p>DYNAMIC PLANNING AND DEVELOPMENTS</p> <p><small>DISCLAIMER: This document is and remains the property of Dynamic Planning and Developments and may not be copied in whole or in part without the written consent of Dynamic Planning and Developments. All areas, distances and angles are approximate only and are subject to survey.</small></p>	
--	--	--	--