PLAN
SCALE 1:1000PLAN
SCALE 1:1000

LEGEND:

	KERBING
	TEMPORARY KERBING (SEM-MOUNTABLE)
	PAVEMENT EDGE
	RED ASPHALT SURFACE
	NEW ROAD PAVEMENT (40mm INTERSECTION MIX)
	NEW ROAD PAVEMENT (30mm MIX)
	ASPHALT RESURFACING WITH CORRECTING LAYER (30mm MIX)
	RED ASPHALT (SHARED PATH MIX)
	CONCRETE PATH (100mm THICK)
	BRICK PAVING - REFER CONSTRUCTION SPEC.
	JUTE MATTING (SOIL STABILISATION)

BRICK PAVING TABLE

BRICK TYPE	LOCATIONS
BORAL 80mm INTERLOCKING ANTIQUE BLEND	INTERSECTIONS, CARPARKING BAYS, FLUSH KERBED MEDIANS, DRIVEWAYS AND ROUNDABOUT ISLANDS.
BORAL 60mm RECTANGULAR DONNYBROOK	SPLITTER ISLANDS, SEMI-MOUNTABLE ISLANDS AND NON-TRAFFICABLE VERGES

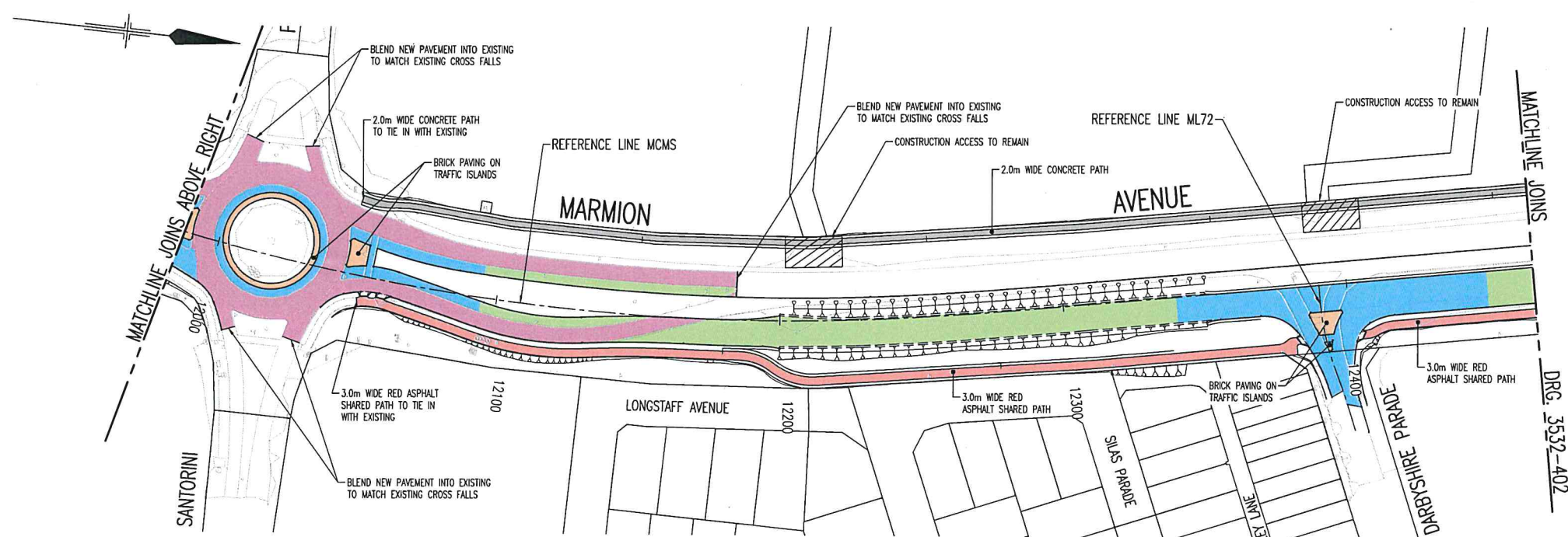

WARNING

SERVICES AND CADASTRAL BOUNDARY LOCATIONS SHOWN ARE ONLY INDICATIVE AND MUST NOT BE USED FOR EXCAVATION. THE "ONE CALL 1100" SYSTEM SHALL BE USED TO OBTAIN ACCURATE SERVICE LOCATIONS.

NOTES:

- CADASTRAL INFORMATION APPROXIMATE ONLY.
- DRAWING SHALL BE PRINTED IN COLOUR FOR PROPER VIEWING.

DESIGNED: V. SINAGRA / S. GILLESPIE CONSULTANT: (GHD)	CHECKED: L. HAINS / S. WILSON CONSULTANT: (GHD)
DRAWN: C. PISAWIS CONSULTANT: (GHD)	APPROVED: S.T. TAN CONSULTANT: (GHD)



Level 10, 999 Hay Street Perth WA 6000
PO Box Y3106 Perth WA 6832 Australia
T 61 8 6222 8222 F 61 8 6222 8555
E permail@ghd.com.au W www.ghd.com



CITY OF WANNEROO
ASSETS

MARMION AVENUE (002)

CAMBORNE PARKWAY (4772) TO YANCHEP BEACH ROAD (454)
ULTIMATE DUAL CARRIAGEWAY - STAGE 2
REFERENCE LINE MCMS

PAVEMENT PLAN
SHEET 1 OF 3

DRAWING No. SHEET REVISION ORIGINAL DRG. SIZE

3532-401-0 A1

No.					REVISION					BY					DATE					AUTH					No.					REVISION					BY					DATE					AUTH					SCALE: 10 0 10 20 30 40 50					SURVEYED: GHD					CHECKED: L. HAINS/S. WILSON					RECOMMENDED: P. TOMSETT					FINANCE CODE: PR-4140					PMO No. -					DRAWING No. 3532-401-0					SHEET					REVISION					ORIGINAL Dwg. SIZE: A1																																																																																																																																																																																																																																																																																																																																																																																																																																																																																																																																																																																																																																																																																																																																																																																																																																																																																																																																																																																																																																																																																																																																																																																																																																																																																																																																																																																																																																																																																																																																																																																																																																																																																																																																																																																																																																																																																																																																																																																																																																																																																																																																																																																																																																																																																																																																																																																																																																																																																																																																																																																																																																																																																																																																																																													
A					ISSUED FOR TENDER					CP					21/12/18					STI															1:1000					06/03/2018					CONSULTANT: GHD					PROJECT MANAGER MAJOR WORKS																																																																																																																																																																																																																																																																																																																																																																																																																																																																																																																																																																																																																																																																																																																																																																																																																																																																																																																																																																																																																																																																																																																																																																																																																																																																																																																																																																																																																																																																																																																																																																																																																																																																																																																																																																																																																																																																																																																																																																																																																																																																																																																																																																																																																																																																																																																																																																																																																																																																																																																																																																																																																																																																																																																																																																																																																										

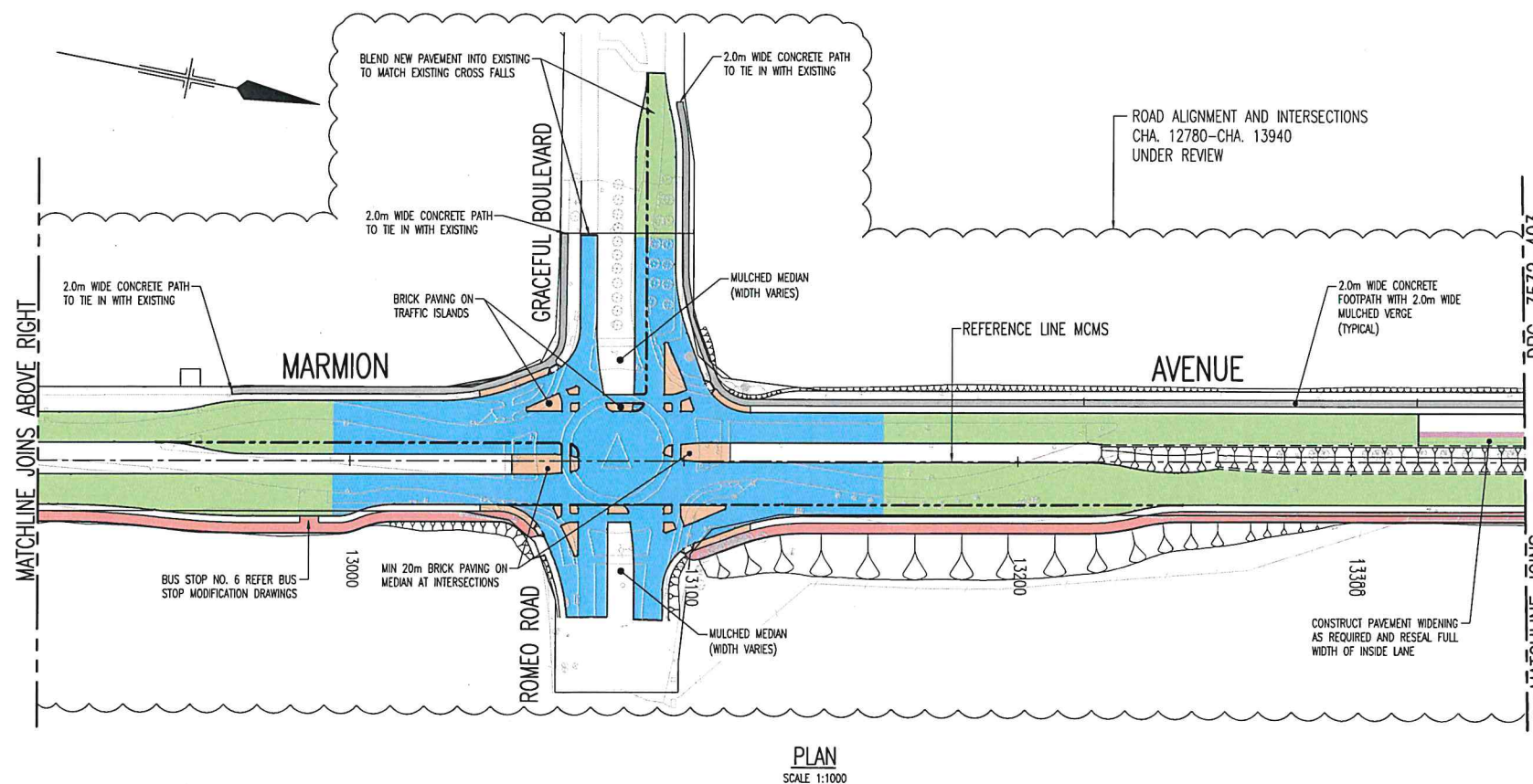
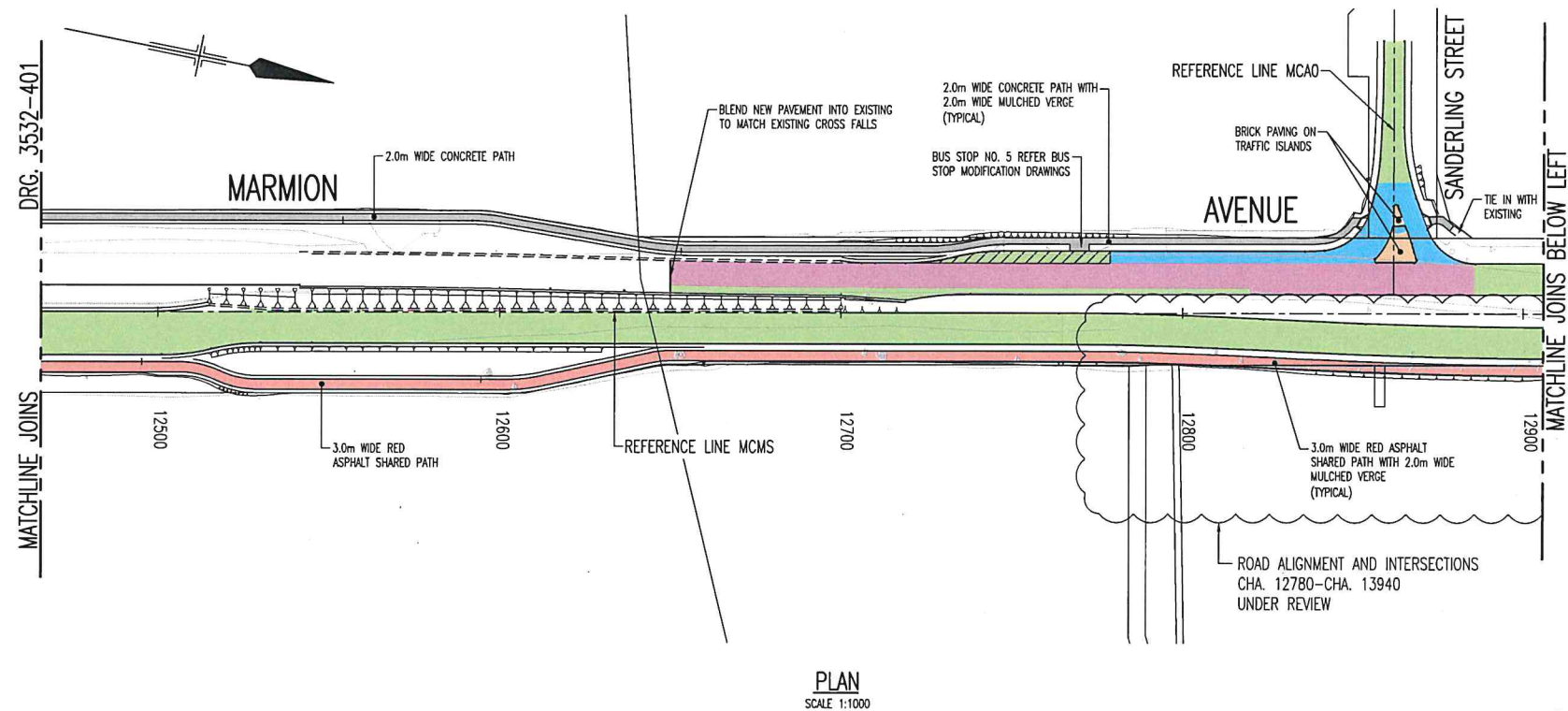

LEGEND:

	KERBING
	TEMPORARY KERBING (SEMI-MOUNTABLE)
	PAVEMENT EDGE
	RED ASPHALT SURFACE
	NEW ROAD PAVEMENT (40mm INTERSECTION MIX)
	NEW ROAD PAVEMENT (30mm MIX)
	ASPHALT RESURFACING WITH CORRECTING LAYER (30mm MIX)
	RED ASPHALT (SHARED PATH MIX)
	CONCRETE PATH (100mm THICK)
	BRICK PAVING - REFER CONSTRUCTION SPEC.
	JUTE MATTING (SOIL STABILISATION)

BRICK PAVING TABLE	
BRICK TYPE	LOCATIONS
BORAL 60mm INTERLOCKING ANTIQUE BLEND	INTERSECTIONS, CARPARKING BAYS, FLUSH KERBED MEDIANS, DRIVEWAYS AND ROUNDABOUT ISLANDS.
BORAL 60mm RECTANGULAR DORNBROOK	SPLITTER ISLANDS, SEMI-MOUNTABLE ISLANDS AND NON-TRAFFICABLE VERGES



WARNING
SERVICES AND CADASTRAL BOUNDARY LOCATIONS SHOWN ARE ONLY INDICATIVE AND MUST NOT BE USED FOR EXCAVATION. THE "ONE CALL 1100" SYSTEM SHALL BE USED TO OBTAIN ACCURATE SERVICE LOCATIONS.

NOTES:

- CADASTRAL INFORMATION APPROXIMATE ONLY.
- DRAWING SHALL BE PRINTED IN COLOUR FOR PROPER VIEWING.

DESIGNED: V. SINAGRA / S. GILLESPIE CONSULTANT: (GHD)	CHECKED: L. HAINS / S. WILSON CONSULTANT: (GHD)
DRAWN: C. PISAWIS CONSULTANT: (GHD)	APPROVED: S.T. TAN CONSULTANT: (GHD)



Level 10, 999 Hay Street Perth WA 6000
PO Box Y3106 Perth WA 6832 Australia
T 61 8 6222 8222 F 61 8 6222 8555
E permail@ghd.com.au W www.ghd.com



CITY OF WANNEROO
ASSETS

MARMION AVENUE (002)
CAMBORNE PARKWAY (4772) TO YANCHEP BEACH ROAD (454)
ULTIMATE DUAL CARRIAGEWAY - STAGE 2
REFERENCE LINE MCMS

PAVEMENT PLAN
SHEET 2 OF 3

DRAWING No. SHEET REVISION ORIGINAL DRG. SIZE
3532-402-0 **A1**

No.	REVISION	BY	DATE	AUTH	No.	REVISION	BY	DATE	AUTH	SCALE:	10 0 10 20 30 40 50	SCALE IN METRES	DATE:	GRD:	PCG 94	DESIGNED:	CHECKED:	RECOMMENDED:	FINANCE CODE	PAID No.	PAID CONTAINER No.	ORIGINAL DRG. SIZE
A	ISSUED FOR TENDER	CP	21/12/18	STI						1:1000							L. HAINS / S. WILSON	P. TOMSETT	PR-4140			
Q	ISSUED FOR CONSTRUCTION	GC	21/03/19	STI						AHD 71							J. DUFF	H. SINGH		31839		

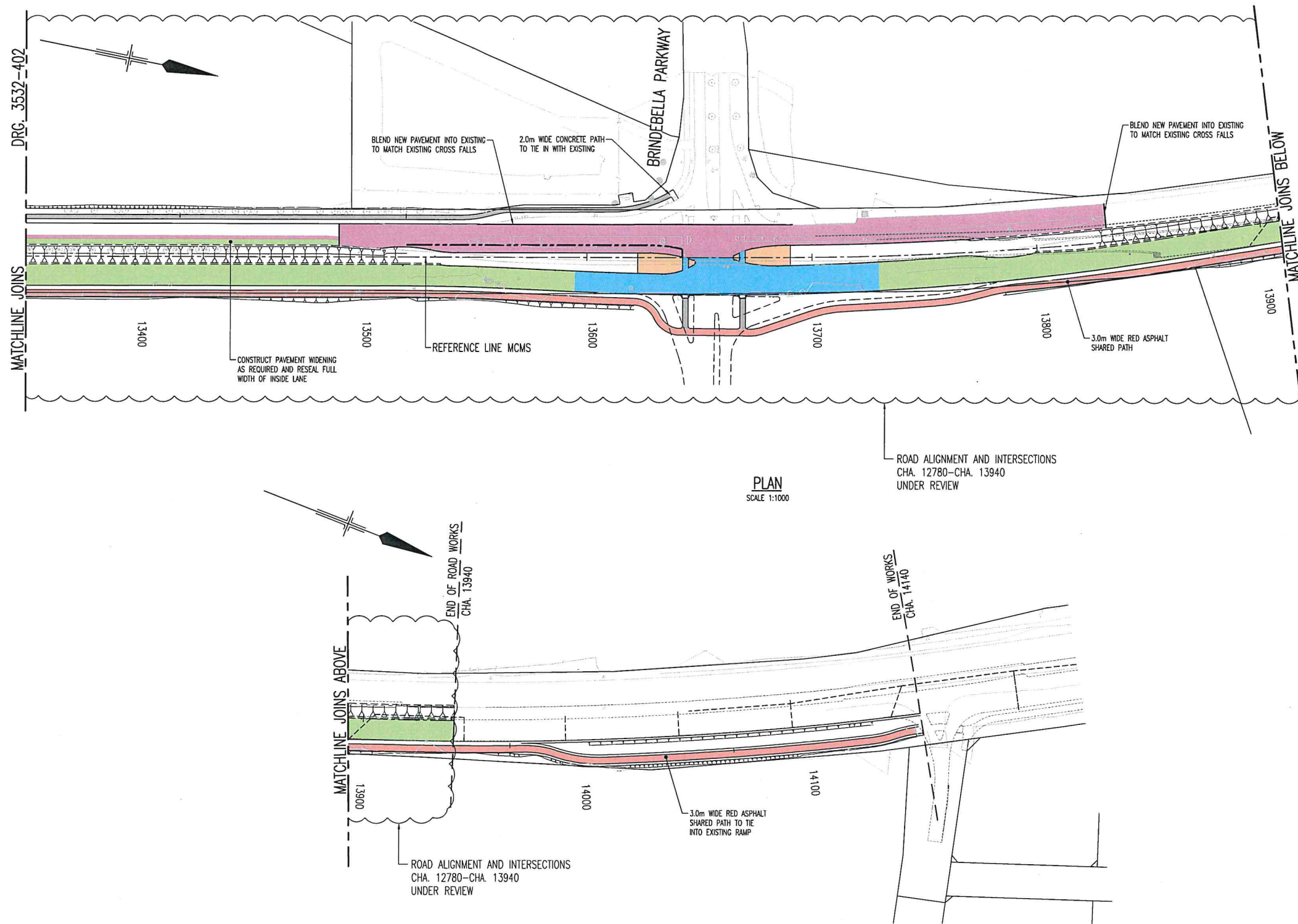

LEGEND:

	KERBING
	TEMPORARY KERBING (SEMI-MOUNTABLE)
	PAVEMENT EDGE
	RED ASPHALT SURFACE
	NEW ROAD PAVEMENT (40mm INTERSECTION MIX)
	NEW ROAD PAVEMENT (30mm MIX)
	ASPHALT RESURFACING WITH CORRECTING LAYER (30mm MIX)
	RED ASPHALT (SHARED PATH MIX)
	CONCRETE PATH (100mm THICK)
	BRICK PAVING - REFER CONSTRUCTION SPEC.
	JUTE MATTING (SOIL STABILISATION)

BRICK PAVING TABLE

BRICK TYPE	LOCATIONS
BORAL 80mm INTERLOCKING ANTIQUE BLEND	INTERSECTIONS, CARPARKING BAYS, FLUSH KERBED MEDIANS, DRIVEWAYS AND ROUNDABOUT ISLANDS.
BORAL 60mm RECTANGULAR DORNYBROOK	SPLITTER ISLANDS, SEMI-MOUNTABLE ISLANDS AND NON-TRAFFICABLE VERGES



WARNING
SERVICES AND CADASTRAL BOUNDARY LOCATIONS SHOWN ARE ONLY INDICATIVE AND MUST NOT BE USED FOR EXCAVATION. THE "ONE CALL 1100" SYSTEM SHALL BE USED TO OBTAIN ACCURATE SERVICE LOCATIONS.

NOTES:

- CADASTRAL INFORMATION APPROXIMATE ONLY.
- DRAWING SHALL BE PRINTED IN COLOUR FOR PROPER VIEWING.

DESIGNED: V. SINAGRA / S. GILLESPIE CONSULTANT: (GHD)	CHECKED: L. HAINS / S. WILSON CONSULTANT: (GHD)
DRAWN: C. PISAWIS CONSULTANT: (GHD)	APPROVED: S.T. TAN CONSULTANT: (GHD)



Level 10, 999 Hay Street Perth WA 6000
PO Box Y3106 Perth WA 6832 Australia
T 61 8 6222 8222 F 61 8 6222 8555
E permail@ghd.com.au W www.ghd.com



**CITY OF WANNEROO
ASSETS**

MARMION AVENUE (002)
CAMBORNE PARKWAY (4772) TO YANCHEP BEACH ROAD (454)
ULTIMATE DUAL CARRIAGEWAY - STAGE 2
REFERENCE LINE MCMS

PAVEMENT PLAN
SHEET 3 OF 3

DRAWING No. SHEET REVISION ORIGINAL DRG. SIZE
3532-403-0 **A1**

No.	REVISION	BY	DATE	AUTH	No.	REVISION	BY	DATE	AUTH	SCALE	10 0 10 20 30 40 50	SCALE IN METRES	DATE	GRD.	PCG 94	DESIGNED: GHD CIVIL DESIGNER	CHECKED: L. HAINS / S. WILSON CONSULTANT: GHD	RECOMMENDED: P. TOMSETT PROJECT MANAGER MAJOR WORKS	FINANCE CODE PR-4140	PMO No. -	PMO CONTAINER No. 31839
A	ISSUED FOR TENDER	CP	21/12/14	STI						1:1000							06/03/2018				
D	ISSUED FOR CONSTRUCTION	GC	21/03/19	STI						AHD 71							11/06/2018	J. DUFF OPERATIONS MANAGER ASSETS OPERATIONS & SERVICES	H. SINGH DIRECTOR ASSETS		

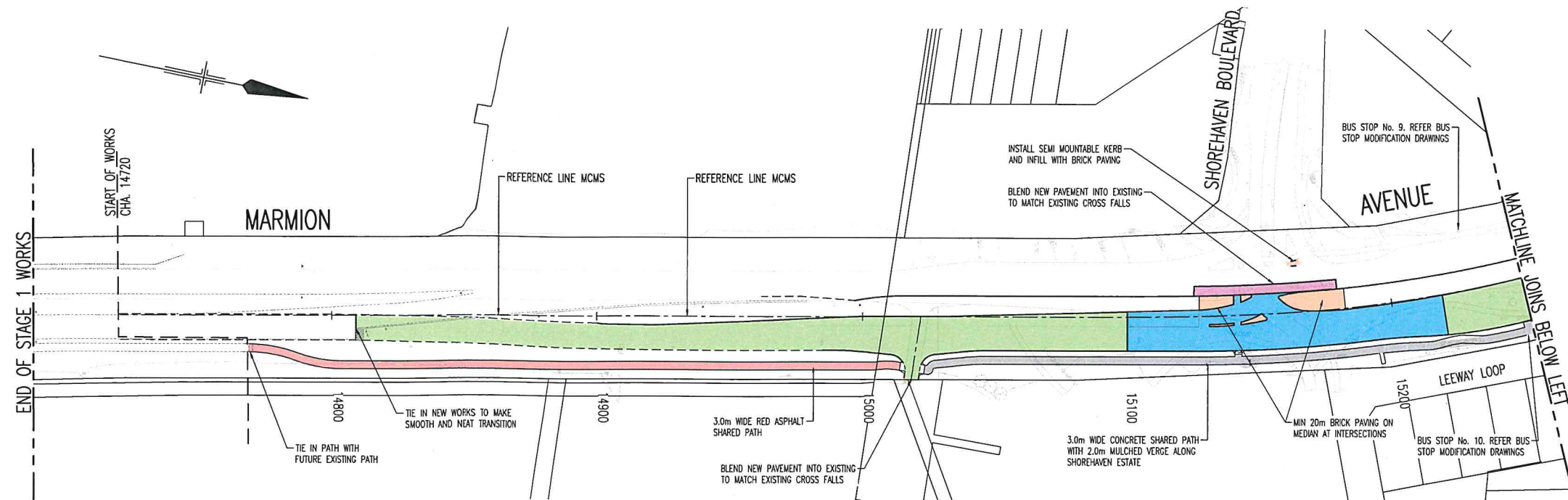

PLAN
SCALE 1:1000

LEGEND:

	KERBING
	PAVEMENT EDGE
	NEW ROAD PAVEMENT (40mm INTERSECTION MIX)
	NEW ROAD PAVEMENT (30mm MIX)
	ASPHALT RESURFACING WITH CORRECTING LAYER (30mm MIX)
	RED ASPHALT (SHARED PATH MIX)
	CONCRETE PATH (100mm THICK)
	BRICK PAVING - REFER CONSTRUCTION SPEC.
	JUTE MATTING (SOIL STABILISATION)

BRICK PAVING TABLE	
BRICK TYPE	LOCATIONS
BORAL 60mm INTERLOCKING ANTIQUE BLEND	INTERSECTIONS, CARPARKING BAYS, FLUSH KERBED MEDIANS, DRIVEWAYS AND ROUNDABOUT ISLANDS.
BORAL 60mm RECTANGULAR DOWNYBROOK	SPLITTER ISLANDS, SEMI-MOUNTABLE ISLANDS AND NON-TRAFFICABLE VERGES



WARNING
SERVICES AND CADASTRAL BOUNDARY LOCATIONS SHOWN ARE ONLY INDICATIVE AND MUST NOT BE USED FOR EXCAVATION. THE "ONE CALL 1100" SYSTEM SHALL BE USED TO OBTAIN ACCURATE SERVICE LOCATIONS.

NOTES:

- CADASTRAL INFORMATION APPROXIMATE ONLY.
- DRAWING SHALL BE PRINTED IN COLOUR FOR PROPER VIEWING.
- ALL DRAWINGS SHALL BE READ IN CONJUNCTION WITH THE CONSTRUCTION SPECIFICATION.

DESIGNED: X.XXXXXX / S. GILLESPIE CONSULTANT: (GHD)	CHECKED: X.XXXXXX CONSULTANT: (GHD)
DRAWN: X.XXXXXX CONSULTANT: (GHD)	APPROVED: X.XXXXXX CONSULTANT: (GHD)

GHD
Level 10, 999 Hay Street Perth WA 6000
PO Box Y3106 Perth WA 6832 Australia
T 61 8 6222 8222 F 61 8 6222 8555
E permail@ghd.com.au W www.ghd.com

CITY OF WANNEROO
ASSETS

MARMION AVENUE (002)
CAMBORNE PARKWAY (4772) TO YANCHEP BEACH ROAD (454)
ULTIMATE DUAL CARRIAGEWAY - STAGE 1
REFERENCE LINE MCMS





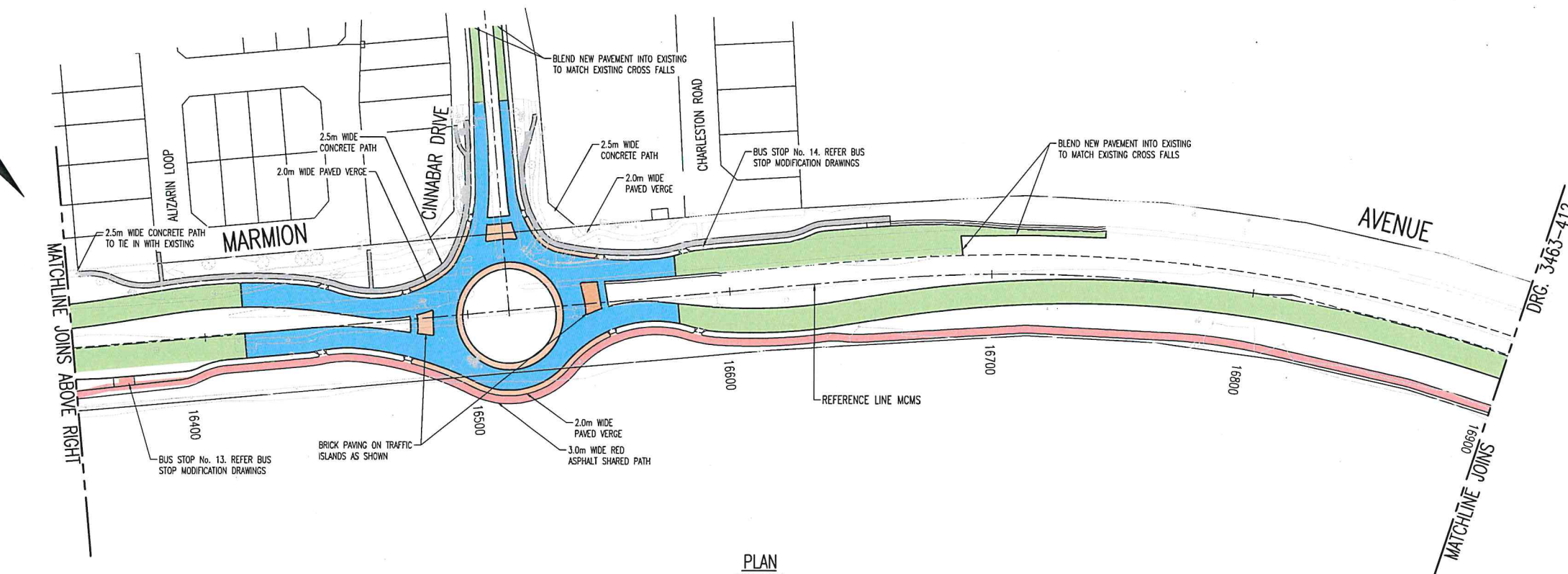

PAVEMENT PLAN
SHEET 1 OF 8

DRAWING No. SHEET REVISION ORIGINAL DRG. SIZE
3463-410-B A1

PRELIMINARY
DATE : 18 October 2018

No.	REVISION	BY	DATE	AUTH	No.	REVISION	BY	DATE	AUTH	SCALE	10 0 10 20 30 40 50	SURVEYED: GHD DATE: 09/03/2018	CHECKED: X.XXXXXX CONSULTANT: GHD	RECOMMENDED: PROJECT MANAGER MAJOR WORKS	FINANCE CODE PR-4140	PAID No.
A	ISSUED FOR ASSESS DESIGN REVIEW	SW	30/07/18	STI						1:1000	SCALE IN METRES	DESIGNED: X.XXXXXX CIVIL DESIGNER	ENDORSED: X.XXXXXX MANAGER INFRASTRUCTURE PROJECTS	APPROVED: MANAGER INFRASTRUCTURE PROJECTS	DRAWING SET REF	PAID CONTAINER No. 31839
B	ISSUED FOR TENDER	CP	26/10/18	STI						AHD 71	PGC 94					

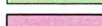
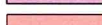

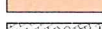
	KERBING
	PAVEMENT EDGE
	NEW ROAD PAVEMENT (40mm INTERSECTION MIX)
	NEW ROAD PAVEMENT (30mm MIX)
	ASPHALT RESURFACING WITH CORRECTING LAYER (30mm MIX)
	RED ASPHALT (SHARED PATH MIX)
	CONCRETE PATH (100mm THICK)
	BRICK PAVING – REFER CONSTRUCTION SPEC.
	JUTE MATTING (SOIL STABILISATION)

BRICK PAVING TABLE	
BRICK TYPE	LOCATIONS
BORAL 80mm INTERLOCKING ANTIQUE BLEND	INTERSECTIONS, CARPARKING BAYS, FLUSH KERBED MEDIANS, DRIVEWAYS AND ROUNDABOUT ISLANDS.
BORAL 60mm RECTANGULAR DONNYBROOK	SPLITTER ISLANDS, SEMI-MOUNTABLE ISLANDS AND NON-TRAFFICABLE VERGE



WARNING
SERVICES AND CADASTRAL BOUNDARY
LOCATIONS SHOWN ARE ONLY INDICATIVE AND
MUST NOT BE USED FOR EXCAVATION.
THE "ONE CALL 1100" SYSTEM SHALL BE USED
TO OBTAIN ACCURATE SERVICE LOCATIONS.

1. CADASTRAL INFORMATION APPROXIMATE ONLY.
2. DRAWING SHALL BE PRINTED IN COLOUR FOR PROPER VIEWING.
3. ALL DRAWINGS SHALL BE READ IN CONJUNCTION WITH THE CONSTRUCTION SPECIFICATION.

DESIGNED: <i>V. SINAGRA / S. GILLESPIE</i>	CHECKED:
CONSULTANT: (GHD)	CONSULTANT: (GHD)
DRAWN: <i>J. SCHMECHTIG</i>	APPROVED:
CONSULTANT: (GHD)	CONSULTANT: (GHD)



Level 10, 999 Hay Street Perth WA 6000
PO Box Y3106 Perth WA 6832 Australia
T 61 8 6222 8222 F 61 8 6222 8555
E permail@ghd.com.au W www.ghd.com



CITY OF WANNEROO ASSETS

MARMION AVENUE (002)
CAMBORNE PARKWAY (4772) TO YANCHEP BEACH ROAD (454)
ULTIMATE DUAL CARRIAGEWAY - STAGE 1
REFERENCE LINE MCMS

PAVEMENT PLAN
SHEET 2 OF 8

DRAWING No.	SHEET	REVISION	ORIGINAL DRG. SIZE
3463-411-B			A1

PRELIMINARY
DATE : 18 October 2018

REVISION										REVISION										DATE : 10 OCTOBER 2019										SHEET 2 OF 6																																																																																																																																																																																																																																																																																																																																																																																																																																																																																																																																																																																																																																																																																																																																																																																																																																																																																																																																																																																																																																																																	
No.		BY	DATE	AUTH	No.		BY	DATE	AUTH	No.		BY	DATE	AUTH	No.		BY	DATE	AUTH	No.		BY	DATE	AUTH	No.		BY	DATE	AUTH	No.		BY	DATE	AUTH	No.		BY	DATE	AUTH	No.		BY	DATE	AUTH	No.		BY	DATE	AUTH	No.		BY	DATE	AUTH	No.		BY	DATE	AUTH	No.		BY	DATE	AUTH	No.		BY	DATE	AUTH	No.		BY	DATE	AUTH	No.		BY	DATE	AUTH	No.		BY	DATE	AUTH	No.		BY	DATE	AUTH	No.		BY	DATE	AUTH	No.		BY	DATE	AUTH	No.		BY	DATE	AUTH	No.		BY	DATE	AUTH	No.		BY	DATE	AUTH	No.		BY	DATE	AUTH	No.		BY	DATE	AUTH	No.		BY	DATE	AUTH	No.		BY	DATE	AUTH	No.		BY	DATE	AUTH	No.		BY	DATE	AUTH	No.		BY	DATE	AUTH	No.		BY	DATE	AUTH	No.		BY	DATE	AUTH	No.		BY	DATE	AUTH	No.		BY	DATE	AUTH	No.		BY	DATE	AUTH	No.		BY	DATE	AUTH	No.		BY	DATE	AUTH	No.		BY	DATE	AUTH	No.		BY	DATE	AUTH	No.		BY	DATE	AUTH	No.		BY	DATE	AUTH	No.		BY	DATE	AUTH	No.		BY	DATE	AUTH	No.		BY	DATE	AUTH	No.		BY	DATE	AUTH	No.		BY	DATE	AUTH	No.		BY	DATE	AUTH	No.		BY	DATE	AUTH	No.		BY	DATE	AUTH	No.		BY	DATE	AUTH	No.		BY	DATE	AUTH	No.		BY	DATE	AUTH	No.		BY	DATE	AUTH	No.		BY	DATE	AUTH	No.		BY	DATE	AUTH	No.		BY	DATE	AUTH	No.		BY	DATE	AUTH	No.		BY	DATE	AUTH	No.		BY	DATE	AUTH	No.		BY	DATE	AUTH	No.		BY	DATE	AUTH	No.		BY	DATE	AUTH	No.		BY	DATE	AUTH	No.		BY	DATE	AUTH	No.		BY	DATE	AUTH	No.		BY	DATE	AUTH	No.		BY	DATE	AUTH	No.		BY	DATE	AUTH	No.		BY	DATE	AUTH	No.		BY	DATE	AUTH	No.		BY	DATE	AUTH	No.		BY	DATE	AUTH	No.		BY	DATE	AUTH	No.		BY	DATE	AUTH	No.		BY	DATE	AUTH	No.		BY	DATE	AUTH	No.		BY	DATE	AUTH	No.		BY	DATE	AUTH	No.		BY	DATE	AUTH	No.		BY	DATE	AUTH	No.		BY	DATE	AUTH	No.		BY	DATE	AUTH	No.		BY	DATE	AUTH	No.		BY	DATE	AUTH	No.		BY	DATE	AUTH	No.		BY	DATE	AUTH	No.		BY	DATE	AUTH	No.		BY	DATE	AUTH	No.		BY	DATE	AUTH	No.		BY	DATE	AUTH	No.		BY	DATE	AUTH	No.		BY	DATE	AUTH	No.		BY	DATE	AUTH	No.		BY	DATE	AUTH	No.		BY	DATE	AUTH	No.		BY	DATE	AUTH	No.		BY	DATE	AUTH	No.		BY	DATE	AUTH	No.		BY	DATE	AUTH	No.		BY	DATE	AUTH	No.		BY	DATE	AUTH	No.		BY	DATE	AUTH	No.		BY	DATE	AUTH	No.		BY	DATE	AUTH	No.		BY	DATE	AUTH	No.		BY	DATE	AUTH	No.		BY	DATE	AUTH	No.		BY	DATE	AUTH	No.		BY	DATE	AUTH	No.		BY	DATE	AUTH	No.		BY	DATE	AUTH	No.		BY	DATE	AUTH	No.		BY	DATE	AUTH	No.		BY	DATE	AUTH	No.		BY	DATE	AUTH	No.		BY	DATE	AUTH	No.		BY	DATE	AUTH	No.		BY	DATE	AUTH	No.		BY	DATE	AUTH	No.		BY	DATE	AUTH	No.		BY	DATE	AUTH	No.		BY	DATE	AUTH	No.		BY	DATE	AUTH	No.		BY	DATE	AUTH	No.		BY	DATE	AUTH	No.		BY	DATE	AUTH	No.		BY	DATE	AUTH	No.		BY	DATE	AUTH	No.		BY	DATE	AUTH	No.		BY	DATE	AUTH	No.		BY	DATE	AUTH	No.		BY	DATE	AUTH	No.		BY	DATE	AUTH	No.		BY	DATE	AUTH	No.		BY	DATE	AUTH	No.		BY	DATE	AUTH	No.		BY	DATE	AUTH	No.		BY	DATE	AUTH	No.		BY	DATE	AUTH	No.		BY	DATE	AUTH	No.		BY	DATE	AUTH	No.		BY	DATE	AUTH	No.		BY	DATE	AUTH	No.		BY	DATE	AUTH	No.		BY	DATE	AUTH	No.		BY	DATE	AUTH	No.		BY	DATE	AUTH	No.		BY	DATE	AUTH	No.		BY	DATE	AUTH	No.		BY	DATE	AUTH	No.		BY	DATE	AUTH	No.		BY	DATE	AUTH	No.		BY	DATE	AUTH	No.		BY	DATE	AUTH	No.		BY	DATE	AUTH	No.		BY	DATE	AUTH	No.		BY	DATE	AUTH	No.		BY	DATE	AUTH	No.		BY	DATE	AUTH	No.		BY	DATE	AUTH	No.		BY	DATE	AUTH	No.		BY	DATE	AUTH	No.		BY	DATE	AUTH	No.		BY	DATE	AUTH	No.		BY	DATE	AUTH	No.		BY	DATE	AUTH	No.		BY	DATE	AUTH	No.		BY	DATE	AUTH	No.		BY	DATE	AUTH	No.		BY	DATE	AUTH	No.		BY	DATE	AUTH	No.		BY	DATE	AUTH	No.		BY	DATE	AUTH	No.		BY	DATE	AUTH	No.		BY	DATE	AUTH	No.		BY	DATE	AUTH	No.		BY	DATE	AUTH	No.		BY	DATE	AUTH	No.		BY	DATE	AUTH	No.		BY	DATE	AUTH	No.		BY	DATE	AUTH	No.		BY	DATE	AUTH	No.		BY	DATE	AUTH	No.		BY	DATE	AUTH	No.		BY	DATE	AUTH	No.		BY	DATE	AUTH	No.		BY	DATE	AUTH	No.		BY	DATE	AUTH	No.		BY	DATE	AUTH	No.		BY	DATE	AUTH	No.		BY	DATE	AUTH	No.		BY	DATE	AUTH	No.		BY	DATE	AUTH	No.		BY	DATE	AUTH	No.		BY	DATE	AUTH	No.		BY	DATE	AUTH	No.		BY	DATE	AUTH	No.		BY	DATE	AUTH	No.		BY	DATE	AUTH	No.		BY	DATE	AUTH	No.		BY	DATE	AUTH	No.		BY	DATE	AUTH	No.		BY	DATE	AUTH	No.		BY	DATE	AUTH	No.		BY	DATE	AUTH	No.		BY	DATE	AUTH	No.		BY	DATE	AUTH	No.		BY	DATE	AUTH	No.		BY	DATE	AUTH	No.		BY	DATE	AUTH	No.		BY	DATE	AUTH	No.</

LEGEND:

	KERBING
	PAVEMENT EDGE
	NEW ROAD PAVEMENT (40mm INTERSECTION MIX)
	NEW ROAD PAVEMENT (30mm MIX)
	ASPHALT RESURFACING WITH CORRECTING LAYER (30mm MIX)
	RED ASPHALT (SHARED PATH MIX)
	CONCRETE PATH (100mm THICK)
	BRICK PAVING - REFER CONSTRUCTION SPEC.
	JUTE MATTING (SOIL STABILISATION)

BRICK PAVING TABLE	
BRICK TYPE	LOCATIONS
BORAL 60mm INTERLOCKING ANTIQUE BLEND	INTERSECTIONS, CARPARKING BAYS, FLUSH KERBED MEDIANS, DRIVEWAYS AND ROUNDABOUT ISLANDS.
BORAL 60mm RECTANGULAR DOWNYBROOK	SPLITTER ISLANDS, SEMI-MOUNTABLE ISLANDS AND NON-TRAFFICABLE VERGES



WARNING
SERVICES AND CADASTRAL BOUNDARY LOCATIONS SHOWN ARE ONLY INDICATIVE AND MUST NOT BE USED FOR EXCAVATION. THE "ONE CALL 1100" SYSTEM SHALL BE USED TO OBTAIN ACCURATE SERVICE LOCATIONS.

NOTES:

- CADASTRAL INFORMATION APPROXIMATE ONLY.
- DRAWING SHALL BE PRINTED IN COLOUR FOR PROPER VIEWING.
- ALL DRAWINGS SHALL BE READ IN CONJUNCTION WITH THE CONSTRUCTION SPECIFICATION.

DESIGNED: V. SHAGRA / S. GILLESPIE CONSULTANT: (GHD)	CHECKED: CONSULTANT: (GHD)
DRAWN: J. SCHMECHTIG CONSULTANT: (GHD)	APPROVED: CONSULTANT: (GHD)



Level 10, 999 Hay Street Perth WA 6000
PO Box Y3106 Perth WA 6832 Australia
T 61 8 6222 8222 F 61 8 6222 8555
E permail@ghd.com.au W www.ghd.com



CITY OF WANNEROO
ASSETS

MARMION AVENUE (002)
CAMBORNE PARKWAY (4772) TO YANCHEP BEACH ROAD (454)
ULTIMATE DUAL CARRIAGEWAY - STAGE 1
REFERENCE LINE MCMS

PAVEMENT PLAN
SHEET 3 OF 8

DRAWING No. SHEET REVISION ORIGINAL Dwg. SIZE
3463-412-B **A1**

PRELIMINARY
DATE : 18 October 2018

No.	REVISION	BY	DATE	AUTH	No.	REVISION	BY	DATE	AUTH	SCALE	10 0 10 20 30 40 50	SURVEYED: GHD DATE: 06/03/2018	CHECKED: CONSULTANT: GHD	RECOMMENDED: PROJECT MANAGER: WAJOR WORKS	FINANCE CODE PR-4140	PMO No. -
A	ISSUED FOR ASSESSMENT REVIEW	SW	30/07/18	ST						1:1000	SCALE IN METRES	DESIGNED: GHD DATE: 11/06/2018	ENDORSED: MANAGER INFRASTRUCTURE PROJECTS	APPROVED: DIRECTOR ASSETS	DRAWING SET REF -	PMO CONTAINER No. 31839
B	ISSUED FOR TENDER	CP	26/10/18	ST						AHD 71	PGC 94					

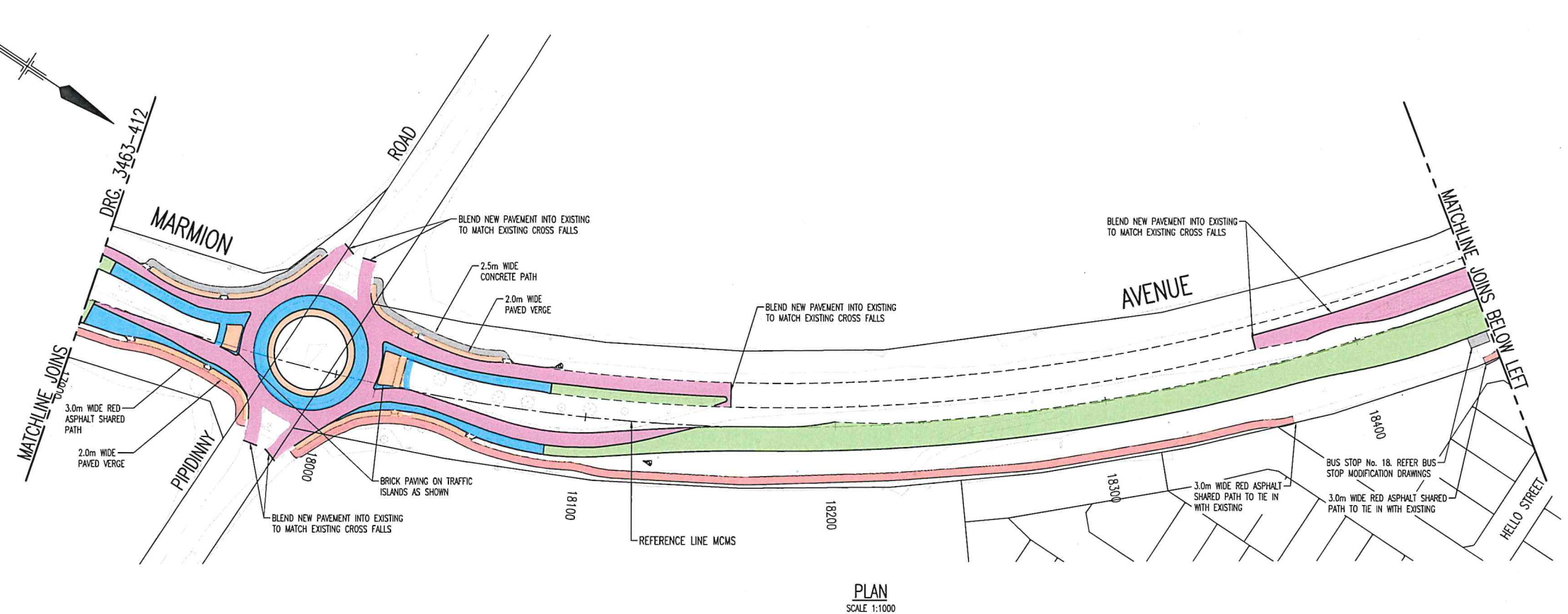

LEGEND:

	KERBING
	PAVEMENT EDGE
	NEW ROAD PAVEMENT (40mm INTERSECTION MIX)
	NEW ROAD PAVEMENT (30mm MIX)
	ASPHALT RESURFACING WITH CORRECTING LAYER (30mm MIX)
	RED ASPHALT (SHARED PATH MIX)
	CONCRETE PATH (100mm THICK)
	BRICK PAVING - REFER CONSTRUCTION SPEC.
	JUTE MATTING (SOIL STABILISATION)

BRICK PAVING TABLE	
BRICK TYPE	LOCATIONS
BORAL 60mm INTERLOCKING ANTIQUE BLEND	INTERSECTIONS, CARPARKING BAYS, FLUSH KERBED MEDIANS, DRIVEWAYS AND ROUNDABOUT ISLANDS.
BORAL 60mm RECTANGULAR DONNYBROOK	SPLITTER ISLANDS, SEMI-MOUNTABLE ISLANDS AND NON-TRAFFICABLE VERGES



WARNING
SERVICES AND CADASTRAL BOUNDARY LOCATIONS SHOWN ARE ONLY INDICATIVE AND MUST NOT BE USED FOR EXCAVATION. THE "ONE CALL 1100" SYSTEM SHALL BE USED TO OBTAIN ACCURATE SERVICE LOCATIONS.

NOTES:

- CADASTRAL INFORMATION APPROXIMATE ONLY.
- DRAWING SHALL BE PRINTED IN COLOUR FOR PROPER VIEWING.
- ALL DRAWINGS SHALL BE READ IN CONJUNCTION WITH THE CONSTRUCTION SPECIFICATION.

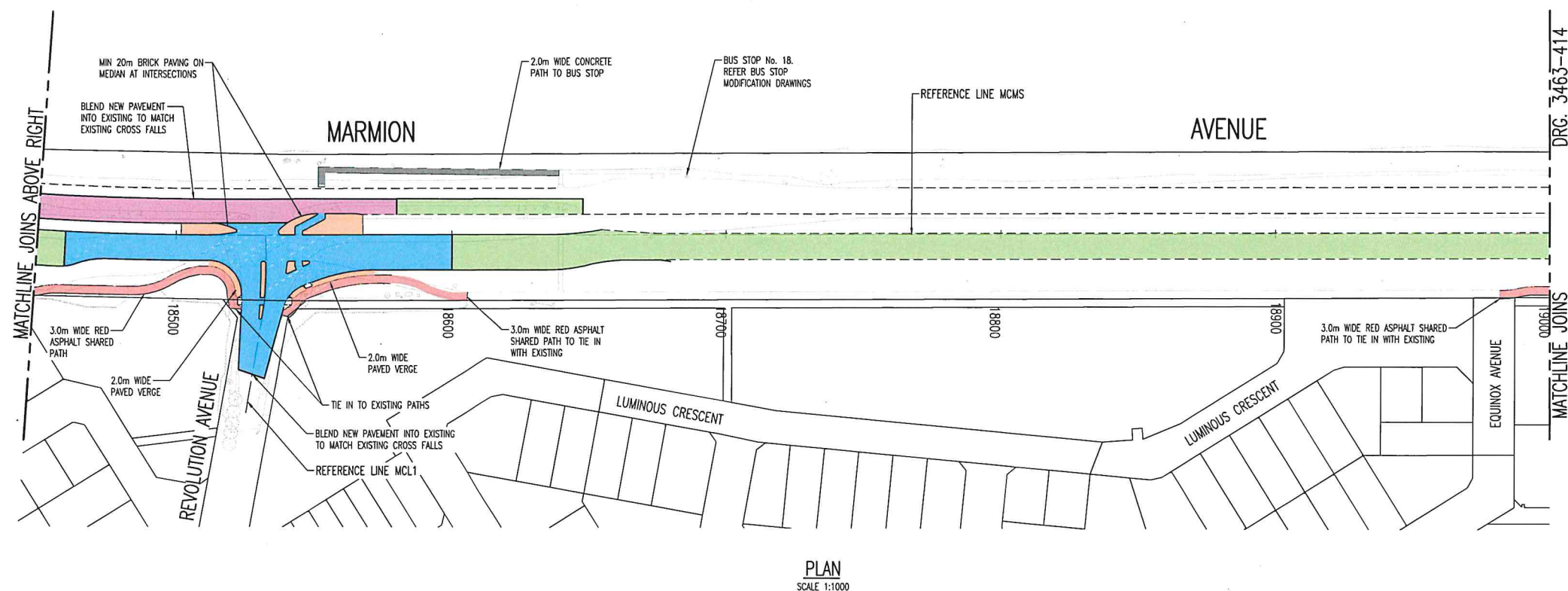

PRELIMINARY
DATE : 18 October 2018

REV	BY	DATE	AUTH	NO.	REVISION	BY	DATE	AUTH	NO.	SCALE	DATE	DESIGNED	CHECKED	RECOMMENDED	FINANCE CODE	PWD NO.	DRWING NO.	SHEET	REVISION	ORIGINAL DRG. SIZE
A	ISSUED FOR BEST DESIGN REVIEW	30/07/18	STT							1:1000	06/03/2018	GHD SURVEYOR	GHD CONSULTANT: CHD	PROJECT MANAGER: MAJOR WORKS	PR-4140	-				
B	ISSUED FOR TENDER	26/10/18	STT							AHD 71	11/06/2018	GHD CIVIL DESIGNER	MANAGER INFRASTRUCTURE PRODUCTS	DIRECTOR ASSETS		31839				

CITY OF WANNEROO ASSETS
MARMION AVENUE (002)
CAMBORNE PARKWAY (4772) TO YANCHEP BEACH ROAD (454)
ULTIMATE DUAL CARRIAGEWAY - STAGE 1
REFERENCE LINE MCMS

PAVEMENT PLAN
SHEET 4 OF 8

3463-413-B **A1**

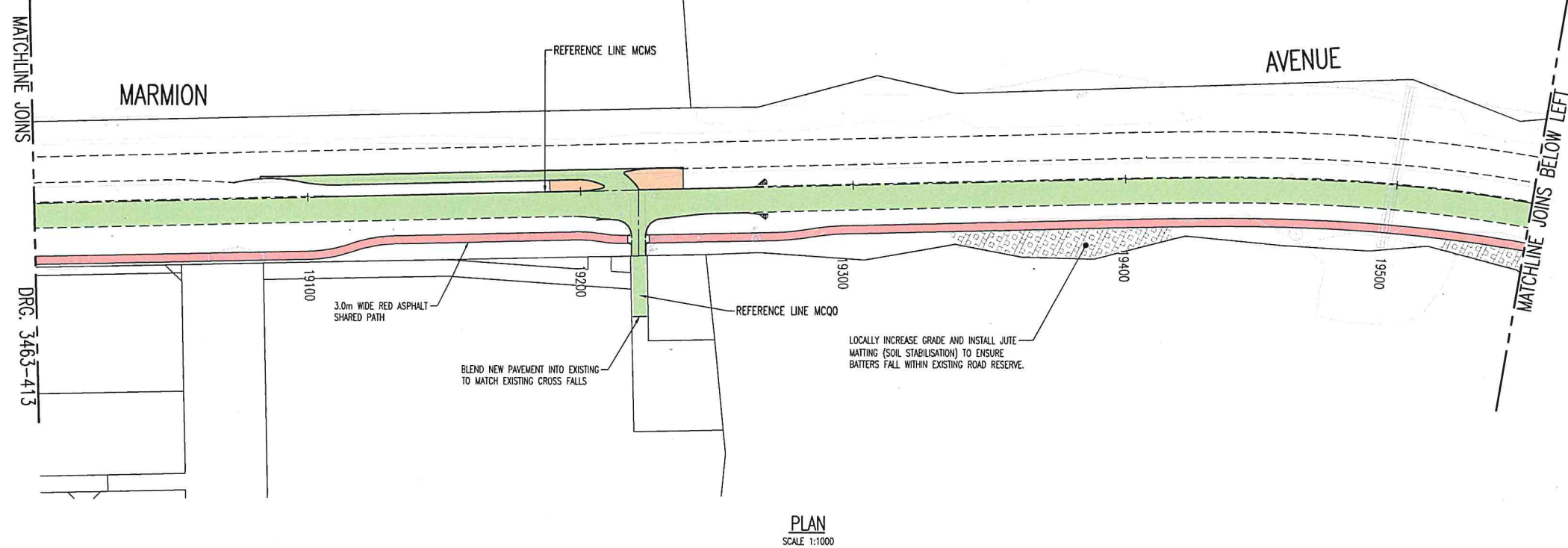
**LEGEND:**

	KERBING
	PAVEMENT EDGE
	NEW ROAD PAVEMENT (40mm INTERSECTION MIX)
	NEW ROAD PAVEMENT (30mm MIX)
	ASPHALT RESURFACING WITH CORRECTING LAYER (30mm MIX)
	RED ASPHALT (SHARED PATH MIX)
	CONCRETE PATH (100mm THICK)
	BRICK PAVING - REFER CONSTRUCTION SPEC.
	JUTE MATTING (SOIL STABILISATION)

BRICK PAVING TABLE	
BRICK TYPE	LOCATIONS
BORAL 80mm INTERLOCKING ANTIQUE BLEND	INTERSECTIONS, CARPARKING BAYS, FLUSH KERBED MEDIANS, DRIVEWAYS AND ROUNDABOUT ISLANDS.
BORAL 60mm RECTANGULAR DONNYBROOK	SPLITTER ISLANDS, SEMI-MOUNTABLE ISLANDS AND NON-TRAFFICABLE VERGES



WARNING
SERVICES AND CADASTRAL BOUNDARY LOCATIONS SHOWN ARE ONLY INDICATIVE AND MUST NOT BE USED FOR EXCAVATION. THE "ONE CALL 1100" SYSTEM SHALL BE USED TO OBTAIN ACCURATE SERVICE LOCATIONS.

NOTES:

- CADASTRAL INFORMATION APPROXIMATE ONLY.
- DRAWING SHALL BE PRINTED IN COLOUR FOR PROPER VIEWING.
- ALL DRAWINGS SHALL BE READ IN CONJUNCTION WITH THE CONSTRUCTION SPECIFICATION.

DESIGNED: V. SINAGRA / S. GILLESPIE CONSULTANT: (GHD)	CHECKED: CONSULTANT: (GHD)
DRAWN: J. SCHMECHTIG CONSULTANT: (GHD)	APPROVED: CONSULTANT: (GHD)



Level 10, 999 Hay Street Perth WA 6000
PO Box Y3106 Perth WA 6832 Australia
T 61 8 6222 8222 F 61 8 6222 8555
E permail@ghd.com.au W www.ghd.com



CITY OF WANNEROO
ASSETS

MARMION AVENUE (002)
CAMBORNE PARKWAY (4772) TO YANCHEP BEACH ROAD (454)
ULTIMATE DUAL CARRIAGEWAY - STAGE 1
REFERENCE LINE MCMS

PAVEMENT PLAN
SHEET 5 OF 8

DRAWING No. SHEET REVISION ORIGINAL DRG. SIZE
3463-414-B **A1**

PRELIMINARY
DATE : 18 October 2018

REVISION					REVISION					REVISION				
No.	BY	DATE	AUTH	No.	No.	BY	DATE	AUTH	No.	No.	BY	DATE	AUTH	No.
A	ISSUED FOR ASH DESIGN REVIEW	30/07/18	STT											
B	ISSUED FOR TENDER	16/10/18	STT											

SCALE: 1:1000
SCALE IN METRES
0 10 20 30 40 50

SURVEYED:
GHD
SURVEYOR
06/03/2018
DESIGNED:
GHD
CIVIL DESIGNER
11/06/2018

CHECKED:
CONSULTANT: GHD
ENDORSED:
MANAGER INFRASTRUCTURE PROJECTS
11/06/2018







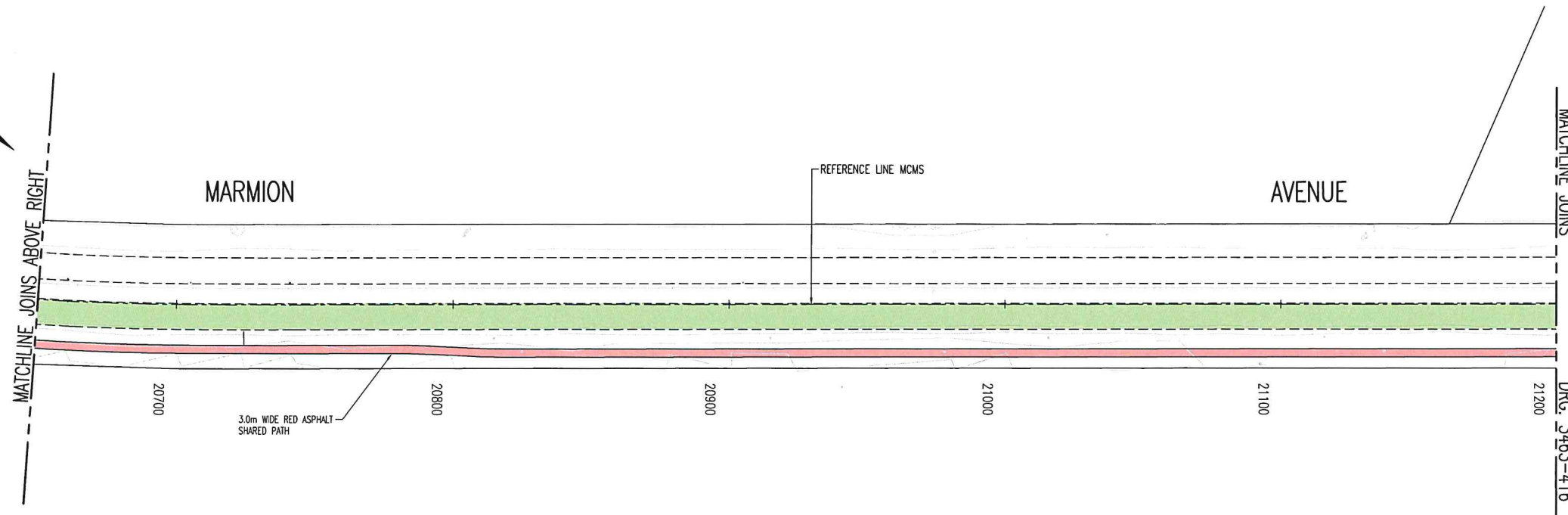
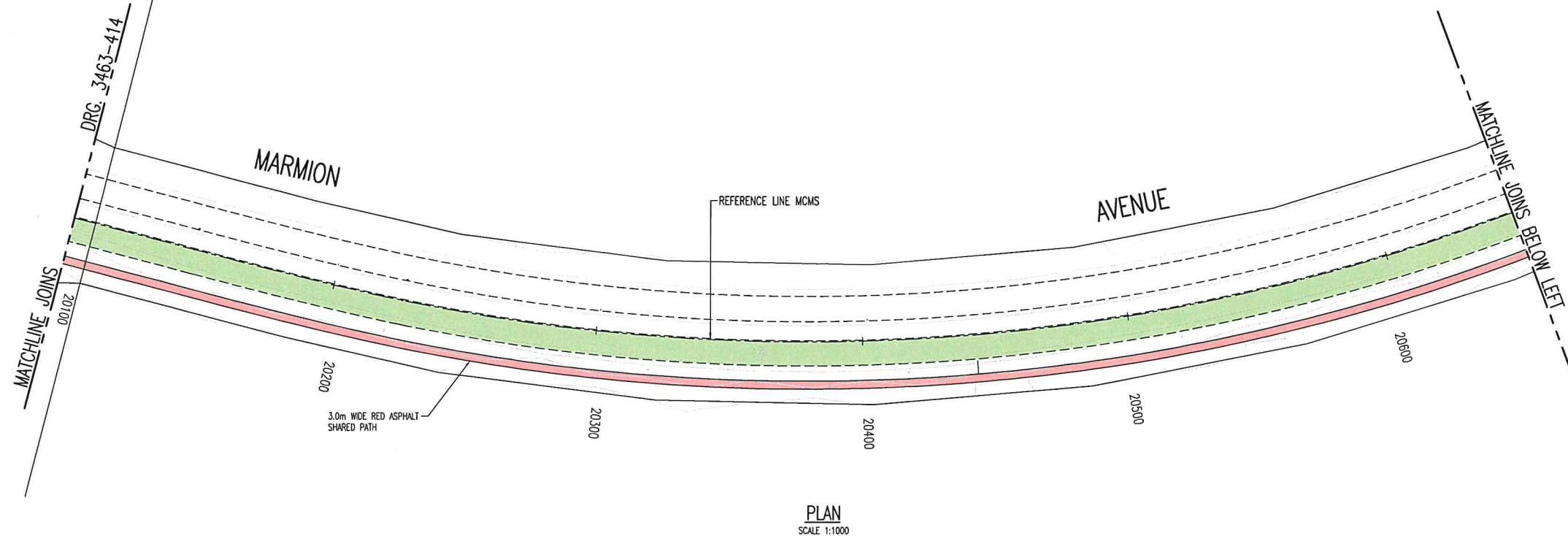

RECOMMENDED:
PROJECT MANAGER MAJOR WORKS
APPROVED:
DIRECTOR ASSETS

FINANCE CODE
PR-4140
DRAWING SET REF
-

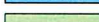
PWD No.
-
PWO CONTAINER No.
31839



LEGEND:

- | | |
|---|--|
|  | KERBING |
|  | PAVEMENT EDGE |
|  | NEW ROAD PAVEMENT (40mm INTERSECTION MIX) |
|  | NEW ROAD PAVEMENT (30mm MIX) |
|  | ASPHALT RESURFACING WITH CORRECTING LAYER (30mm MIX) |
|  | RED ASPHALT (SHARED PATH MIX) |
|  | CONCRETE PATH (100mm THICK) |
|  | BRICK PAVING – REFER CONSTRUCTION SPEC. |
|  | JUTE MATTING (SOIL STABILISATION) |

BRICK PAVING TABLE

BRICK TYPE	LOCATIONS
BORAL 80mm INTERLOCKING ANTIQUE BLEND	INTERSECTIONS, CARPARKING BAYS, FLUSH KERBED MEDIANS, DRIVEWAYS AND ROUNDABOUT ISLANDS.
BORAL 60mm RECTANGULAR DONNYBROOK	SPLITTER ISLANDS, SEMI-MOUNTABLE ISLANDS AND NON-TRAFFICABLE VERGE



WARNING
SERVICES AND CADASTRAL BOUNDARY
LOCATIONS SHOWN ARE ONLY INDICATIVE AND
MUST NOT BE USED FOR EXCAVATION.
THE "ONE CALL 1100" SYSTEM SHALL BE USED
TO OBTAIN ACCURATE SERVICE LOCATIONS.

NOTES:

1. CADASTRAL INFORMATION APPROXIMATE ONLY.
2. DRAWING SHALL BE PRINTED IN COLOUR FOR PROPER VIEWING.
3. ALL DRAWINGS SHALL BE READ IN CONJUNCTION WITH THE CONSTRUCTION SPECIFICATION.

DESIGNED: <i>V. SINAGRA / S. GILLESPIE</i>	CHECKED:
CONSULTANT: (SND)	CONSULTANT: (SND)
DRAWN: <i>J. SCHMECHTIG</i>	APPROVED:
CONSULTANT: (SND)	CONSULTANT: (SND)



Level 10, 999 Hay Street Perth WA 6000
PO Box Y3106 Perth WA 6832 Australia
T 61 8 6222 8222 F 61 8 6222 8555
E permail@ghd.com.au W www.ghd.com



CITY OF WANNEROO

ASSETS

MARMION AVENUE (002)

CAMBORNE PARKWAY (4772) TO YANCHEP BEACH ROAD (454)
ULTIMATE DUAL CARRIAGEWAY - STAGE 1
REFERENCE LINE MCMS

PAVEMENT PLAN
SHEET 6 OF 8

DRAWING No.	SHEET	REVISION	ORIGINAL DRG. SIZE
3463-415-B			A1

PRELIMINARY
DATE : 18 October 2018

[illegible]

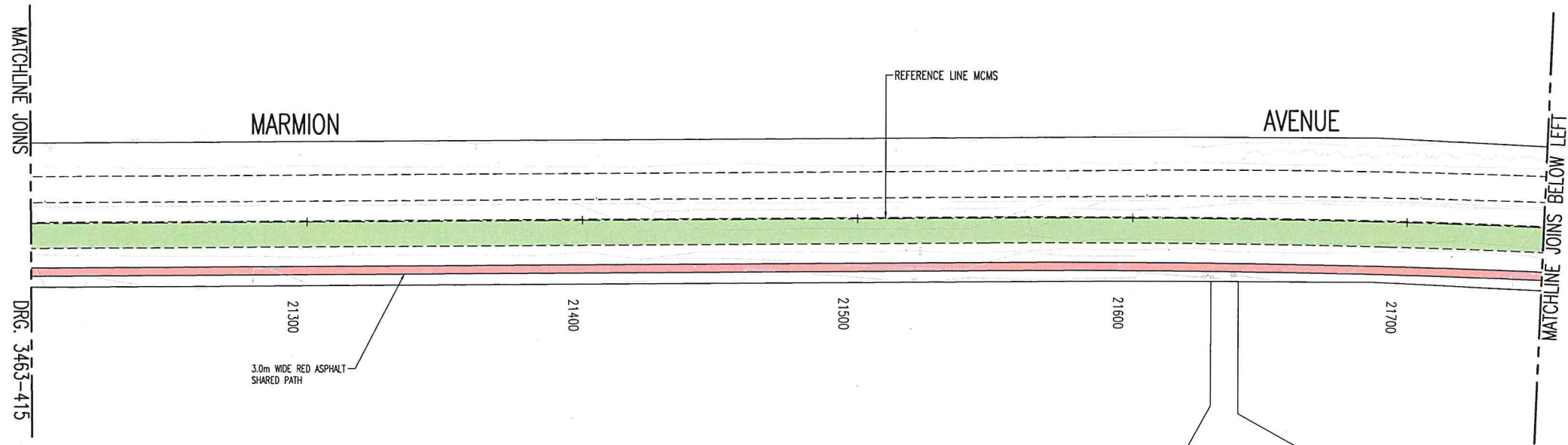

PLAN
SCALE 1:1000

LEGEND:

	KERBING
	PAVEMENT EDGE
	NEW ROAD PAVEMENT (40mm INTERSECTION MIX)
	NEW ROAD PAVEMENT (30mm MIX)
	ASPHALT RESURFACING WITH CORRECTING LAYER (30mm MIX)
	RED ASPHALT (SHARED PATH MIX)
	CONCRETE PATH (100mm THICK)
	BRICK PAVING - REFER CONSTRUCTION SPEC.
	JUTE MATTING (SOIL STABILISATION)

BRICK PAVING TABLE	
BRICK TYPE	LOCATIONS
BORAL 80mm INTERLOCKING ANTIQUE BLEND	INTERSECTIONS, CARPARKING BAYS, FLUSH KERBED MEDIANS, DRIVEWAYS AND ROUNDABOUT ISLANDS.
BORAL 60mm RECTANGULAR DONNYBROOK	SPLITTER ISLANDS, SEMI-MOUNTABLE ISLANDS AND NON-TRAFFICABLE VERGES



WARNING
SERVICES AND CADASTRAL BOUNDARY LOCATIONS SHOWN ARE ONLY INDICATIVE AND MUST NOT BE USED FOR EXCAVATION. THE "ONE CALL 1100" SYSTEM SHALL BE USED TO OBTAIN ACCURATE SERVICE LOCATIONS.

NOTES:

- CADASTRAL INFORMATION APPROXIMATE ONLY.
- DRAWING SHALL BE PRINTED IN COLOUR FOR PROPER VIEWING.
- ALL DRAWINGS SHALL BE READ IN CONJUNCTION WITH THE CONSTRUCTION SPECIFICATION.

DESIGNED: V. SINAGRA / S. GILLESPIE CONSULTANT (GHD)	CHECKED: CONSULTANT (GHD)
DRAWN: J. SCHMECHTIG CONSULTANT (GHD)	APPROVED: CONSULTANT (GHD)



Level 10, 999 Hay Street Perth WA 6000
PO Box Y3106 Perth WA 6832 Australia
T 61 8 6222 8222 F 61 8 6222 8555
E permail@ghd.com.au W www.ghd.com



CITY OF WANNEROO
ASSETS

MARMION AVENUE (002)
CAMBORNE PARKWAY (4772) TO YANCHEP BEACH ROAD (454)
ULTIMATE DUAL CARRIAGEWAY - STAGE 1
REFERENCE LINE MCMS

PAVEMENT PLAN
SHEET 7 OF 8

3463-416-B

A1

PRELIMINARY
DATE : 25 October 2018

REVISION				REVISION				REVISION			
No.	BY	DATE	AUTH.	No.	BY	DATE	AUTH.	No.	BY	DATE	AUTH.
A	ISSUED FOR BSE DESIGN REVIEW	30/07/16	STT								
B	ISSUED FOR TENDER	26/10/16	STT								

SCALE: 10 0 10 20 30 40 50
1:1000
SCALE IN METRES

SURVEYED:
GHD
SURVEYOR
DATE: 06/03/2018
DESIGNED:
GHD
CIVIL DESIGNER
11/06/2018

CHECKED:
CONSULTANT GHD
ENDORSED:
MANAGER INFRASTRUCTURE PROJECTS
11/06/2018

RECOMMENDED:
PROJECT MANAGER MAJOR WORKS
APPROVED:
DIRECTOR ASSETS

FINANCE CODE
PR-4140
DRAWING SET REF
-

PWD No.
-
PWO CONTAINER No.
31839

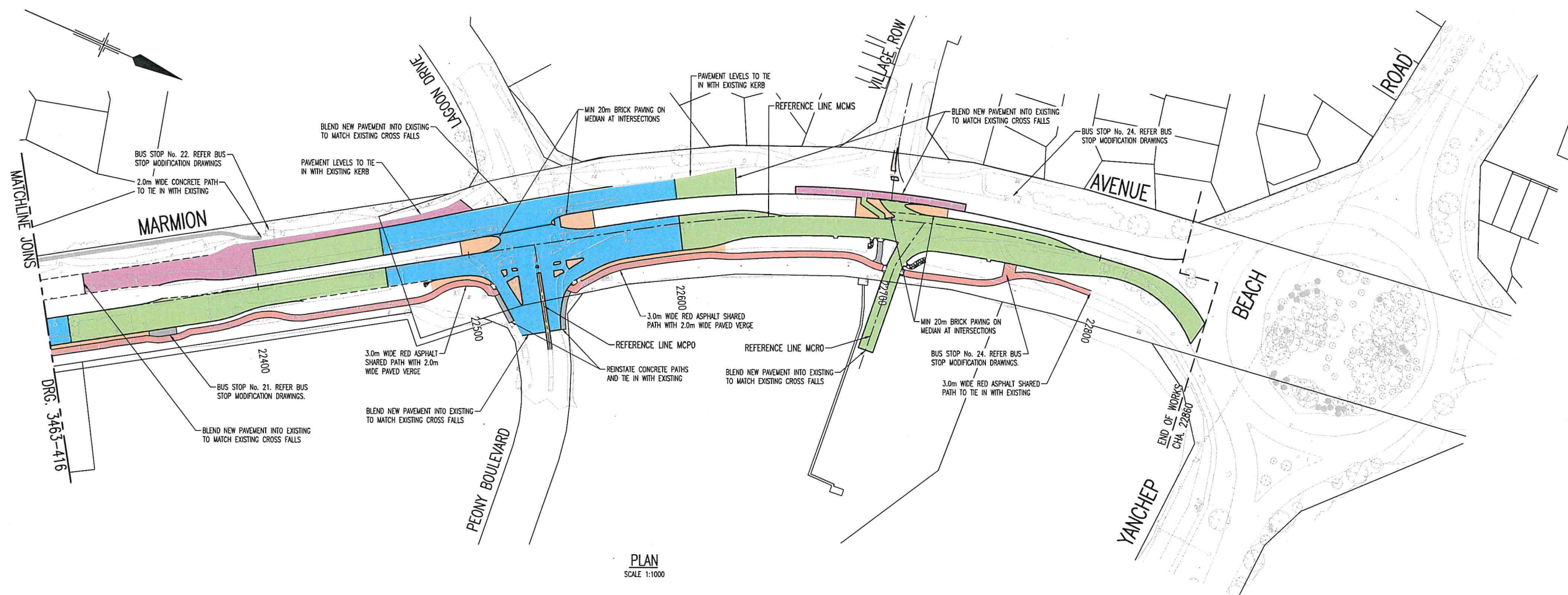

---	PAVEMENT EDGE
	NEW ROAD PAVEMENT (40mm INTERSECTION MIX)
	NEW ROAD PAVEMENT (30mm MIX)
	ASPHALT RESURFACING WITH CORRECTING LAYER (30mm MIX)
	RED ASPHALT (SHARED PATH MIX)
	CONCRETE PATH (100mm THICK)
	BRICK PAVING - REFER CONSTRUCTION SPEC.
	JUTE MATTING (SOIL STABILISATION)



WARNING
SERVICES AND CADASTRAL BOUNDARY LOCATIONS SHOWN ARE ONLY INDICATIVE AND MUST NOT BE USED FOR EXCAVATION. THE "ONE CALL 1100" SYSTEM SHALL BE USED TO OBTAIN ACCURATE SERVICE LOCATIONS.

NOTES:

- CADASTRAL INFORMATION APPROXIMATE ONLY.
- DRAWING SHALL BE PRINTED IN COLOUR FOR PROPER VIEWING.
- ALL DRAWINGS SHALL BE READ IN CONJUNCTION WITH THE CONSTRUCTION SPECIFICATION.

BRICK PAVING TABLE	
BRICK TYPE	LOCATIONS
BORAL 80mm INTERLOCKING ANTIQUE BLEND	INTERSECTIONS, CARPARKING BAYS, FLUSH KERBED MEDIANS, DRIVEWAYS AND ROUNDABOUT ISLANDS.
BORAL 60mm RECTANGULAR DONNYBROOK	SPLITTER ISLANDS, SEMI-MOUNTABLE ISLANDS AND NON-TRAFFICABLE VERGES

PRELIMINARY
DATE : 18 October 2018

DESIGNED: V. SINAGRA / S. GILLESPIE	CHECKED:
CONSULTANT: (GHD)	CONSULTANT: (GHD)
DRAWN: J. SCHMECHTIG	APPROVED:
CONSULTANT: (GHD)	CONSULTANT: (GHD)



Level 10, 999 Hay Street Perth WA 6000
PO Box Y3106 Perth WA 6832 Australia
T 61 8 6222 8222 F 61 8 6222 8555
E permail@ghd.com.au W www.ghd.com



CITY OF WANNEROO
ASSETS

MARMION AVENUE (002)
CAMBORNE PARKWAY (4772) TO YANCHEP BEACH ROAD (454)
ULTIMATE DUAL CARRIAGEWAY - STAGE 1
REFERENCE LINE MCMS

PAVEMENT PLAN
SHEET 8 OF 8

3463-417-B

A1