

- LEGEND**
- APPLICATION BOUNDARY
 - BOUNDARY - EXISTING LOT 9005
 - EXISTING CADASTRE
 - PROPOSED CADASTRE
 - INDICATIVE FUTURE LOT DESIGN
 - VEHICLE DIRECTION / PEDESTRIAN ACCESS
 - EXISTING CONTOURS
 - EXISTING 10M WIDE SEWER EASEMENT
 - EXISTING LOT NUMBERS
 - EXISTING LOT DIMENSIONS
 - PROPOSED LOT DIMENSIONS

PROPOSED LAND USE/DEVELOPMENT

Zone	Lot Size	No. of Lots
Residential	180m ² - 234m ²	7
Residential	235m ² - 319m ²	10
Residential	320m ² - 449m ²	11
Residential	450m ² - 529m ²	1
Other(balance)	Over 25HA	1
TOTAL		30

YIELD

Existing No. Lots	1
Proposed No. POS	2
Proposed No. Lots	29
Proposed No. Balance Lots	1
TOTAL	30

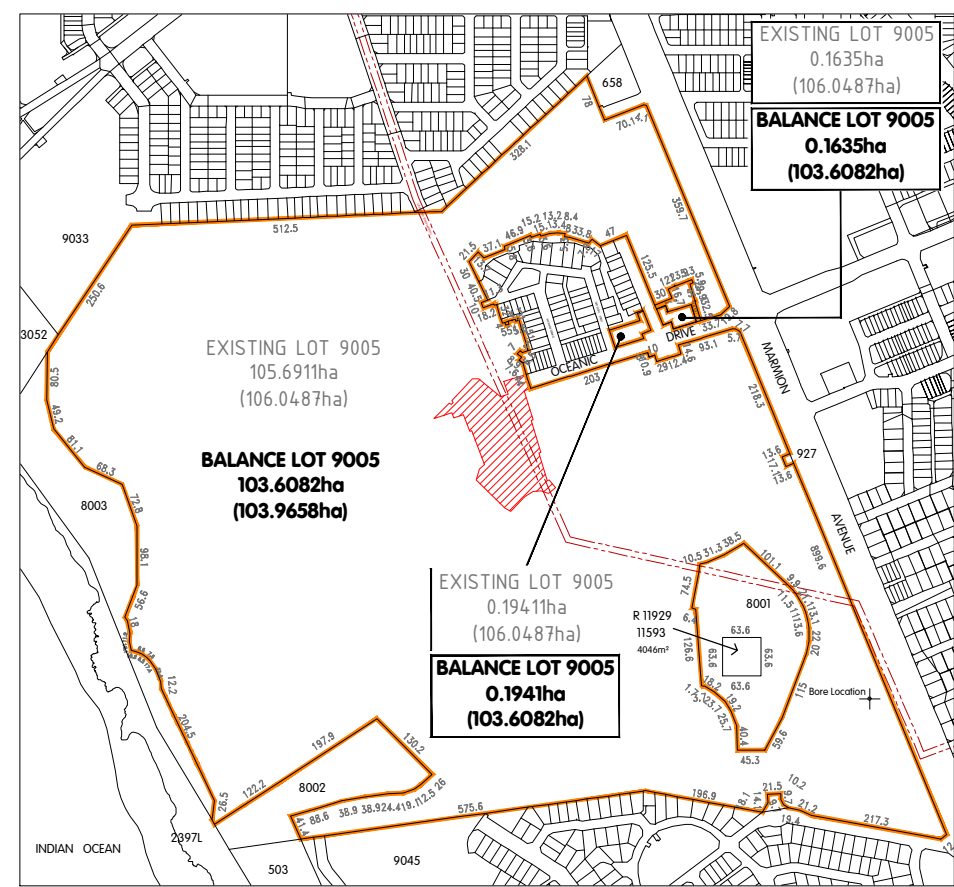

DEPARTMENT OF PLANNING, LANDS AND HERITAGE

DATE	FILE
11-Nov-2020	160134

CADASTRAL INFORMATION
 SOURCE: MNG
 YYMMDD: 200804
 DWG REF: 100475pr-034d
 PROJECTION: PCG94

AERIAL PHOTOGRAPHY
 SOURCE: NA
 YYMMDD: NA

RD
 great places

SIZE A3 1:1000

0 metres 10 20 30 40 50

REV	DESCRIPTION	YYMMDD	DRAWN	LI	LI
C	ADJUSTED FRONTAGES	201001	LI	LI	
B	REMOVE LANEWAY LOTS	201001	SB	LI	
A	BASE EDC JIN RD1 521E	200929	SB	LI/DRAFT	
REV	DESCRIPTION	YYMMDD	DRAWN	APPR'D	

SUBDIVISION PLAN - RELEASE 3
Lot 9005 Marmion Avenue
 City of Wanneroo

REF NO. **EDC JIN** DRAW NO. **RD1 160-1** REV. **C**



DISCLAIMER: ISSUED FOR DESIGN INTENT ONLY. ALL AREAS AND DIMENSIONS ARE SUBJECT TO DETAIL DESIGN AND SURVEY