

Release 5 - Dwelling + Lot Yield Schedule

Transects	Number of Lots	Number of Dwellings
T2	-	-
T3	-	-
T4	42	42
T5	-	-
TOTAL	42	42

- LEGEND**
- APPLICATION BOUNDARY
 - BOUNDARY - EXISTING LOT 9006
 - EXISTING CADASTRE
 - PROPOSED CADASTRE
 - INDICATIVE FUTURE LOT DESIGN
 - EXISTING 10M WIDE SEWER EASEMENT

- GENERAL REQUIREMENTS:**
- Minimum lot size for each lot as shown.
 - Pursuant to Clause 8.1 of the LSP, development of land shall be consistent with an approved Detailed Area Plan.
 - Minor variations to lot sizes may occur at deposited plan stage to accommodate detailed survey.

YIELD

Existing No. Lots	1
Proposed No. Lots	42
Proposed No. Balance Lots	1
TOTAL	43
Proposed No. POS	3
Proposed No. PAW	2

DEPARTMENT OF PLANNING, LANDS AND HERITAGE

DATE	FILE
20-Dec-2021	161472

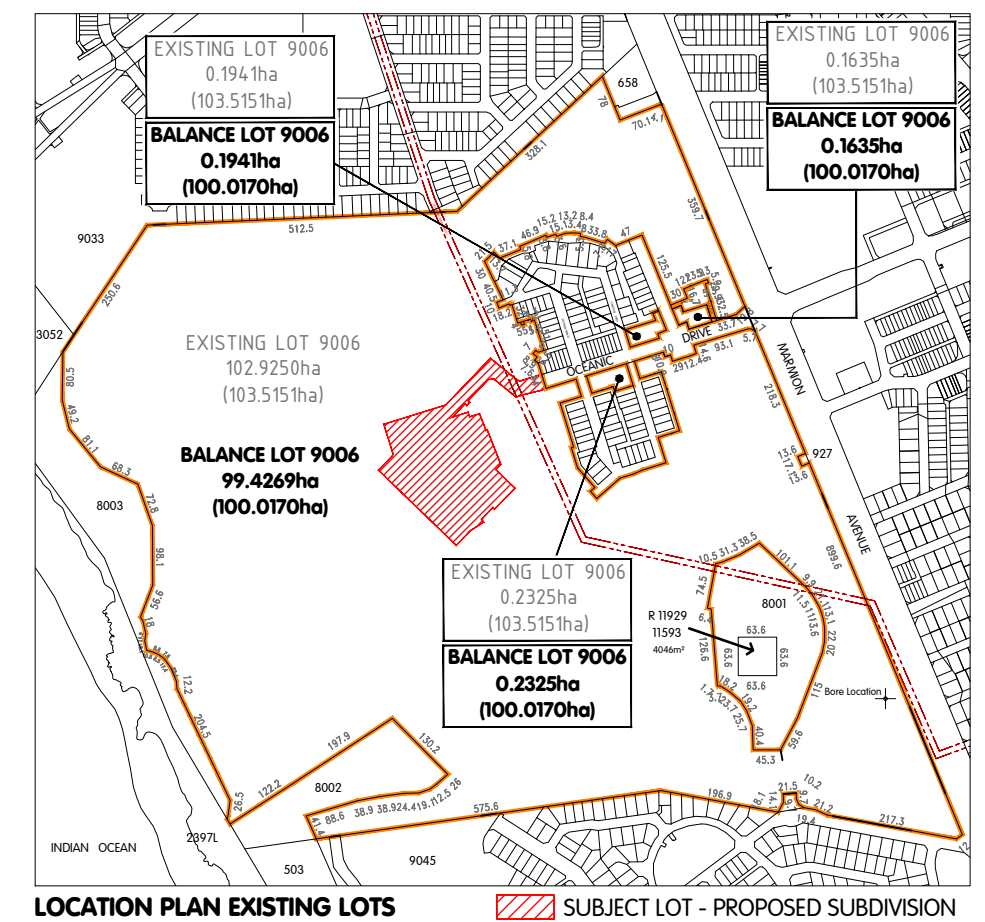

CADASTRAL INFORMATION
 SOURCE: MNG
 YYMMDD: 200804
 DWG REF: 100475pr-034d
 PROJECTION: PCG94

AERIAL PHOTOGRAPHY
 SOURCE: NA
 YYMMDD: NA

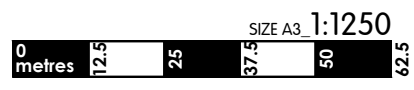

E	LANE INCREASED BY 0.5m	211130	SB	TP
D	ALL LOTS TO T4	211122	SB	TP
C	ADJUST POS/ROAD RES	210924	SB	CE
B	REDESIGN OF LOTS	210601	SB	DRAFT
A	BASE EDC JIN RD1 160C	210524	SB	DRAFT
REV	DESCRIPTION	YYMMDD	DRAWN	APPR'D

LOT MIX PLAN - RELEASE 5
Lot 9006 Marmion Avenue
 City of Wanneroo

REF NO. **EDC JIN** DRAW NO. **RD1 163-2** REV. **E**



DISCLAIMER: ISSUED FOR DESIGN INTENT ONLY. ALL AREAS AND DIMENSIONS ARE SUBJECT TO DETAIL DESIGN AND SURVEY