

**LEGEND**

- TOTAL APPLICATION AREA (122.5420ha)
- RESIDENTIAL R15

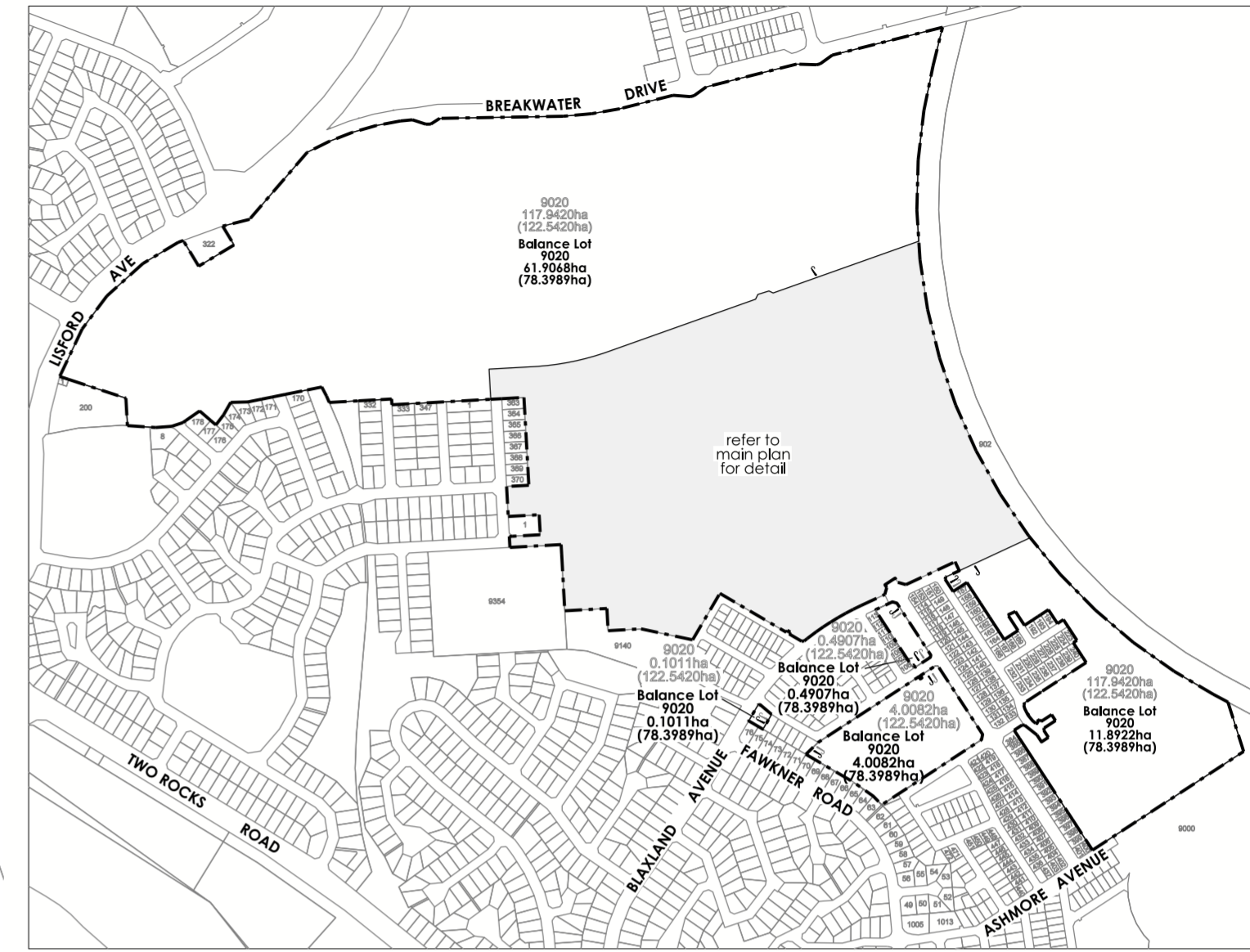

**OVERALL SUBDIVISION**



**DEPARTMENT OF PLANNING, LANDS AND HERITAGE**

---

DATE **05-Oct-2023** FILE **163845**

**Residential Density Coding Plan**  
 LOT 9020 LISFORD AVENUE, TWO ROCKS

A CAPRICORN VILLAGE JOINT VENTURE PROJECT

plan: 07/032/176  
 scale: 1:2,500@A2 | 1:1,250@A0  
 0 20 40 60m

date: 29/06/2023  
 grid: PCG 94  
 aerial: n/a

designed: ME  
 checked: ME  
 drawn: CR

Taylor Burrell Barnett Town Planning & Design  
 Level 7, 160 St Georges Terrace, Perth WA 6000  
 e: admin@tbbplanning.com.au  
 p: (08) 9226 4276



© COPYRIGHT TAYLOR BURRELL BARNETT. ALL RIGHTS RESERVED. ALL AREAS AND DIMENSIONS DISPLAYED ARE SUBJECT TO DETAIL SURVEY.