

DEPARTMENT OF PLANNING, LANDS AND HERITAGE
 DATE 11-Oct-2023 FILE 163865

- LEGEND**
- EXISTING SUBJECT LOT BOUNDARY
 - PROPOSED LOT BOUNDARY
 - EXISTING LOT BOUNDARIES
 - 14.3 EXISTING LOT NUMBERS
 - INDICATIVE FUTURE LOT BOUNDARIES

- DENSITY CODE**
- R25
 - R30

LOCATION PLAN - EXISTING LOT PROPOSED SUBDIVISION AREA (3.0454ha)

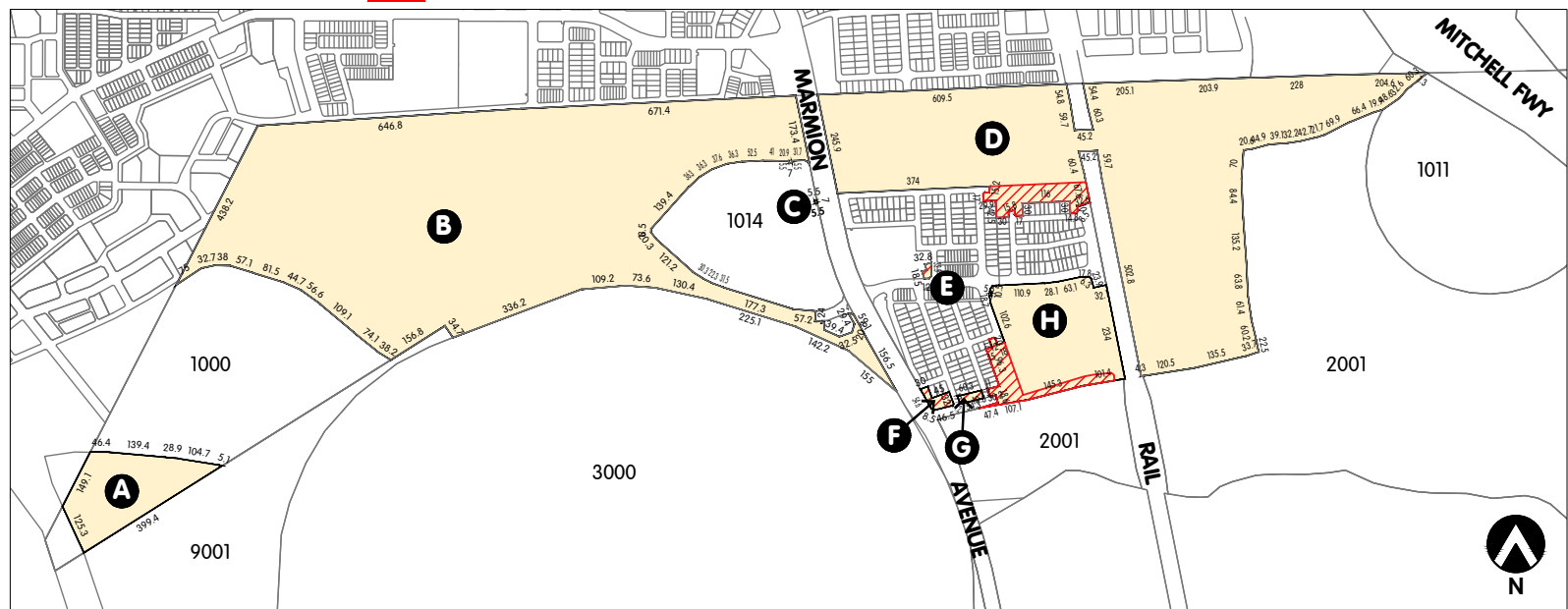

- EXISTING LOT 9010
- A** 4.8857ha (118.4508ha)
- B** 60.2416ha (118.4508ha)
- C** 0.0039ha (118.4508ha)
- D** 44.8554ha (118.4508ha)
- E** 0.0608ha (118.4508ha)
- F** 0.2314ha (118.4508ha)
- G** 0.1198ha (118.4508ha)
- H** 8.0522ha (118.4508ha)



CADASTRAL INFORMATION
 SOURCE: Veris, PTA
 YYMMDD: 230210, 230328
 DWG REF: 21709-003-R6.dwg
 PROJECTION: PCG94

HATCH | RobertsDay

SIZE A3 1:2500



REV	DESCRIPTION	DATE	DRAWN	APPR'D
C	CHANGE OF R-CODES	230921	TG	KB
B	REMOVE LOTS STH OF PICASSO PROM	230606	SB	KB
A	FIRST ISSUE	230509	TG	RDa
REV	DESCRIPTION	YYMMDD	DRAWN	APPR'D

DENSITY CODE PLAN
Lot 9011 Alkimos Drive, Alkimos
 City of Wanneroo

REF NO.	DRAW NO.	REV.
DLL CEN	RD1 172	C

DISCLAIMER: ISSUED FOR DESIGN INTENT ONLY. ALL AREAS AND DIMENSIONS ARE SUBJECT TO DETAIL DESIGN AND SURVEY