



LEGEND

- TOTAL APPLICATION AREA (122.5420ha)
- RESIDENTIAL R25
- RESIDENTIAL R30

DEPARTMENT OF PLANNING, LANDS AND HERITAGE

DATE **31-Oct-2023** FILE **163997**

OVERALL SUBDIVISION

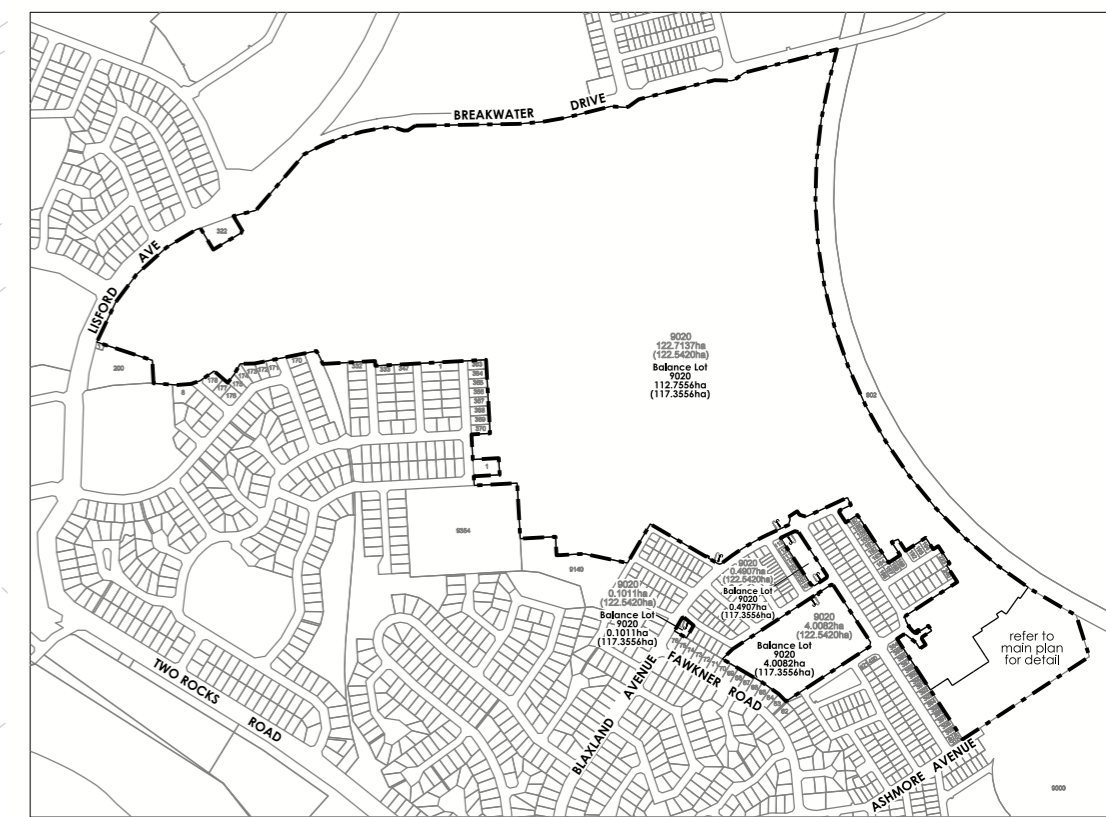

Residential Density Coding Plan
 LOT 9020 LISFORD AVENUE, TWO ROCKS

A CAPRICORN VILLAGE JOINT VENTURE PROJECT

plan: 07/032/177A date: 31/10/2023
 scale: 1:2000@A3 grid: PCG 94
 0 20 40m aerial:

designed: ME checked: ME drawn: JB
 Taylor Burrell Barnett Town Planning & Design
 Level 7, 160 St Georges Terrace, Perth WA 6000
 e: admin@tbbplanning.com.au p: (08) 9226 4276



© COPYRIGHT TAYLOR BURRELL BARNETT. ALL RIGHTS RESERVED. ALL AREAS AND DIMENSIONS DISPLAYED ARE SUBJECT TO DETAIL SURVEY.