





LEGEND

-  TOTAL APPLICATION AREA [58.2603ha]
-  RESIDENTIAL R25
-  RESIDENTIAL R30
-  RESIDENTIAL R40

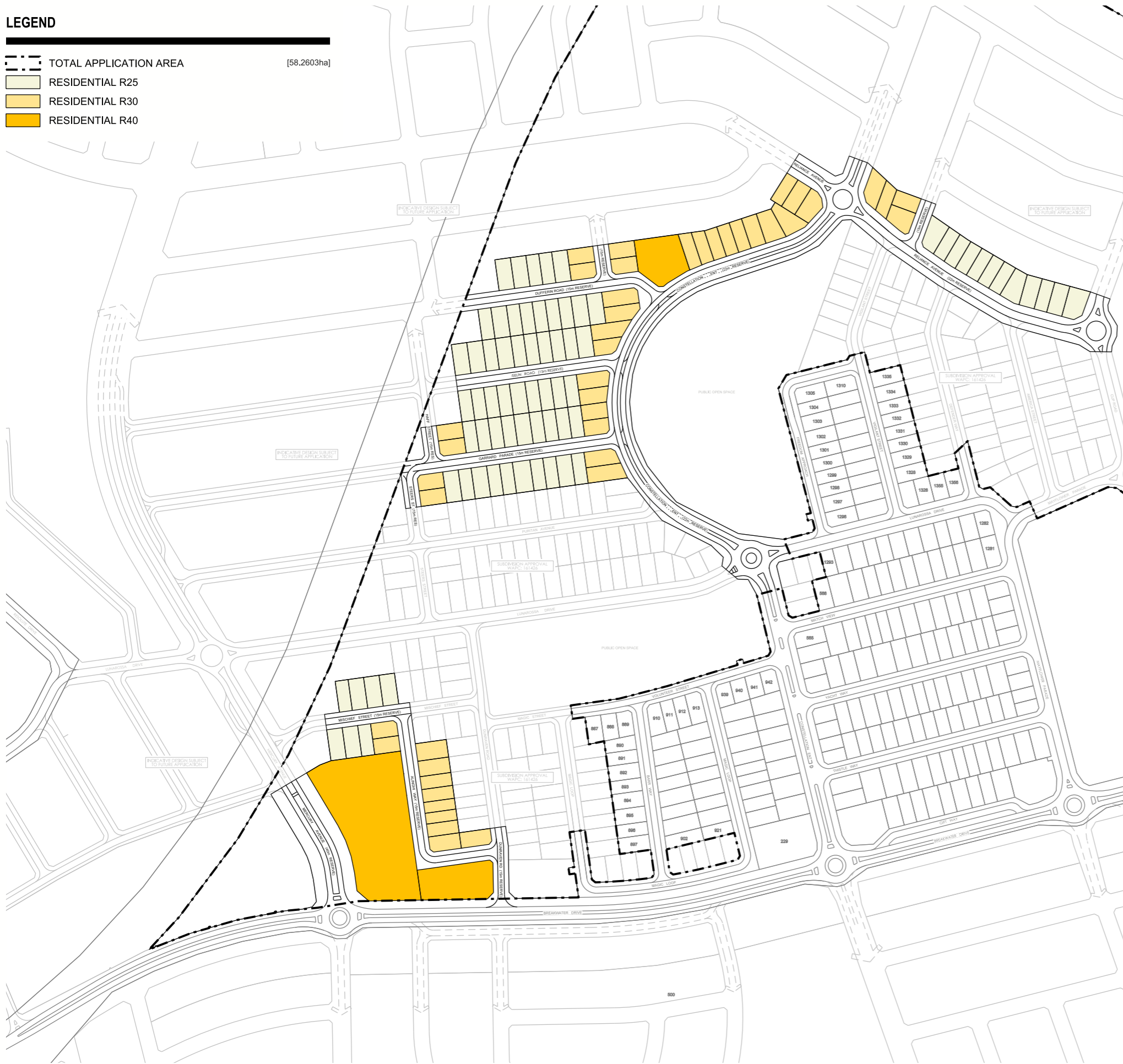

**DEPARTMENT OF PLANNING, LANDS
AND HERITAGE**

DATE **28-Nov-2023** FILE **164051**

OVERALL SUBDIVISION

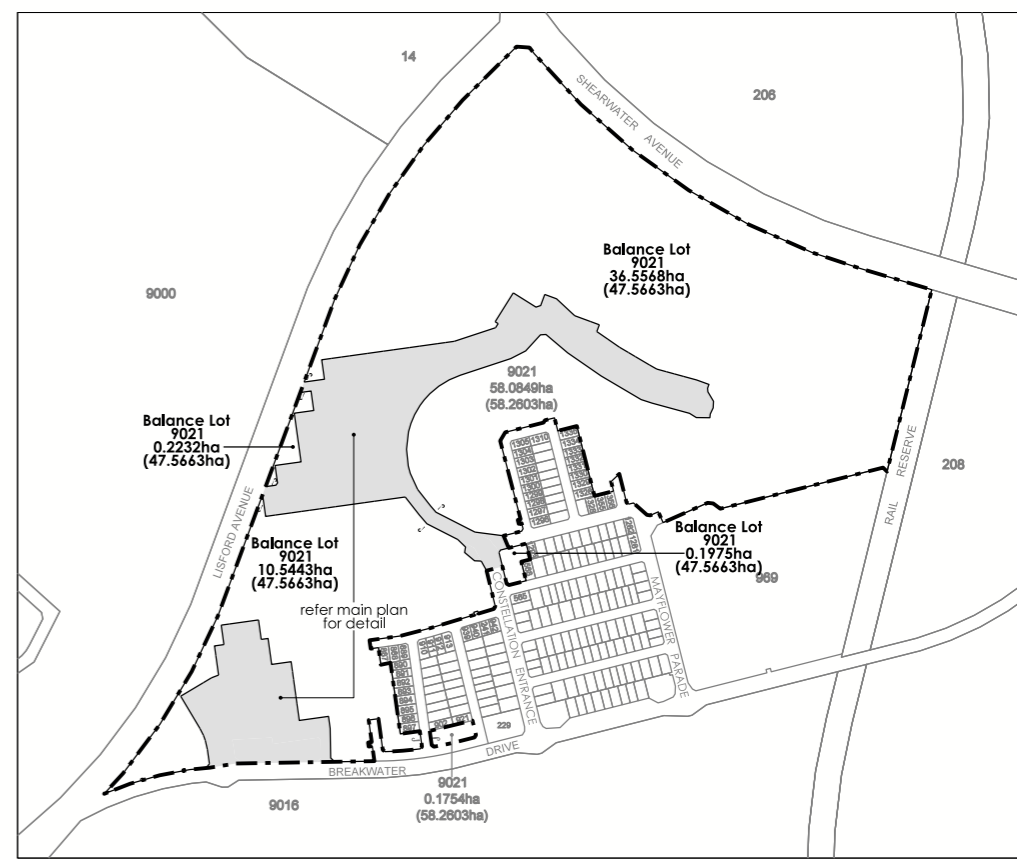

Residential Density Coding Plan
LOT 9021 BREAKWATER DRIVE, TWO ROCKS

A Capricorn Village Joint Venture Project

plan: 07/032/179A	date: 26/07/2023	designed: ME	Taylor Burrell Barnett Town Planning & Design Level 7, 160 St Georges Terrace, Perth WA 6000 e: admin@tbbplanning.com.au p: (08) 9226 4276
scale: 1:4000@A3 1:2000@A1	grid: PCG 94	checked: ME	
0 40 80m	aerial:	drawn: JB	



© COPYRIGHT TAYLOR BURRELL BARNETT. ALL RIGHTS RESERVED.
ALL AREAS AND DIMENSIONS DISPLAYED ARE SUBJECT TO DETAIL SURVEY.