

DEPARTMENT OF PLANNING  
 DATE: 3 AUG 2012  
 FILE: 146535

9028  
 34.728ha

**LEGEND**

- SUBJECT LAND
- APPLICATION AREA
- EXISTING LOT DETAIL
- PROPOSED LOT DETAIL
- INDICATIVE FUTURE CADASTRE
- R 40
- R 25

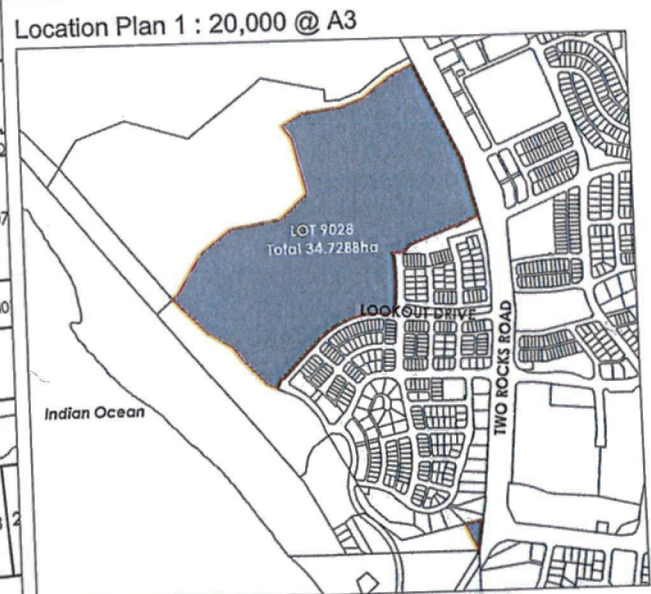

EXISTING No. LOTS - 1  
 PROPOSED No. LOTS - 118  
 PROPOSED No. BALANCE LOTS - 1

**robertsday**  
 perth | sydney | melbourne

Level 1 | 130 Royal Street East Perth  
 Western Australia 6004 AUSTRALIA  
 T: 08 9218 8700 | F: 08 9218 8701  
 www.robertsday.com.au

**CapricornVillage**  
 JOINT VENTURE

CADASTRAL INFORMATION:  
 Source: Cosill and Webley  
 YYMMDD: 111208  
 Reference: 5745-00-STAGES 1  
 5745 CAD  
 5745 CAD FUTURE  
 CAD94\_EXIST  
 Projection: PCG 94



B UPDATE BASE DESIGN  
 A BASE FROM RD1 018A  
 REV DESCRIPTION

120723 MS AC  
 120710 MS AC  
 YYMMDD DRAWN APPRD

CLIENT  
 CVJV

PROJECT  
 CAPRICORN VILLAGE

DISCLAIMER: ISSUED FOR DESIGN  
 INTENT ONLY. ALL AREAS AND  
 DIMENSIONS ARE SUBJECT TO  
 DETAIL DESIGN AND SURVEY.

**SUBDIVISION PLAN - STAGES 02C,03C & 04C**  
**Lot 9028 Two Rocks Road**  
**Capricorn Village, Yanchep**

0 metres 20 40 60 80 100  
 SCALE 1:2000 SHEET A3

REFERENCE NUMBER  
 TOK STR

DRAWING NUMBER  
 RD1 019

ISSUE  
 B

City of Wanneroo IM 14/12/2012